

# 1:2500 Scale Sections 2-1 to 2-4





**Site Details:**

South Tees Development

**Client Ref:** EMS\_546959\_736022  
**Report Ref:** EMS-546959\_736022\_LS\_2\_1  
**Grid Ref:** 457423, 523584

**Map Name:** County Series

**Map date:** 1893-1894

**Scale:** 1:2,500

**Printed at:** 1:2,500



Surveyed 1893  
 Revised 1893  
 Edition N/A  
 Copyright N/A  
 Levelled N/A

Surveyed 1894  
 Revised 1894  
 Edition N/A  
 Copyright N/A  
 Levelled N/A



Produced by  
 Groundsure Insights  
[www.groundsure.com](http://www.groundsure.com)



Supplied by:  
[www.emapsite.com](http://www.emapsite.com)  
[sales@emapsite.com](mailto:sales@emapsite.com)

© Crown copyright and database rights 2019 Ordnance Survey 100035207

Production date: 10 June 2019

Map legend available at:  
[www.groundsure.com/sites/default/files/groundsure\\_legend.pdf](http://www.groundsure.com/sites/default/files/groundsure_legend.pdf)

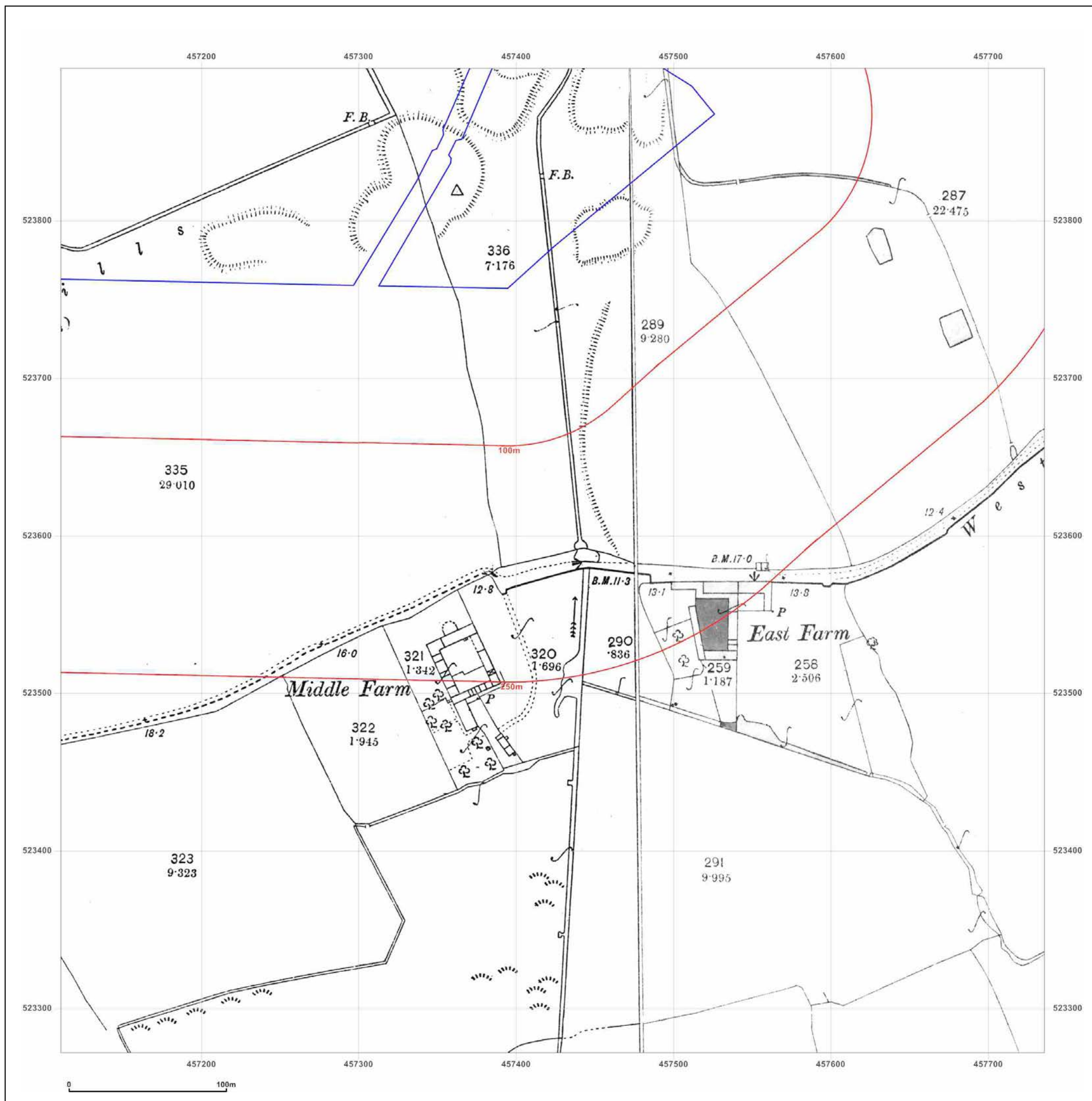

**Site Details:**

South Tees Development

**Client Ref:** EMS\_546959\_736022  
**Report Ref:** EMS-546959\_736022\_LS\_2\_1  
**Grid Ref:** 457423, 523584

**Map Name:** County Series

**Map date:** 1915

**Scale:** 1:2,500

**Printed at:** 1:2,500



Surveyed 1915  
 Revised 1915  
 Edition N/A  
 Copyright N/A  
 Levelled N/A

Surveyed 1915  
 Revised 1915  
 Edition N/A  
 Copyright N/A  
 Levelled N/A



Produced by  
 Groundsure Insights  
[www.groundsure.com](http://www.groundsure.com)



Supplied by:  
[www.emapsite.com](http://www.emapsite.com)  
[sales@emapsite.com](mailto:sales@emapsite.com)

© Crown copyright and database rights 2019 Ordnance Survey 100035207

Production date: 10 June 2019

Map legend available at:  
[www.groundsure.com/sites/default/files/groundsure\\_legend.pdf](http://www.groundsure.com/sites/default/files/groundsure_legend.pdf)

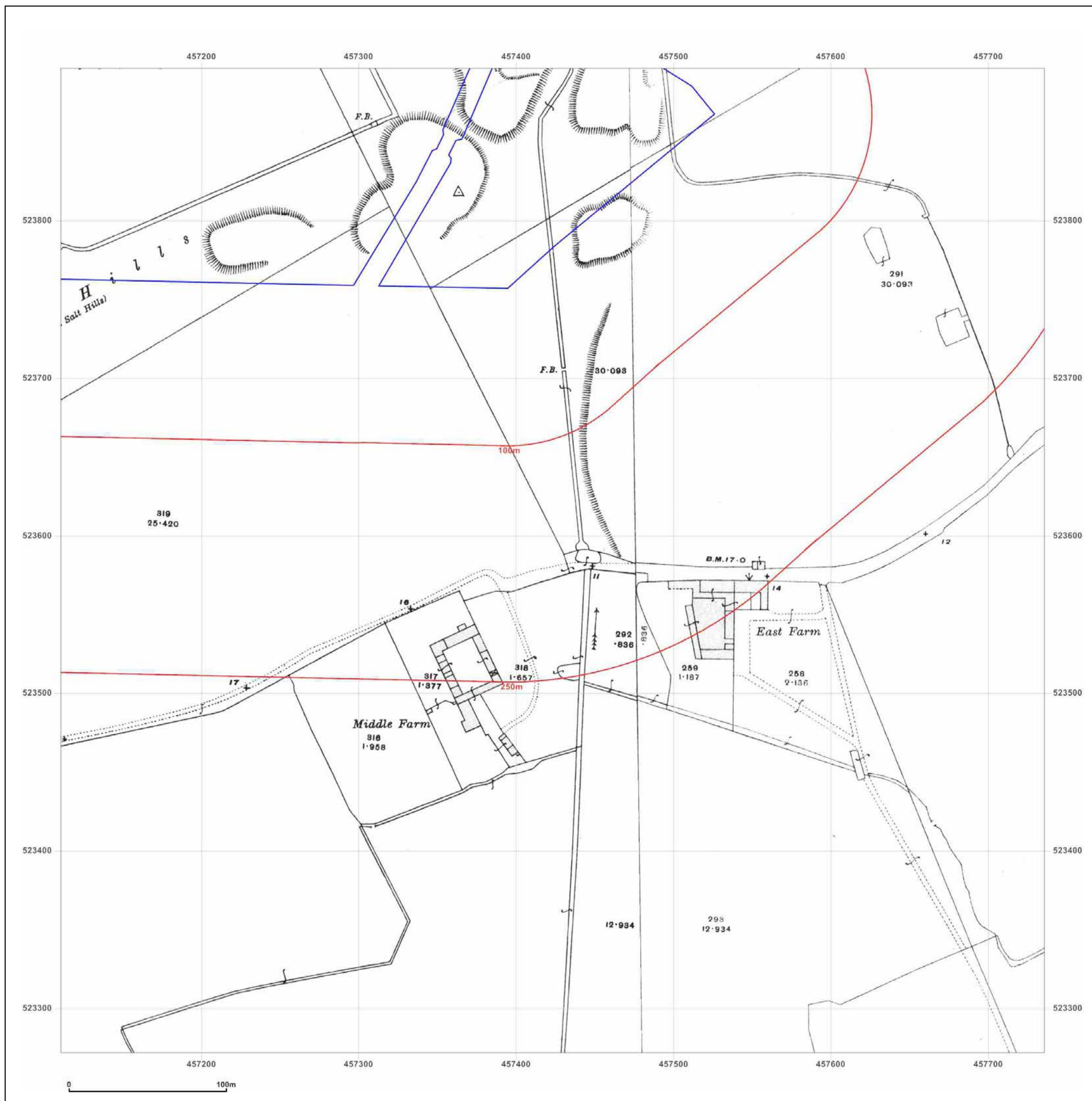



**Site Details:**

South Tees Development

**Client Ref:** EMS\_546959\_736022  
**Report Ref:** EMS-546959\_736022\_LS\_2\_1  
**Grid Ref:** 457423, 523584

**Map Name:** County Series

**Map date:** 1927-1929

**Scale:** 1:2,500

**Printed at:** 1:2,500



Surveyed 1927 Revised 1927 Edition N/A Copyright N/A Levelled N/A	Surveyed 1929 Revised 1929 Edition N/A Copyright N/A Levelled N/A
---	---

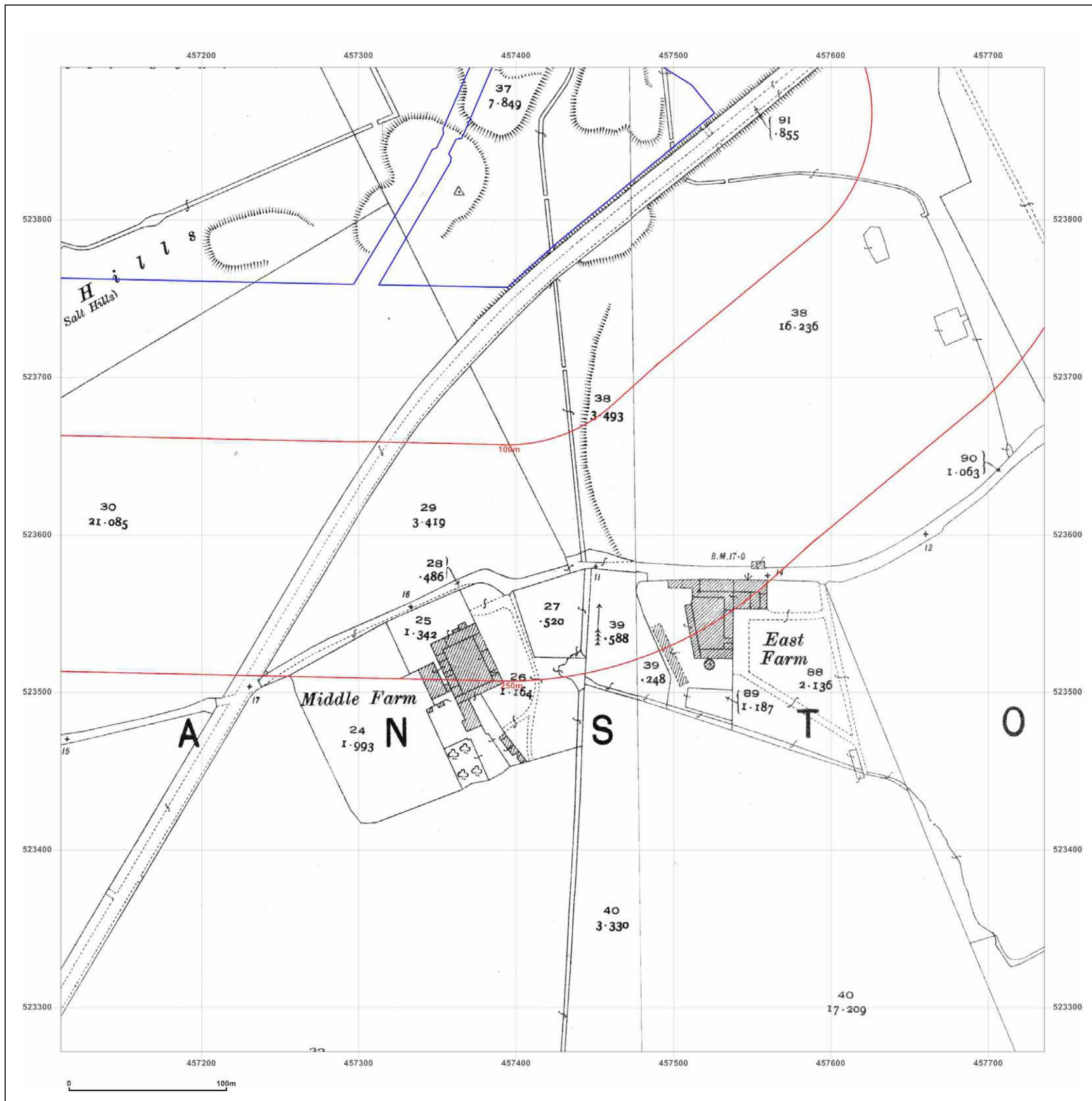

Produced by  
 Groundsure Insights  
[www.groundsure.com](http://www.groundsure.com)



Supplied by:  
[www.emapsite.com](http://www.emapsite.com)  
[sales@emapsite.com](mailto:sales@emapsite.com)

© Crown copyright and database rights 2019 Ordnance Survey 100035207

Production date: 10 June 2019

Map legend available at:  
[www.groundsure.com/sites/default/files/groundsure\\_legend.pdf](http://www.groundsure.com/sites/default/files/groundsure_legend.pdf)



**Site Details:**

South Tees Development

**Client Ref:** EMS\_546959\_736022  
**Report Ref:** EMS-546959\_736022\_LS\_2\_1  
**Grid Ref:** 457423, 523584

**Map Name:** National Grid

**Map date:** 1954

**Scale:** 1:2,500

**Printed at:** 1:2,500



Surveyed 1953  
 Revised 1953  
 Edition 1954  
 Copyright N/A  
 Levelled 1948



Produced by  
 Groundsure Insights  
[www.groundsure.com](http://www.groundsure.com)



Supplied by:  
[www.emapsite.com](http://www.emapsite.com)  
[sales@emapsite.com](mailto:sales@emapsite.com)

© Crown copyright and database rights 2019 Ordnance Survey 100035207

Production date: 10 June 2019

Map legend available at:  
[www.groundsure.com/sites/default/files/groundsure\\_legend.pdf](http://www.groundsure.com/sites/default/files/groundsure_legend.pdf)

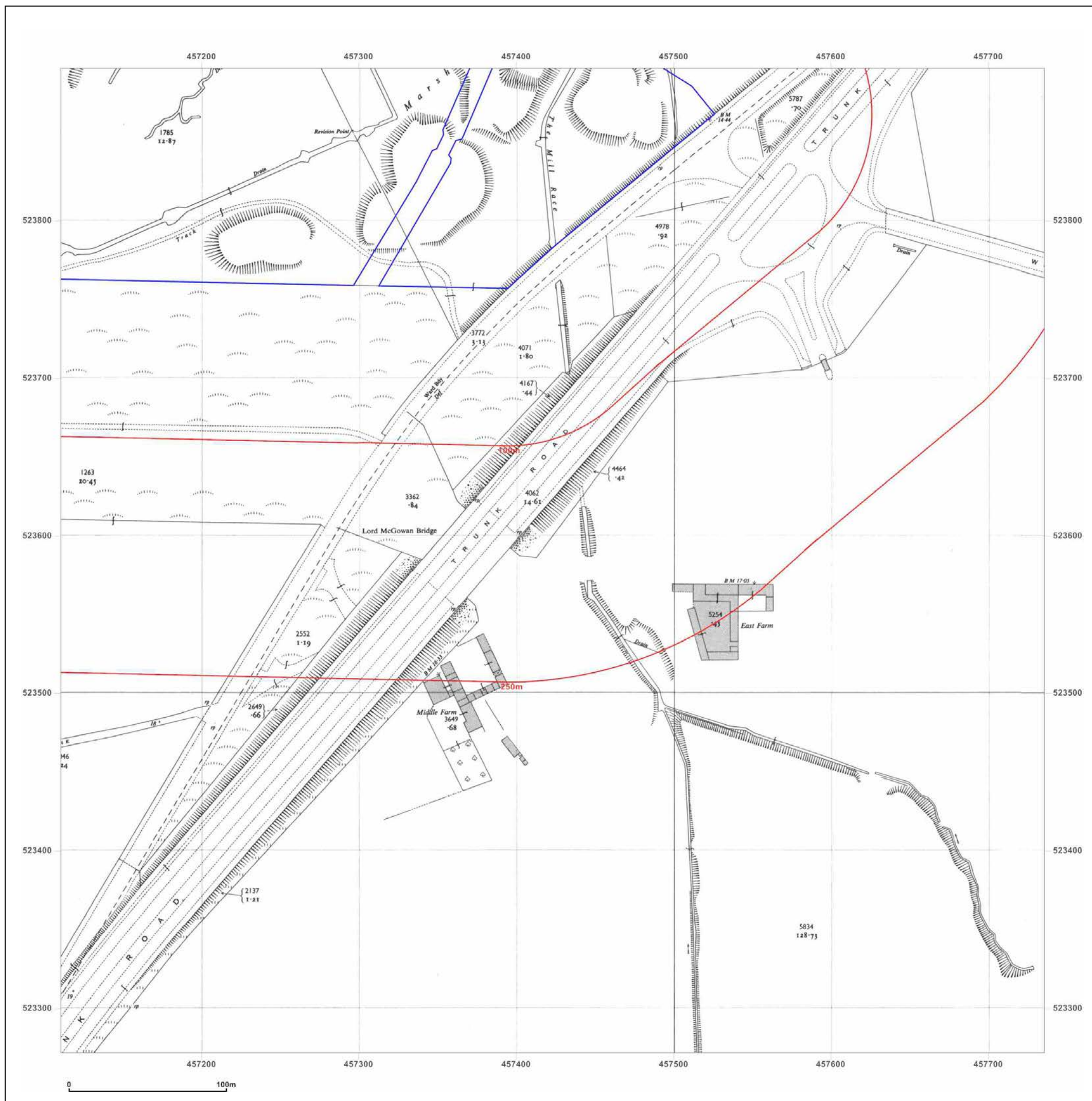



**Site Details:**

South Tees Development

**Client Ref:** EMS\_546959\_736022  
**Report Ref:** EMS-546959\_736022\_LS\_2\_1  
**Grid Ref:** 457423, 523584

**Map Name:** National Grid

**Map date:** 1964

**Scale:** 1:2,500

**Printed at:** 1:2,500



Surveyed 1962  
 Revised 1962  
 Edition 1964  
 Copyright 1964  
 Levelled 1959



Produced by  
 Groundsure Insights  
[www.groundsure.com](http://www.groundsure.com)



Supplied by:  
[www.emapsite.com](http://www.emapsite.com)  
[sales@emapsite.com](mailto:sales@emapsite.com)

© Crown copyright and database rights 2019 Ordnance Survey 100035207

Production date: 10 June 2019

Map legend available at:  
[www.groundsure.com/sites/default/files/groundsure\\_legend.pdf](http://www.groundsure.com/sites/default/files/groundsure_legend.pdf)

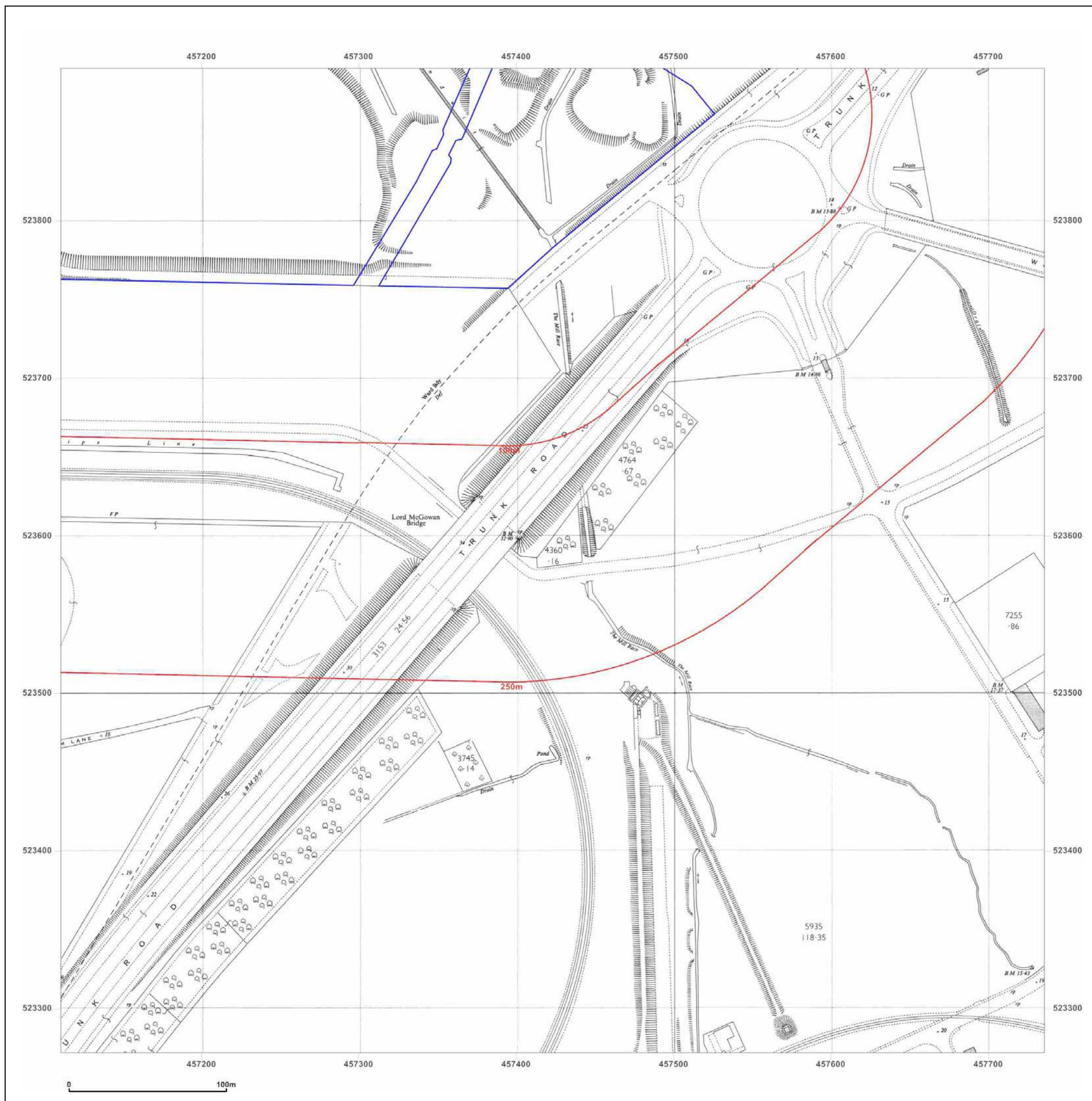



**Site Details:**

South Tees Development

**Client Ref:** EMS\_546959\_736022  
**Report Ref:** EMS-546959\_736022\_LS\_2\_2  
**Grid Ref:** 457423, 524209

**Map Name:** County Series

**Map date:** 1893-1894

**Scale:** 1:2,500

**Printed at:** 1:2,500



Surveyed 1894  
 Revised 1894  
 Edition N/A  
 Copyright N/A  
 Levelled N/A

Surveyed 1894  
 Revised 1894  
 Edition N/A  
 Copyright N/A  
 Levelled N/A

Surveyed 1893  
 Revised 1893  
 Edition N/A  
 Copyright N/A  
 Levelled N/A

Surveyed 1894  
 Revised 1894  
 Edition N/A  
 Copyright N/A  
 Levelled N/A



Produced by  
 Groundsure Insights  
[www.groundsure.com](http://www.groundsure.com)



Supplied by:  
[www.emapsite.com](http://www.emapsite.com)  
[sales@emapsite.com](mailto:sales@emapsite.com)

© Crown copyright and database rights 2019 Ordnance Survey 100035207

Production date: 10 June 2019

Map legend available at:  
[www.groundsure.com/sites/default/files/groundsure\\_legend.pdf](http://www.groundsure.com/sites/default/files/groundsure_legend.pdf)

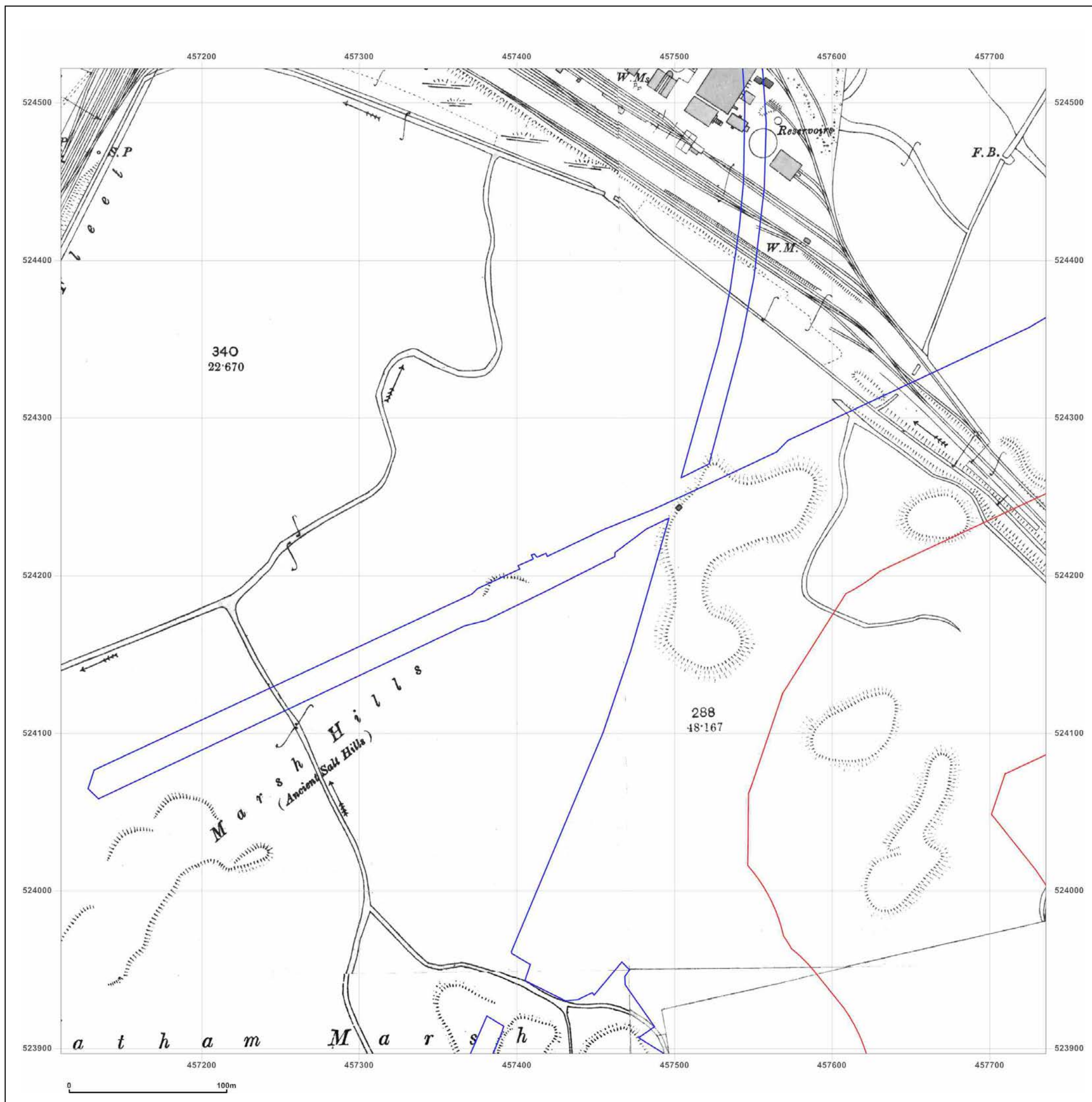



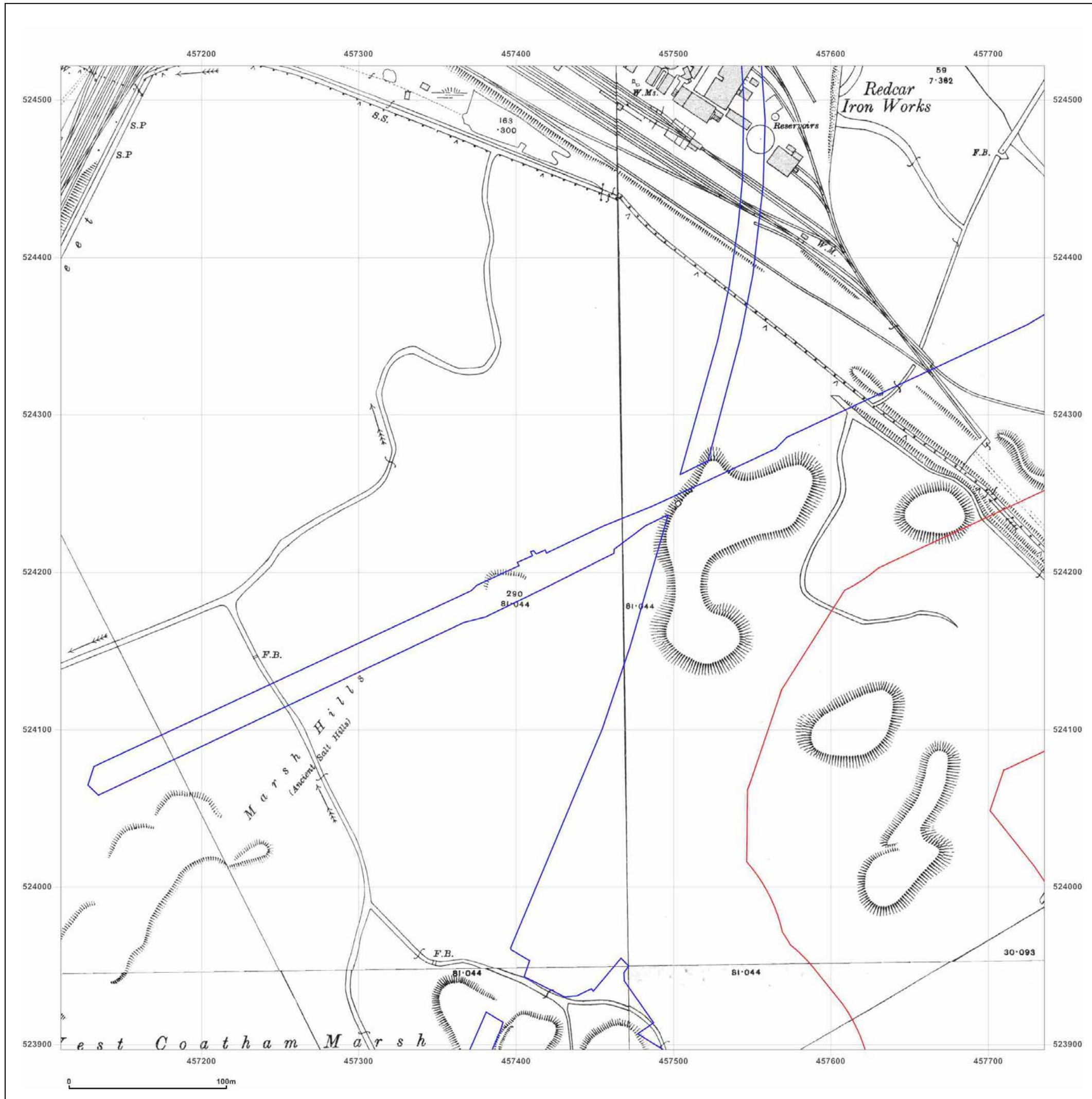

**Site Details:**

South Tees Development

**Client Ref:** EMS\_546959\_736022  
**Report Ref:** EMS-546959\_736022\_LS\_2\_2  
**Grid Ref:** 457423, 524209

**Map Name:** County Series

**Map date:** 1914-1915

**Scale:** 1:2,500

**Printed at:** 1:2,500



Surveyed 1915  
 Revised 1915  
 Edition N/A  
 Copyright N/A  
 Levelled N/A

Surveyed 1914  
 Revised 1914  
 Edition N/A  
 Copyright N/A  
 Levelled N/A

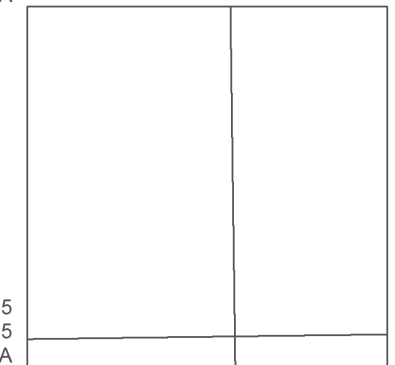

Surveyed 1915  
 Revised 1915  
 Edition N/A  
 Copyright N/A  
 Levelled N/A

Surveyed 1915  
 Revised 1915  
 Edition N/A  
 Copyright N/A  
 Levelled N/A



Produced by  
 Groundsure Insights  
[www.groundsure.com](http://www.groundsure.com)



Supplied by:  
[www.emapsite.com](http://www.emapsite.com)  
[sales@emapsite.com](mailto:sales@emapsite.com)

© Crown copyright and database rights 2019 Ordnance Survey 100035207

Production date: 10 June 2019

Map legend available at:  
[www.groundsure.com/sites/default/files/groundsure\\_legend.pdf](http://www.groundsure.com/sites/default/files/groundsure_legend.pdf)



**Site Details:**

South Tees Development

**Client Ref:** EMS\_546959\_736022  
**Report Ref:** EMS-546959\_736022\_LS\_2\_2  
**Grid Ref:** 457423, 524209

**Map Name:** County Series

**Map date:** 1927-1929

**Scale:** 1:2,500

**Printed at:** 1:2,500



Surveyed 1929  
 Revised 1929  
 Edition N/A  
 Copyright N/A  
 Levelled N/A

Surveyed 1929  
 Revised 1929  
 Edition N/A  
 Copyright N/A  
 Levelled N/A

Surveyed 1927  
 Revised 1927  
 Edition N/A  
 Copyright N/A  
 Levelled N/A

Surveyed 1929  
 Revised 1929  
 Edition N/A  
 Copyright N/A  
 Levelled N/A

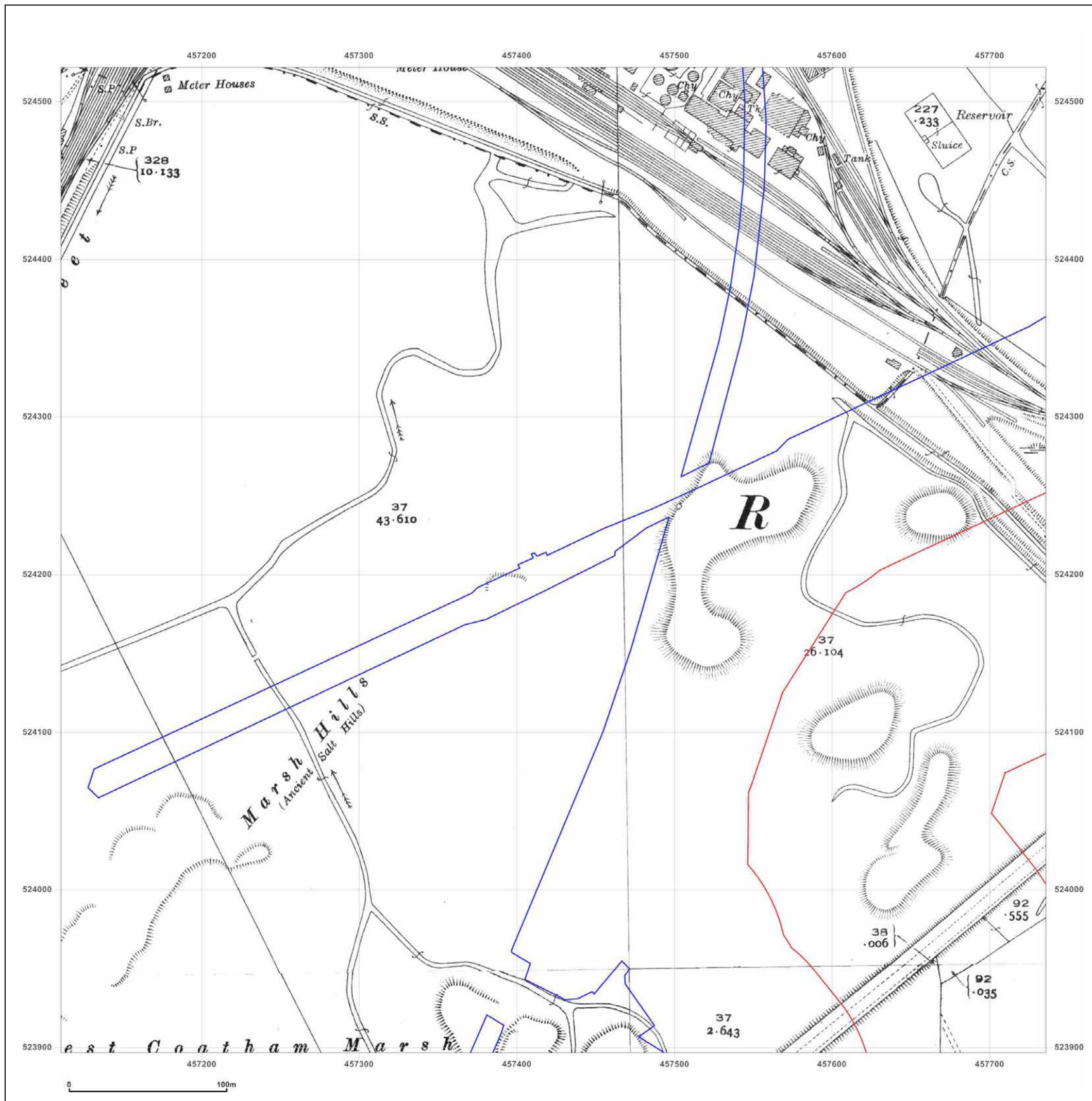
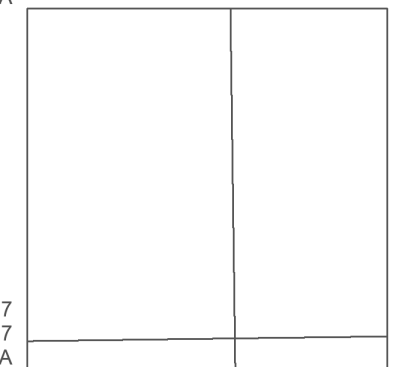

Produced by  
 Groundsure Insights  
[www.groundsure.com](http://www.groundsure.com)



Supplied by:  
[www.emapsite.com](http://www.emapsite.com)  
[sales@emapsite.com](mailto:sales@emapsite.com)

© Crown copyright and database rights 2019 Ordnance Survey 100035207

Production date: 10 June 2019

Map legend available at:  
[www.groundsure.com/sites/default/files/groundsure\\_legend.pdf](http://www.groundsure.com/sites/default/files/groundsure_legend.pdf)



**Site Details:**

South Tees Development

**Client Ref:** EMS\_546959\_736022  
**Report Ref:** EMS-546959\_736022\_LS\_2\_2  
**Grid Ref:** 457423, 524209

**Map Name:** National Grid

**Map date:** 1954

**Scale:** 1:2,500

**Printed at:** 1:2,500



Surveyed 1954  
 Revised 1954  
 Edition N/A  
 Copyright N/A  
 Levelled N/A

Surveyed 1953  
 Revised 1953  
 Edition 1954  
 Copyright N/A  
 Levelled 1948



Produced by  
 Groundsure Insights  
[www.groundsure.com](http://www.groundsure.com)



Supplied by:  
[www.emapsite.com](http://www.emapsite.com)  
[sales@emapsite.com](mailto:sales@emapsite.com)

© Crown copyright and database rights 2019 Ordnance Survey 100035207

Production date: 10 June 2019

Map legend available at:  
[www.groundsure.com/sites/default/files/groundsure\\_legend.pdf](http://www.groundsure.com/sites/default/files/groundsure_legend.pdf)

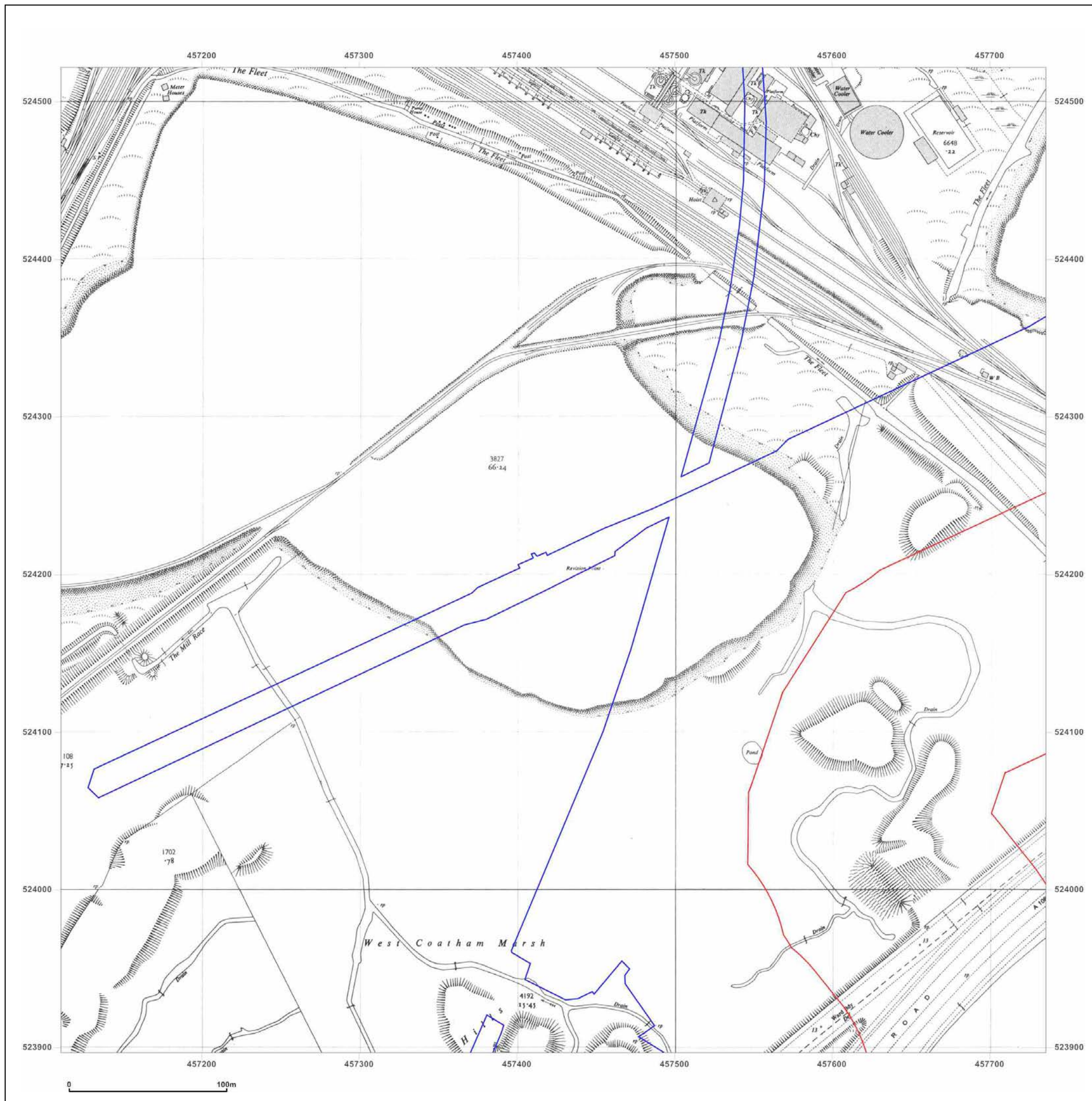



**Site Details:**

South Tees Development

**Client Ref:** EMS\_546959\_736022  
**Report Ref:** EMS-546959\_736022\_LS\_2\_3  
**Grid Ref:** 457423, 524835

**Map Name:** County Series

**Map date:** 1894

**Scale:** 1:2,500

**Printed at:** 1:2,500



Surveyed 1894  
 Revised 1894  
 Edition N/A  
 Copyright N/A  
 Levelled N/A

Surveyed 1894  
 Revised 1894  
 Edition N/A  
 Copyright N/A  
 Levelled N/A



Produced by  
 Groundsure Insights  
[www.groundsure.com](http://www.groundsure.com)



Supplied by:  
[www.emapsite.com](http://www.emapsite.com)  
[sales@emapsite.com](mailto:sales@emapsite.com)

© Crown copyright and database rights 2019 Ordnance Survey 100035207

Production date: 10 June 2019

Map legend available at:  
[www.groundsure.com/sites/default/files/groundsure\\_legend.pdf](http://www.groundsure.com/sites/default/files/groundsure_legend.pdf)

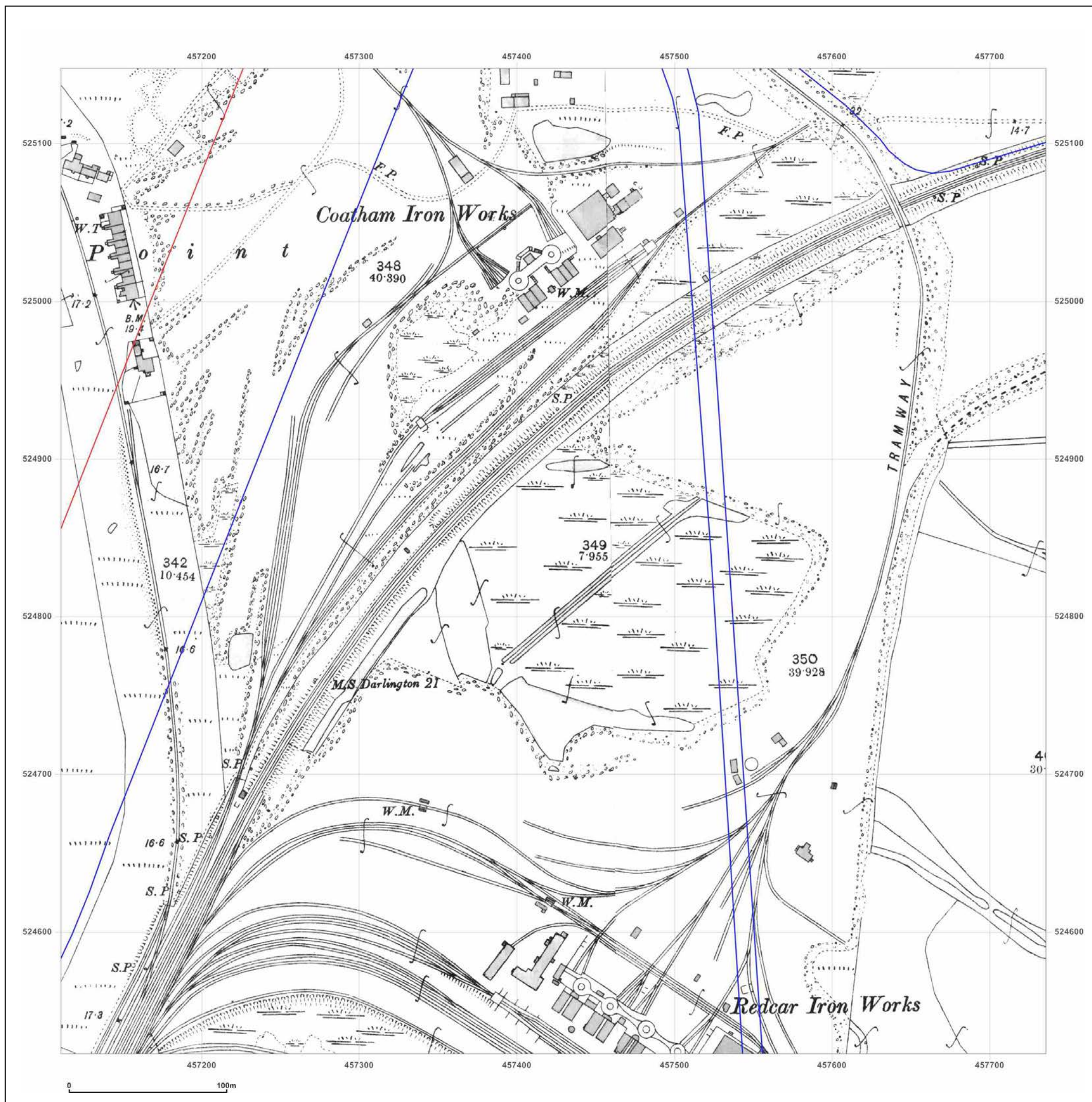



**Site Details:**

South Tees Development

**Client Ref:** EMS\_546959\_736022  
**Report Ref:** EMS-546959\_736022\_LS\_2\_3  
**Grid Ref:** 457423, 524835

**Map Name:** County Series

**Map date:** 1914-1915

**Scale:** 1:2,500

**Printed at:** 1:2,500



Surveyed 1915  
 Revised 1915  
 Edition N/A  
 Copyright N/A  
 Levelled N/A

Surveyed 1914  
 Revised 1914  
 Edition N/A  
 Copyright N/A  
 Levelled N/A



Produced by  
 Groundsure Insights  
[www.groundsure.com](http://www.groundsure.com)



Supplied by:  
[www.emapsite.com](http://www.emapsite.com)  
[sales@emapsite.com](mailto:sales@emapsite.com)

© Crown copyright and database rights 2019 Ordnance Survey 100035207

Production date: 10 June 2019

Map legend available at:  
[www.groundsure.com/sites/default/files/groundsure\\_legend.pdf](http://www.groundsure.com/sites/default/files/groundsure_legend.pdf)

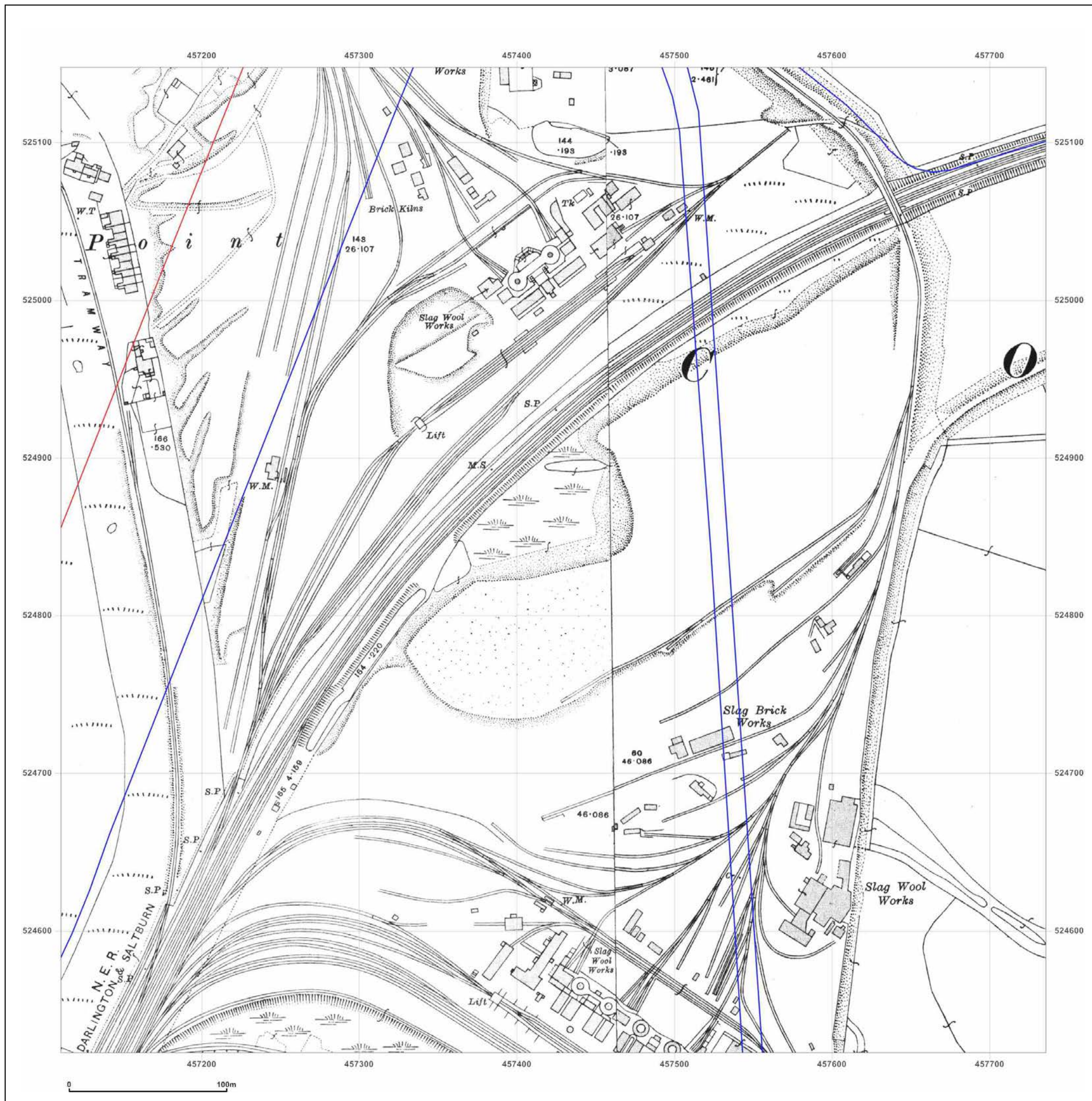



**Site Details:**

South Tees Development

**Client Ref:** EMS\_546959\_736022  
**Report Ref:** EMS-546959\_736022\_LS\_2\_3  
**Grid Ref:** 457423, 524835

**Map Name:** County Series

**Map date:** 1929

**Scale:** 1:2,500

**Printed at:** 1:2,500



Surveyed 1929  
 Revised 1929  
 Edition N/A  
 Copyright N/A  
 Levelled N/A

Surveyed 1929  
 Revised 1929  
 Edition N/A  
 Copyright N/A  
 Levelled N/A



Produced by  
 Groundsure Insights  
[www.groundsure.com](http://www.groundsure.com)



Supplied by:  
[www.emapsite.com](http://www.emapsite.com)  
[sales@emapsite.com](mailto:sales@emapsite.com)

© Crown copyright and database rights 2019 Ordnance Survey 100035207

Production date: 10 June 2019

Map legend available at:  
[www.groundsure.com/sites/default/files/groundsure\\_legend.pdf](http://www.groundsure.com/sites/default/files/groundsure_legend.pdf)

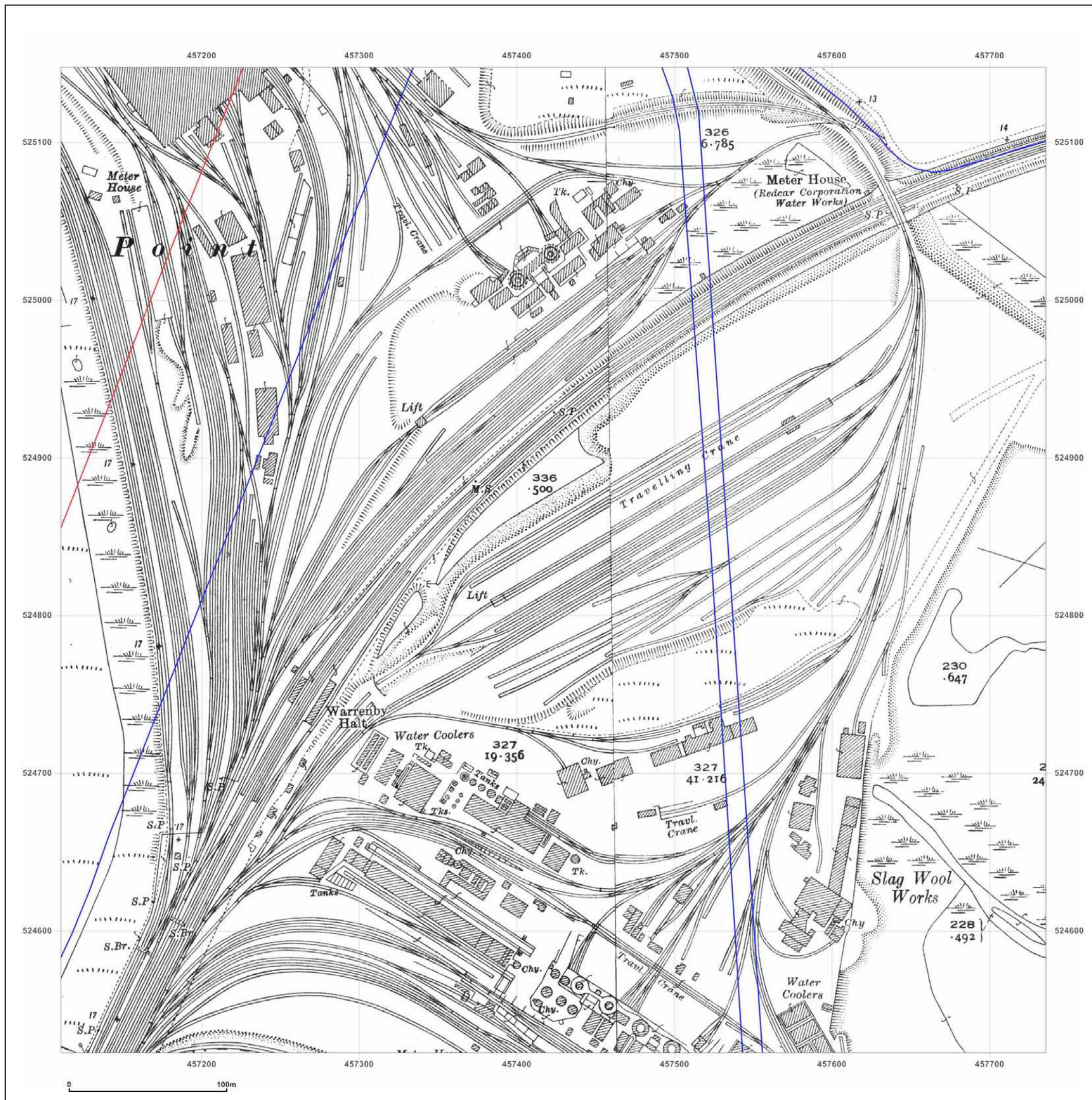



**Site Details:**

South Tees Development

**Client Ref:** EMS\_546959\_736022  
**Report Ref:** EMS-546959\_736022\_LS\_2\_3  
**Grid Ref:** 457423, 524835

**Map Name:** National Grid

**Map date:** 1952-1954

**Scale:** 1:2,500

**Printed at:** 1:2,500



Surveyed 1952  
 Revised 1952  
 Edition N/A  
 Copyright N/A  
 Levelled 1948

Surveyed 1954  
 Revised 1954  
 Edition N/A  
 Copyright N/A  
 Levelled N/A



Produced by  
 Groundsure Insights  
[www.groundsure.com](http://www.groundsure.com)



Supplied by:  
[www.emapsite.com](http://www.emapsite.com)  
[sales@emapsite.com](mailto:sales@emapsite.com)

© Crown copyright and database rights 2019 Ordnance Survey 100035207

Production date: 10 June 2019

Map legend available at:  
[www.groundsure.com/sites/default/files/groundsure\\_legend.pdf](http://www.groundsure.com/sites/default/files/groundsure_legend.pdf)

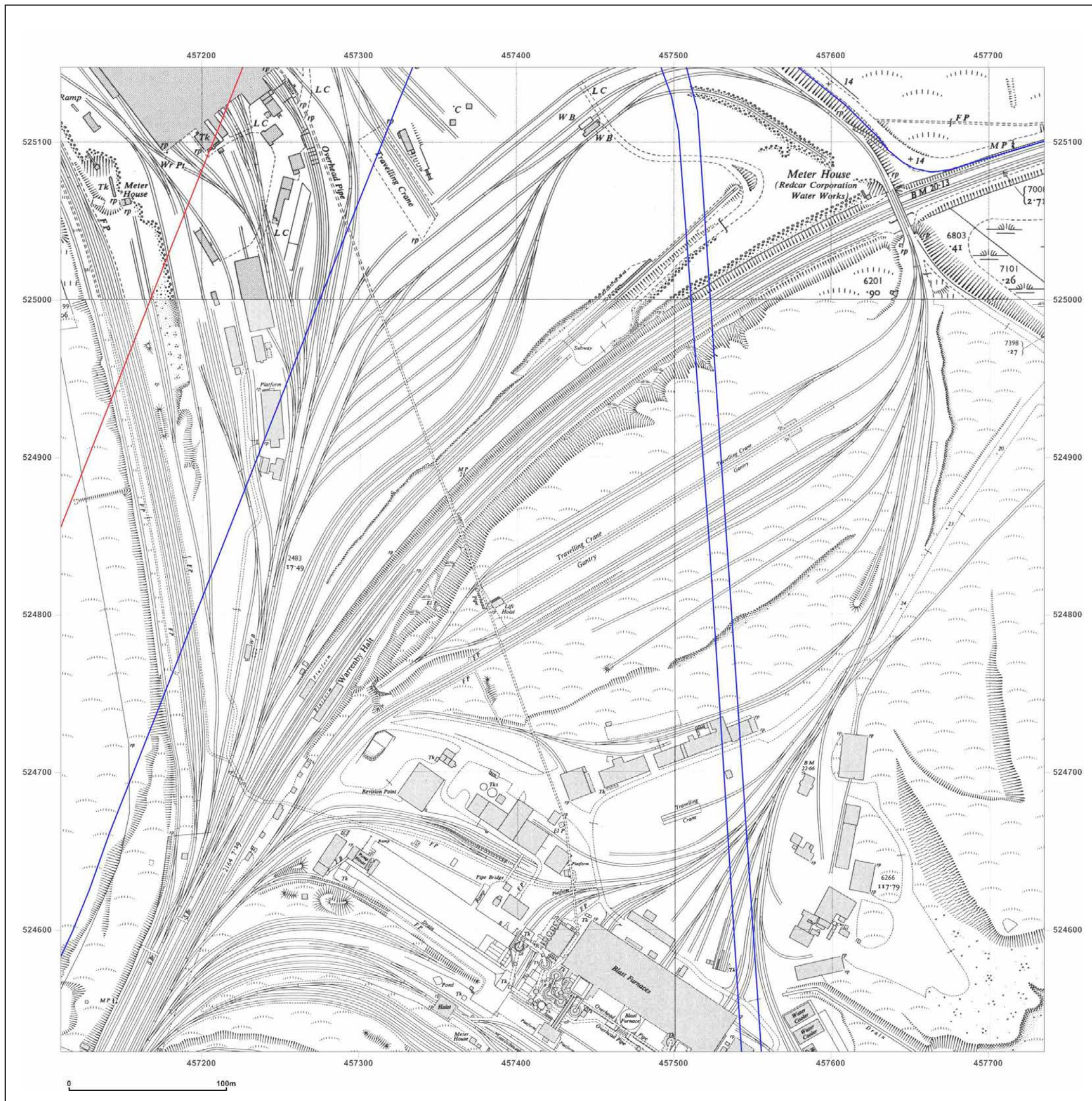



**Site Details:**

South Tees Development

**Client Ref:** EMS\_546959\_736022  
**Report Ref:** EMS-546959\_736022\_LS\_2\_4  
**Grid Ref:** 457423, 525460

**Map Name:** County Series

**Map date:** 1894

**Scale:** 1:2,500

**Printed at:** 1:2,500



Surveyed 1894  
 Revised 1894  
 Edition N/A  
 Copyright N/A  
 Levelled N/A

Surveyed 1894  
 Revised 1894  
 Edition N/A  
 Copyright N/A  
 Levelled N/A

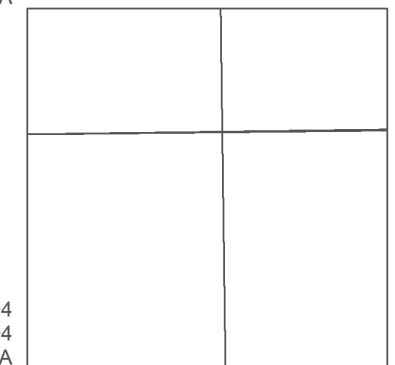

Surveyed 1894  
 Revised 1894  
 Edition N/A  
 Copyright N/A  
 Levelled N/A

Surveyed 1894  
 Revised 1894  
 Edition N/A  
 Copyright N/A  
 Levelled N/A

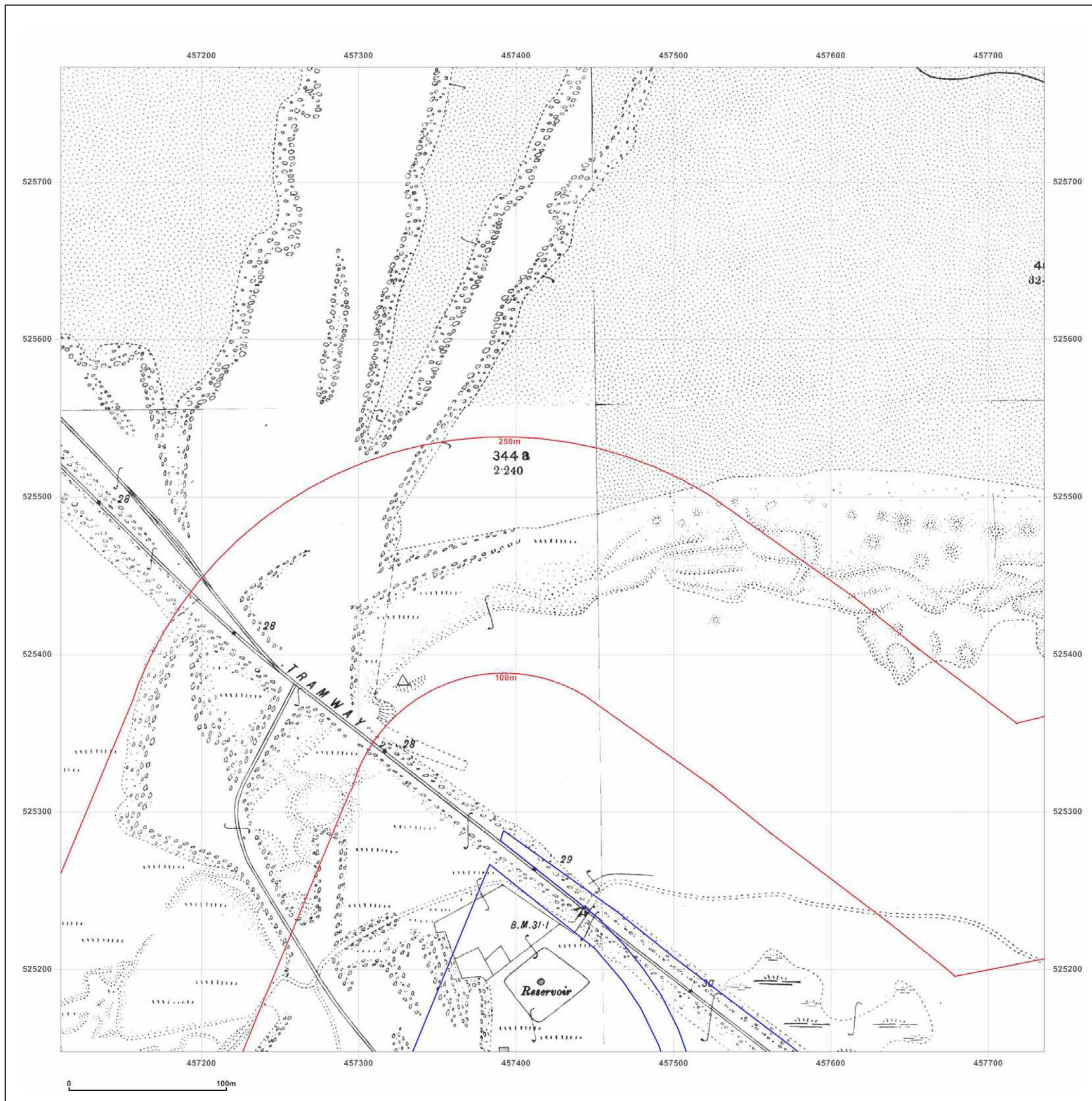

Produced by  
 Groundsure Insights  
[www.groundsure.com](http://www.groundsure.com)



Supplied by:  
[www.emapsite.com](http://www.emapsite.com)  
[sales@emapsite.com](mailto:sales@emapsite.com)

© Crown copyright and database rights 2019 Ordnance Survey 100035207

Production date: 10 June 2019

Map legend available at:  
[www.groundsure.com/sites/default/files/groundsure\\_legend.pdf](http://www.groundsure.com/sites/default/files/groundsure_legend.pdf)



**Site Details:**

South Tees Development

**Client Ref:** EMS\_546959\_736022  
**Report Ref:** EMS-546959\_736022\_LS\_2\_4  
**Grid Ref:** 457423, 525460

**Map Name:** County Series

**Map date:** 1914-1915

**Scale:** 1:2,500

**Printed at:** 1:2,500



Surveyed 1915  
 Revised 1915  
 Edition N/A  
 Copyright N/A  
 Levelled N/A

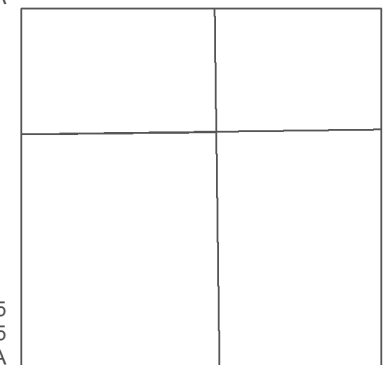

Surveyed 1915  
 Revised 1915  
 Edition N/A  
 Copyright N/A  
 Levelled N/A

Surveyed 1914  
 Revised 1914  
 Edition N/A  
 Copyright N/A  
 Levelled N/A

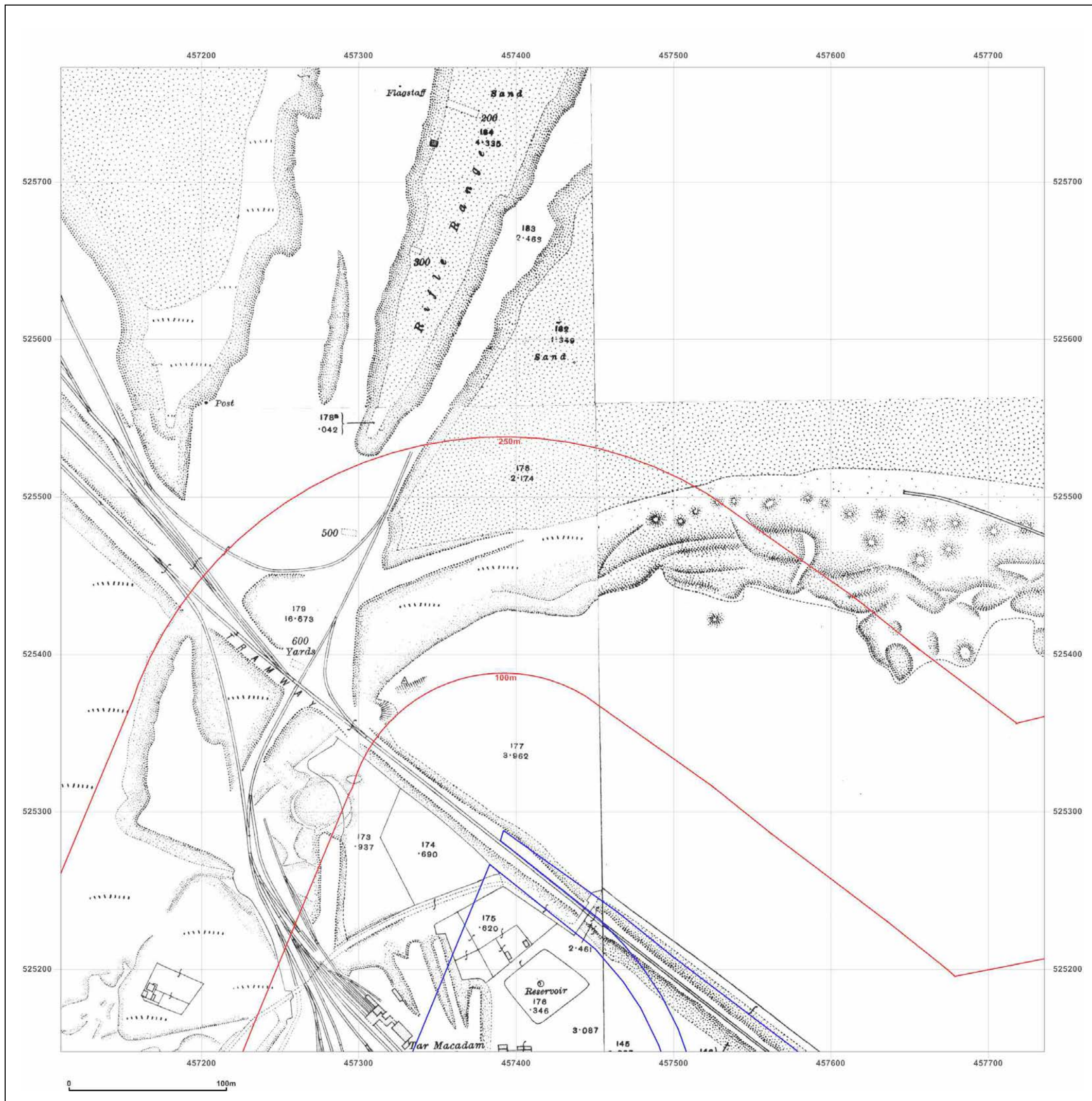

Produced by  
 Groundsure Insights  
[www.groundsure.com](http://www.groundsure.com)



Supplied by:  
[www.emapsite.com](http://www.emapsite.com)  
[sales@emapsite.com](mailto:sales@emapsite.com)

© Crown copyright and database rights 2019 Ordnance Survey 100035207

Production date: 10 June 2019

Map legend available at:  
[www.groundsure.com/sites/default/files/groundsure\\_legend.pdf](http://www.groundsure.com/sites/default/files/groundsure_legend.pdf)



**Site Details:**

South Tees Development

**Client Ref:** EMS\_546959\_736022  
**Report Ref:** EMS-546959\_736022\_LS\_2\_4  
**Grid Ref:** 457423, 525460

**Map Name:** County Series

**Map date:** 1929

**Scale:** 1:2,500

**Printed at:** 1:2,500



Surveyed N/A  
 Revised N/A  
 Edition N/A  
 Copyright N/A  
 Levelled N/A

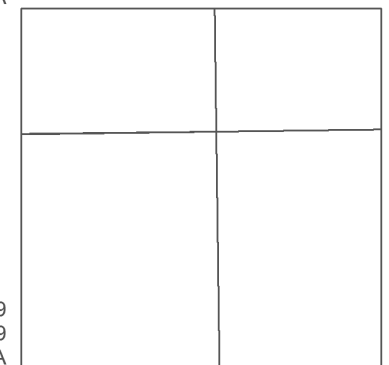

Surveyed 1929  
 Revised 1929  
 Edition N/A  
 Copyright N/A  
 Levelled N/A

Surveyed 1929  
 Revised 1929  
 Edition N/A  
 Copyright N/A  
 Levelled N/A



Produced by  
 Groundsure Insights  
[www.groundsure.com](http://www.groundsure.com)



Supplied by:  
[www.emapsite.com](http://www.emapsite.com)  
[sales@emapsite.com](mailto:sales@emapsite.com)

© Crown copyright and database rights 2019 Ordnance Survey 100035207

Production date: 10 June 2019

Map legend available at:  
[www.groundsure.com/sites/default/files/groundsure\\_legend.pdf](http://www.groundsure.com/sites/default/files/groundsure_legend.pdf)

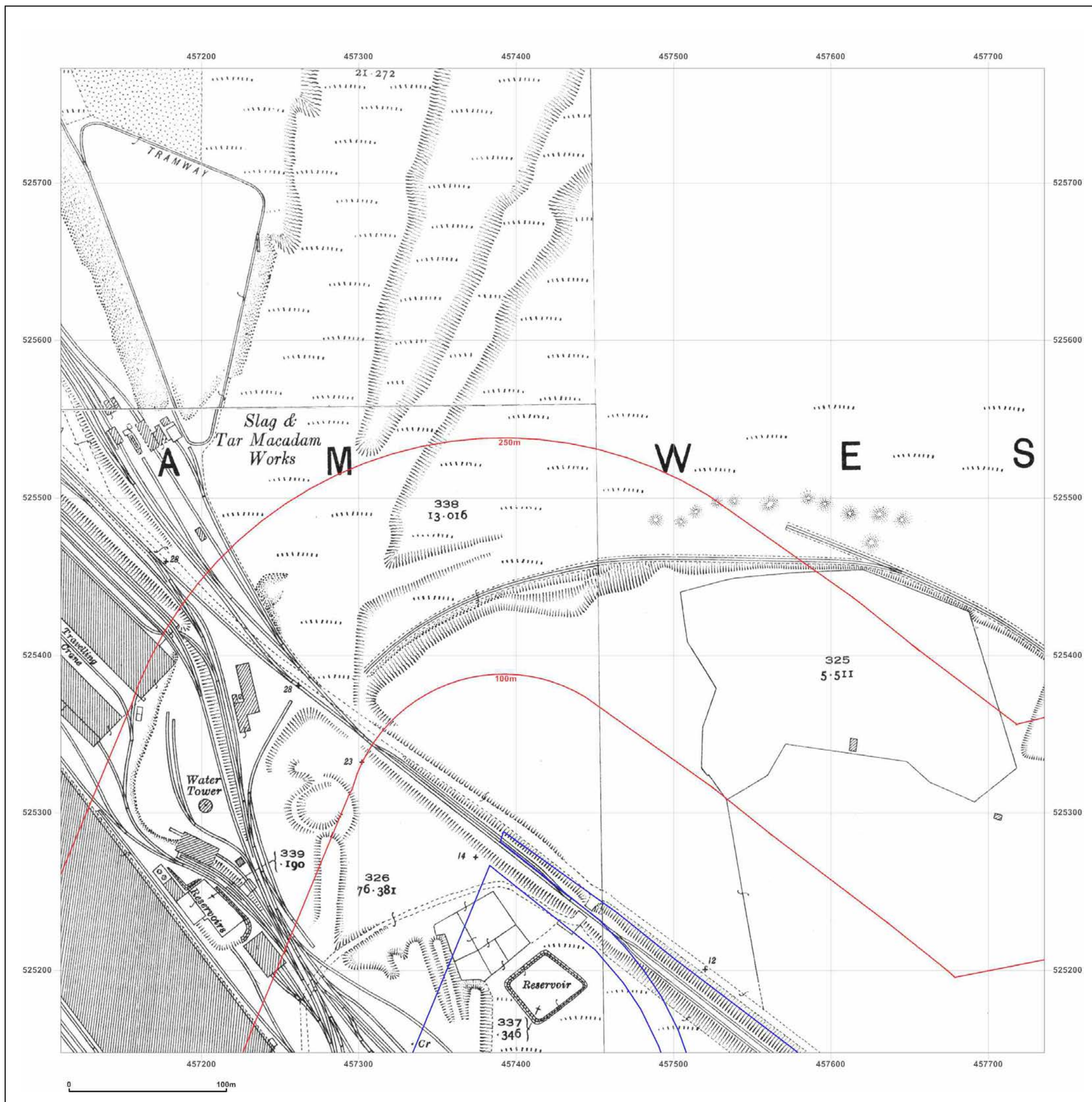



**Site Details:**

South Tees Development

**Client Ref:** EMS\_546959\_736022  
**Report Ref:** EMS-546959\_736022\_LS\_2\_4  
**Grid Ref:** 457423, 525460

**Map Name:** National Grid

**Map date:** 1952

**Scale:** 1:2,500

**Printed at:** 1:2,500



Surveyed 1952  
 Revised 1952  
 Edition N/A  
 Copyright N/A  
 Levelled 1948



Produced by  
 Groundsure Insights  
[www.groundsure.com](http://www.groundsure.com)



Supplied by:  
[www.emapsite.com](http://www.emapsite.com)  
[sales@emapsite.com](mailto:sales@emapsite.com)

© Crown copyright and database rights 2019 Ordnance Survey 100035207

Production date: 10 June 2019

Map legend available at:  
[www.groundsure.com/sites/default/files/groundsure\\_legend.pdf](http://www.groundsure.com/sites/default/files/groundsure_legend.pdf)

