



# 1:1250 Scale Grid Index to Section 1-2







**Groundsure**  
INSIGHTS



**1:1250 Scale Grid Index**

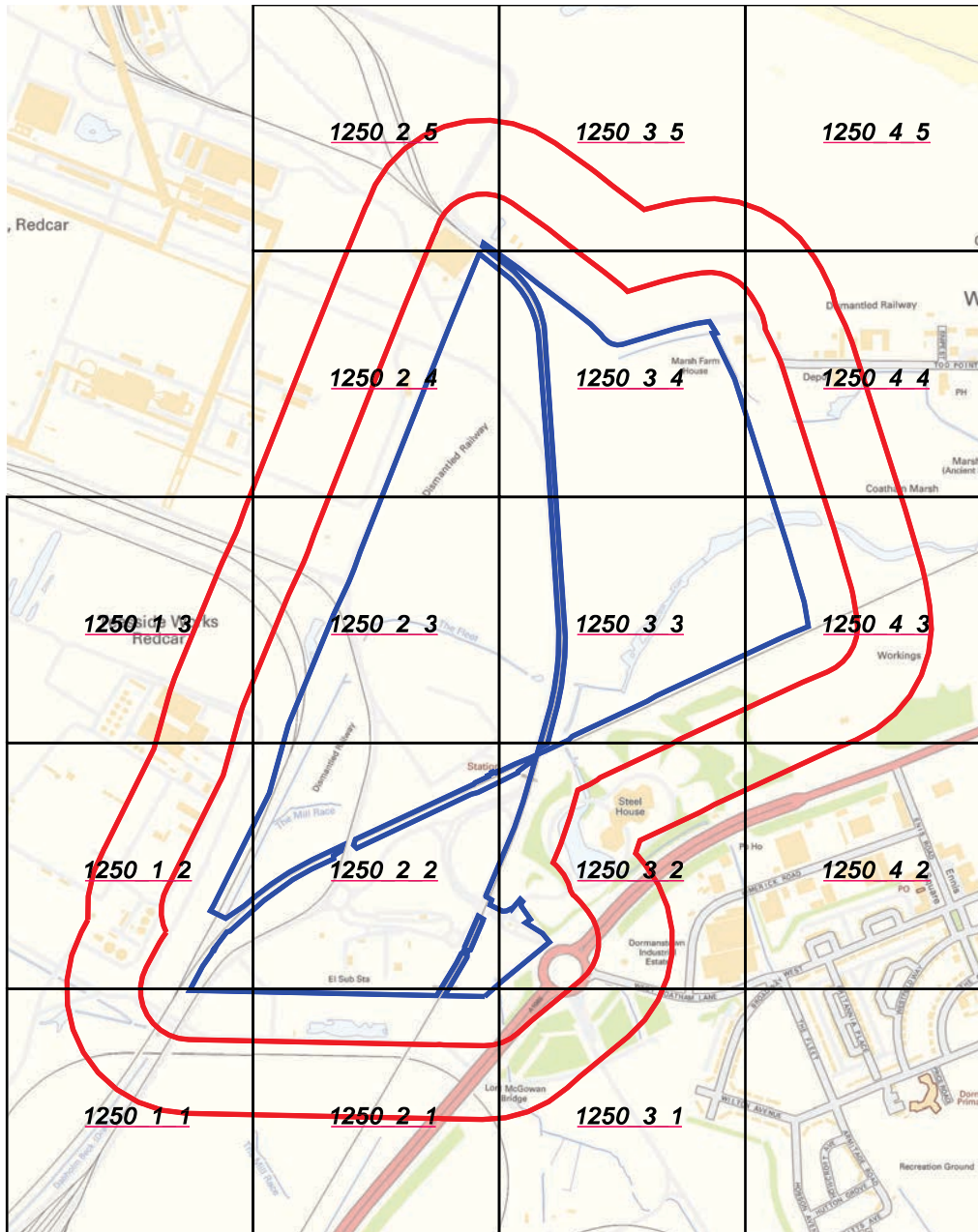

**Site Details:**

South Tees Development

**Client Ref:** EMS\_546959\_736022  
**Report Ref:** EMS-546959\_736022\_1250scale\_1\_1  
**Grid Ref:** 456673, 523522

**Map Name:** National Grid

**Map date:** 1952

**Scale:** 1:1,250

**Printed at:** 1:2,000



Surveyed 1952  
 Revised 1952  
 Edition N/A  
 Copyright N/A  
 Levelled 1948

Surveyed 1952  
 Revised 1952  
 Edition N/A  
 Copyright N/A  
 Levelled 1948

Surveyed 1952  
 Revised 1952  
 Edition N/A  
 Copyright N/A  
 Levelled 1948

Surveyed 1952  
 Revised 1952  
 Edition N/A  
 Copyright N/A  
 Levelled 1948



Produced by  
 Groundsure Insights  
[www.groundsure.com](http://www.groundsure.com)



Supplied by:  
[www.emapsite.com](http://www.emapsite.com)  
[sales@emapsite.com](mailto:sales@emapsite.com)

© Crown copyright and database rights 2019 Ordnance Survey 100035207

Production date: 10 June 2019

Map legend available at:  
[www.groundsure.com/sites/default/files/groundsure\\_legend.pdf](http://www.groundsure.com/sites/default/files/groundsure_legend.pdf)

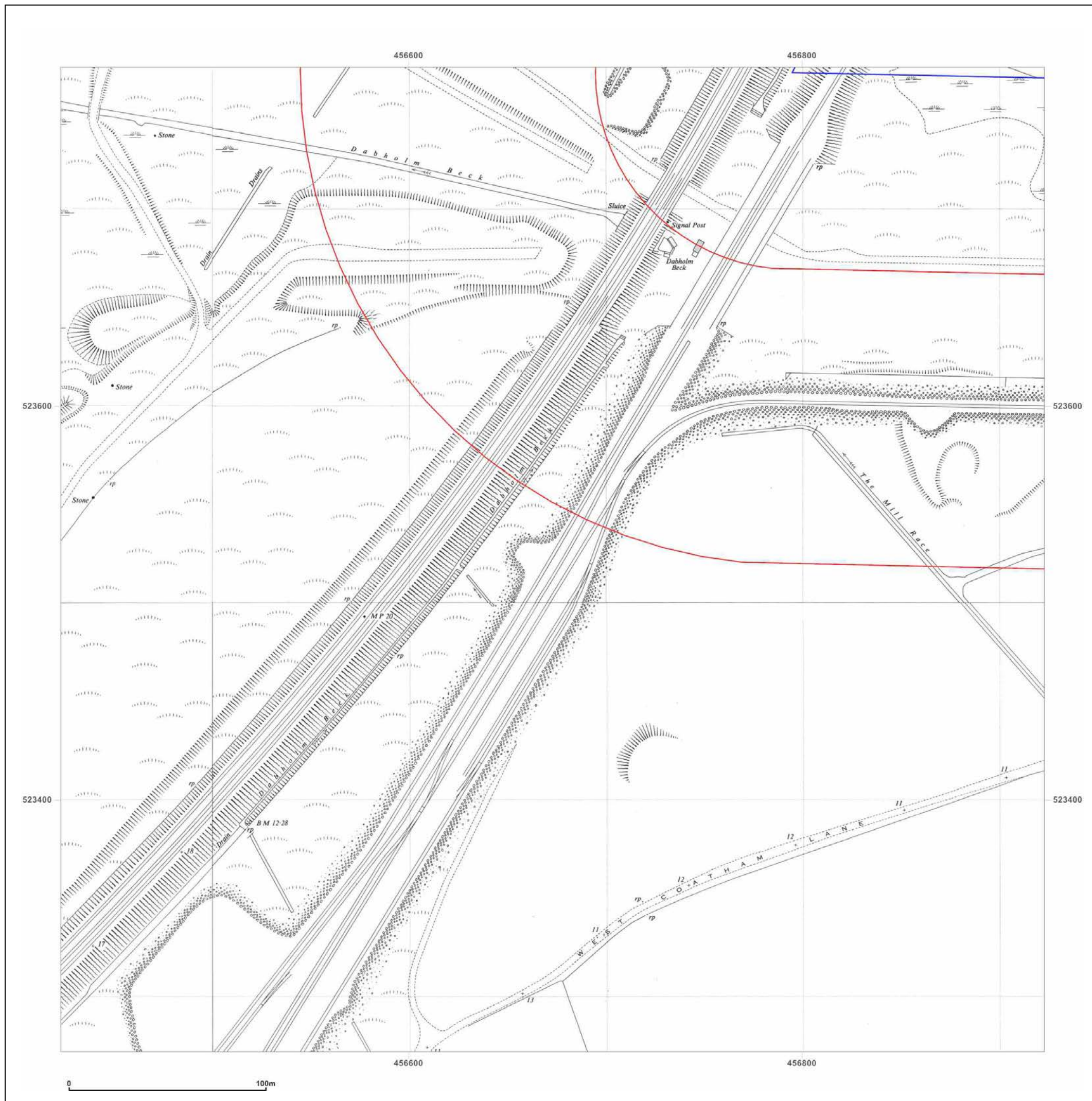

**Site Details:**

South Tees Development

**Client Ref:** EMS\_546959\_736022  
**Report Ref:** EMS-546959\_736022\_1250scale\_1\_1  
**Grid Ref:** 456673, 523522

**Map Name:** National Grid

**Map date:** 1954

**Scale:** 1:1,250

**Printed at:** 1:2,000

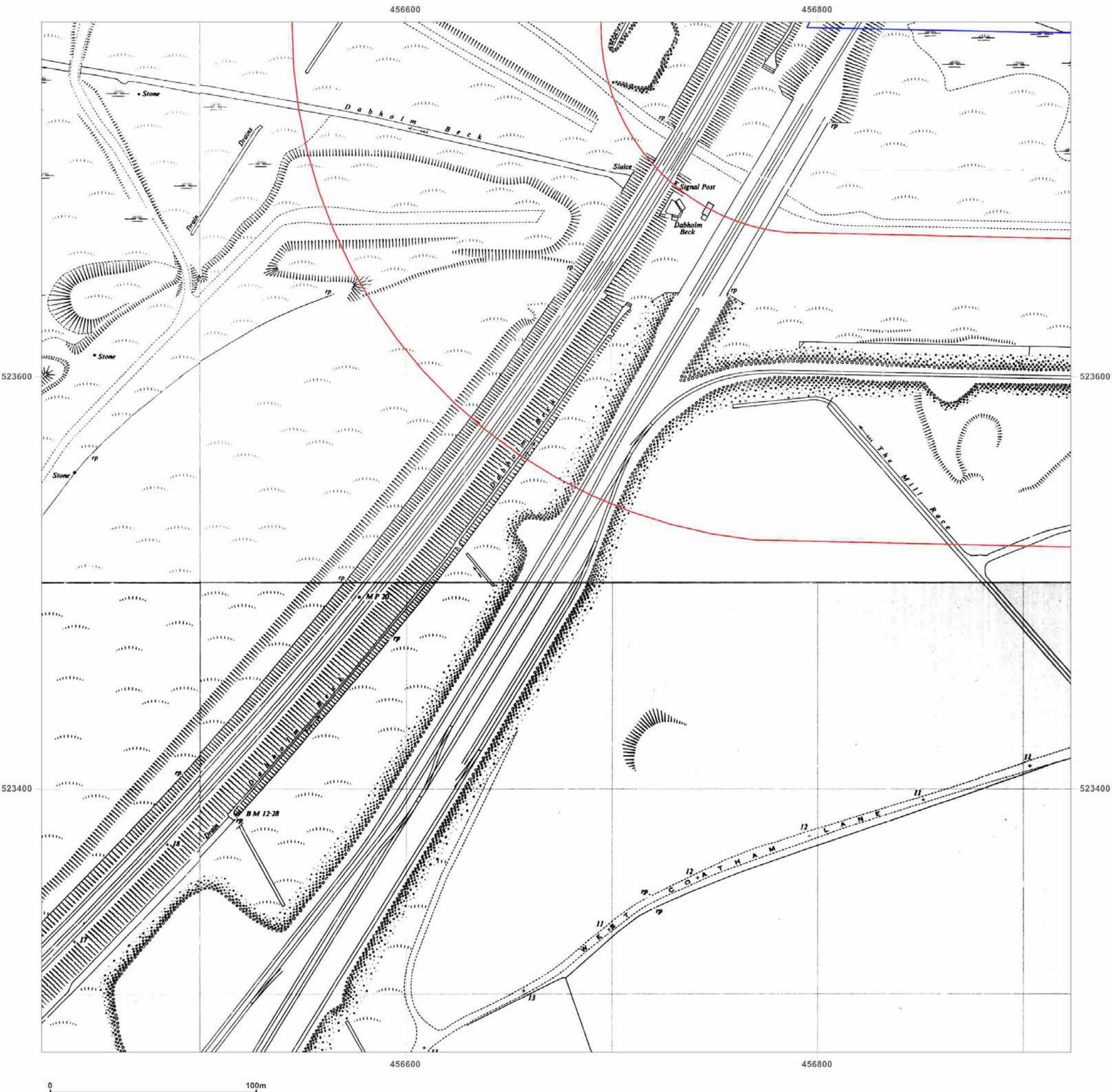

Surveyed N/A  
 Revised N/A  
 Edition N/A  
 Copyright N/A  
 Levelled N/A

Surveyed N/A  
 Revised N/A  
 Edition N/A  
 Copyright N/A  
 Levelled N/A

Surveyed N/A  
 Revised N/A  
 Edition N/A  
 Copyright N/A  
 Levelled N/A

Surveyed N/A  
 Revised N/A  
 Edition N/A  
 Copyright N/A  
 Levelled N/A



Produced by  
 Groundsure Insights  
[www.groundsure.com](http://www.groundsure.com)



Supplied by:  
[www.emapsite.com](http://www.emapsite.com)  
[sales@emapsite.com](mailto:sales@emapsite.com)

© Crown copyright and database rights 2019 Ordnance Survey 100035207

Production date: 10 June 2019

Map legend available at:  
[www.groundsure.com/sites/default/files/groundsure\\_legend.pdf](http://www.groundsure.com/sites/default/files/groundsure_legend.pdf)

**Site Details:**

South Tees Development

**Client Ref:** EMS\_546959\_736022  
**Report Ref:** EMS-546959\_736022\_1250scale\_1\_1  
**Grid Ref:** 456673, 523522

**Map Name:** National Grid

**Map date:** 1960-1963

**Scale:** 1:1,250

**Printed at:** 1:2,000



Surveyed 1962  
 Revised 1962  
 Edition N/A  
 Copyright 1963  
 Levelled 1959

Surveyed 1952  
 Revised 1962  
 Edition N/A  
 Copyright 1963  
 Levelled 1959

Surveyed 1952  
 Revised 1959  
 Edition N/A  
 Copyright 1960  
 Levelled 1948

Surveyed 1962  
 Revised 1962  
 Edition N/A  
 Copyright 1963  
 Levelled 1959



Produced by  
 Groundsure Insights  
[www.groundsure.com](http://www.groundsure.com)



Supplied by:  
[www.emapsite.com](http://www.emapsite.com)  
[sales@emapsite.com](mailto:sales@emapsite.com)

© Crown copyright and database rights 2019 Ordnance Survey 100035207

Production date: 10 June 2019

Map legend available at:  
[www.groundsure.com/sites/default/files/groundsure\\_legend.pdf](http://www.groundsure.com/sites/default/files/groundsure_legend.pdf)

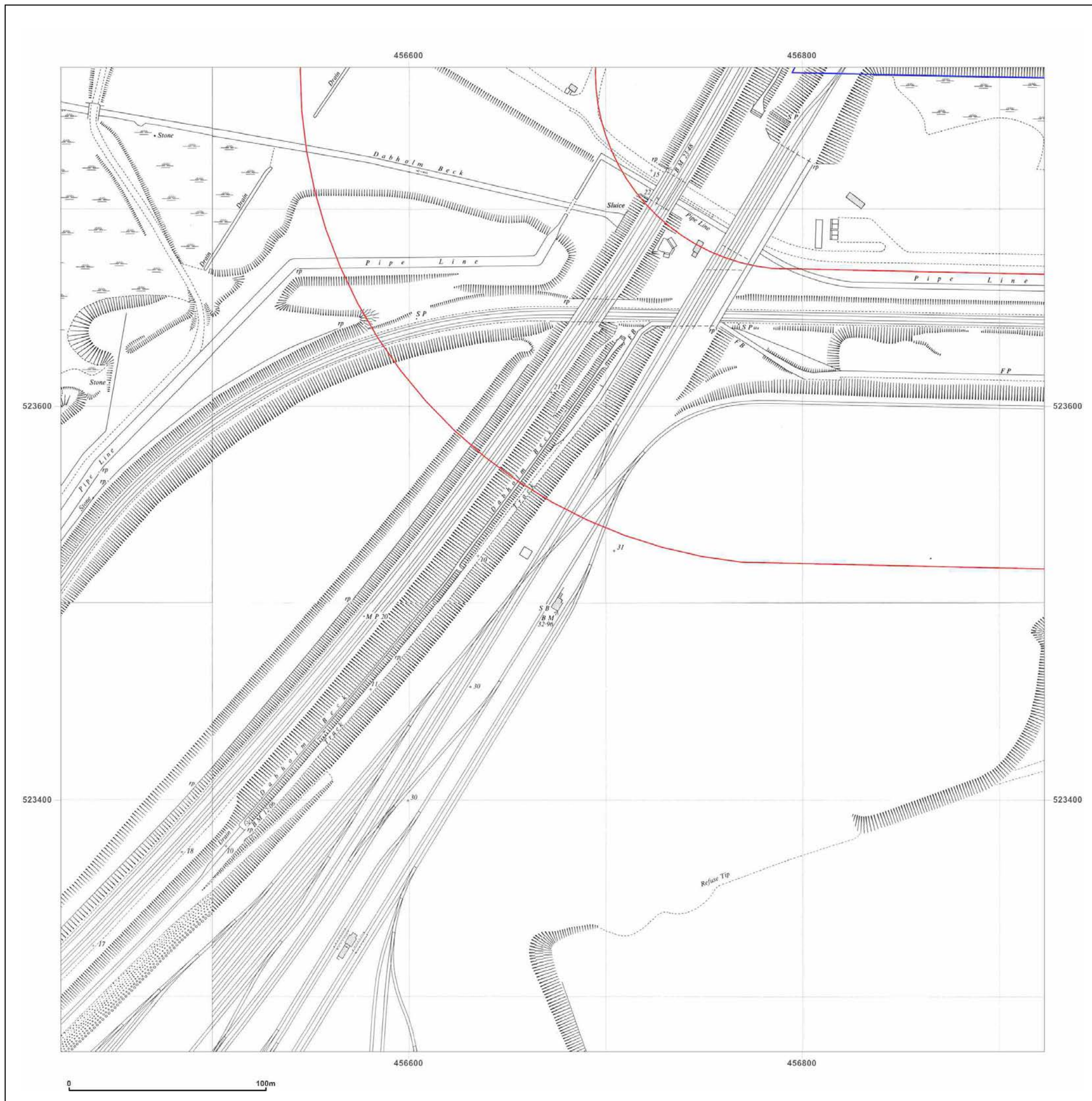

**Site Details:**

South Tees Development

**Client Ref:** EMS\_546959\_736022  
**Report Ref:** EMS-546959\_736022\_1250scale\_1\_1  
**Grid Ref:** 456673, 523522

**Map Name:** National Grid

**Map date:** 1972-1974

**Scale:** 1:1,250

**Printed at:** 1:2,000



Surveyed 1952  
 Revised 1972  
 Edition N/A  
 Copyright 1972  
 Levelled 1959

Surveyed 1952  
 Revised 1973  
 Edition N/A  
 Copyright 1974  
 Levelled 1959

Surveyed 1952  
 Revised 1973  
 Edition N/A  
 Copyright 1974  
 Levelled 1959

Surveyed N/A  
 Revised N/A  
 Edition N/A  
 Copyright N/A  
 Levelled N/A



Produced by  
 Groundsure Insights  
[www.groundsure.com](http://www.groundsure.com)



Supplied by:  
[www.emapsite.com](http://www.emapsite.com)  
[sales@emapsite.com](mailto:sales@emapsite.com)

© Crown copyright and database rights 2019 Ordnance Survey 100035207

Production date: 10 June 2019

Map legend available at:  
[www.groundsure.com/sites/default/files/groundsure\\_legend.pdf](http://www.groundsure.com/sites/default/files/groundsure_legend.pdf)

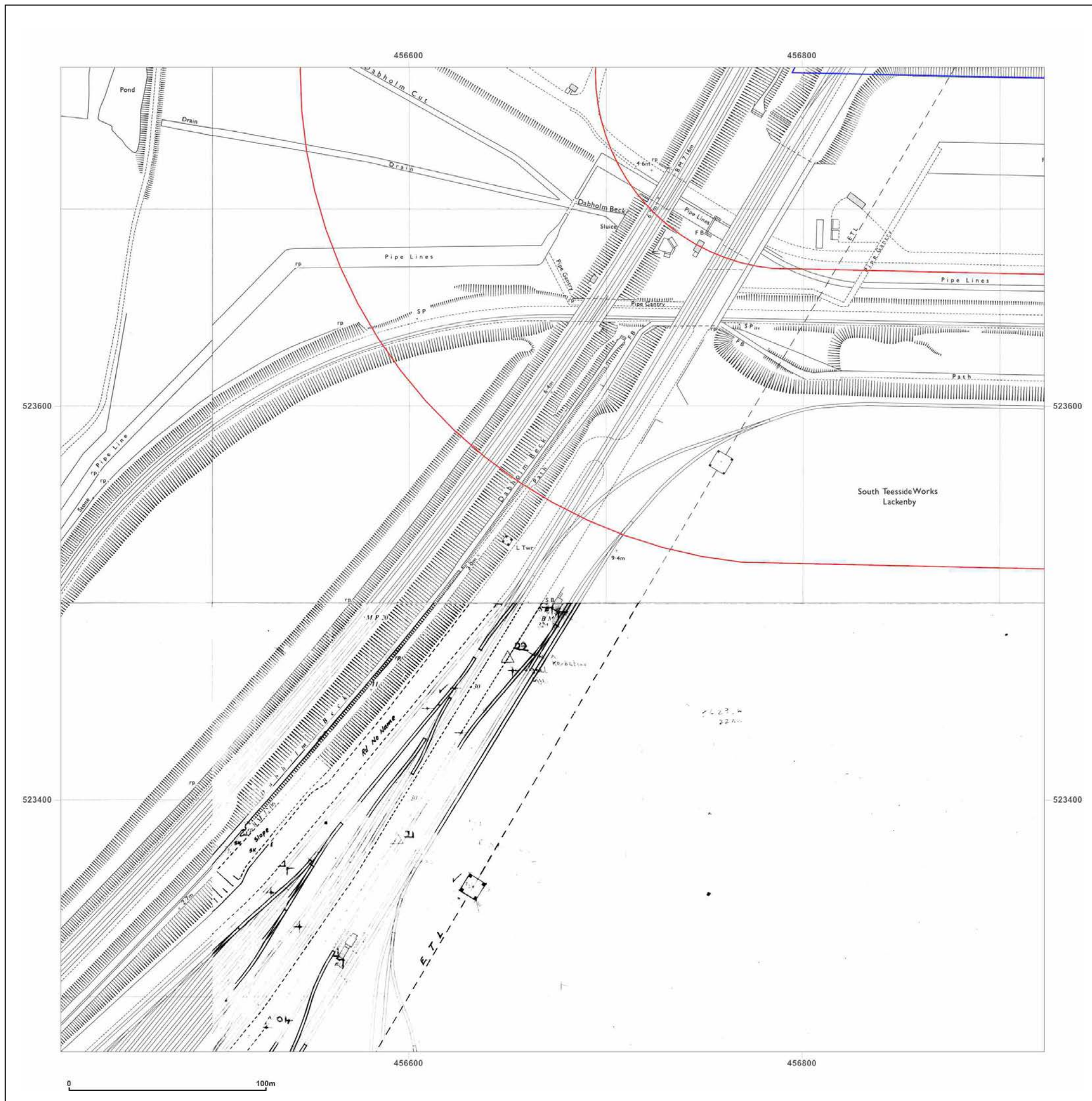

## Site Details:

South Tees Development

**Client Ref:** EMS\_546959\_736022  
**Report Ref:** EMS-546959\_736022\_1250scale\_1\_1  
**Grid Ref:** 456673, 523522

**Map Name:** National Grid

**Map date:** 1974-1975

**Scale:** 1:1,250

**Printed at:** 1:2,000



Surveyed N/A  
Revised N/A  
Edition N/A  
Copyright N/A  
Levelled N/A

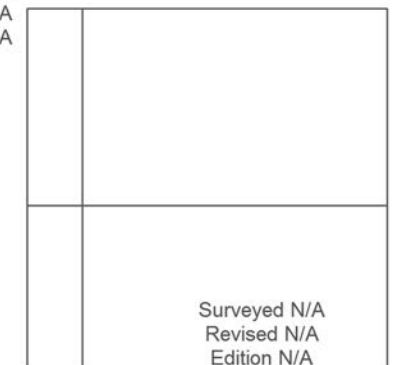

Surveyed N/A  
Revised N/A  
Edition N/A  
Copyright N/A  
Levelled N/A



Produced by  
Groundsure Insights  
[www.groundsure.com](http://www.groundsure.com)



Supplied by:  
[www.emapsite.com](http://www.emapsite.com)  
[sales@emapsite.com](mailto:sales@emapsite.com)

© Crown copyright and database rights 2019 Ordnance Survey 100035207

Production date: 10 June 2019

Map legend available at:  
[www.groundsure.com/sites/default/files/groundsure\\_legend.pdf](http://www.groundsure.com/sites/default/files/groundsure_legend.pdf)

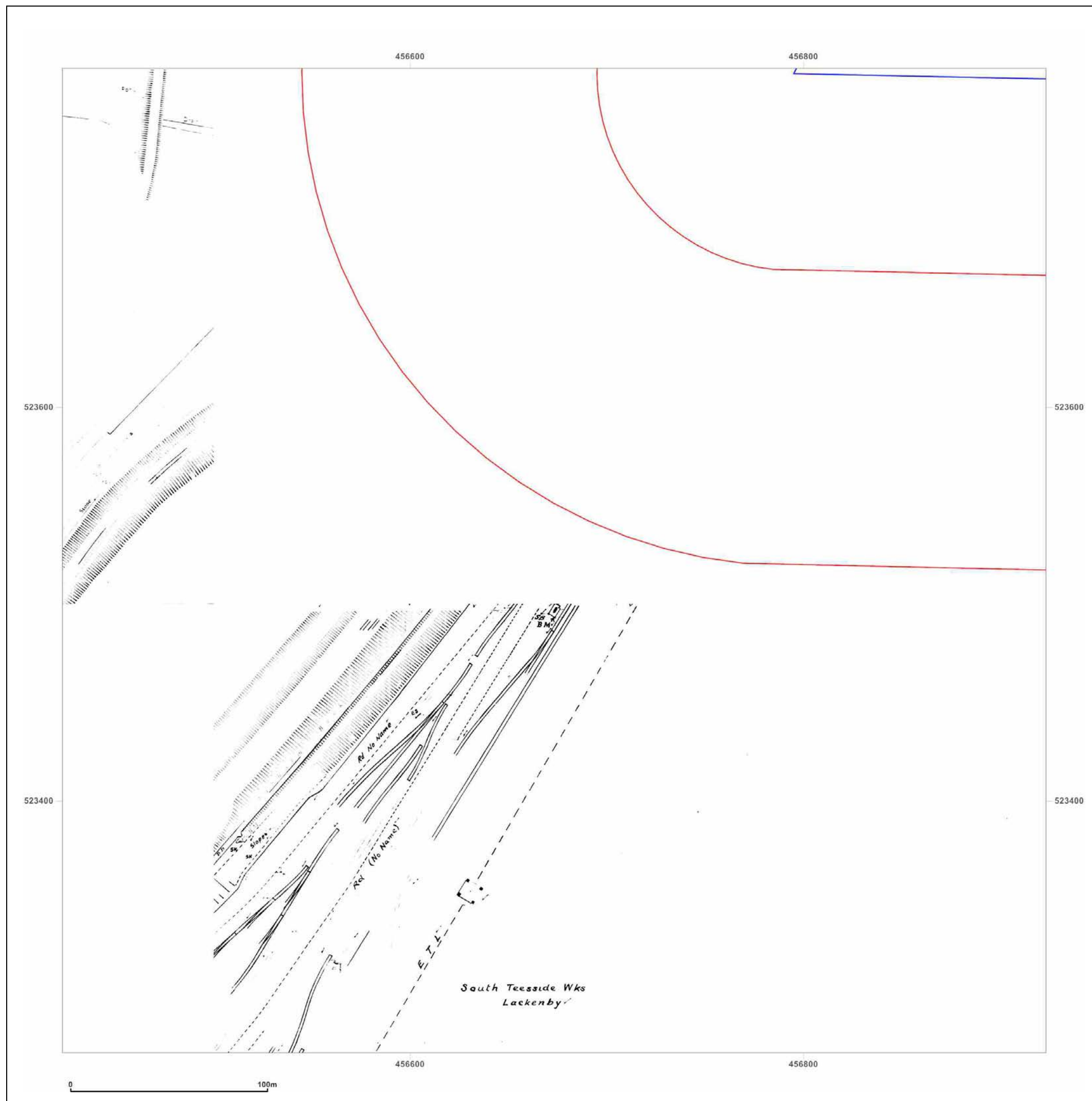



**Site Details:**

South Tees Development

**Client Ref:** EMS\_546959\_736022  
**Report Ref:** EMS-546959\_736022\_1250scale\_1\_1  
**Grid Ref:** 456673, 523522

**Map Name:** National Grid

**Map date:** 1976-1980

**Scale:** 1:1,250

**Printed at:** 1:2,000

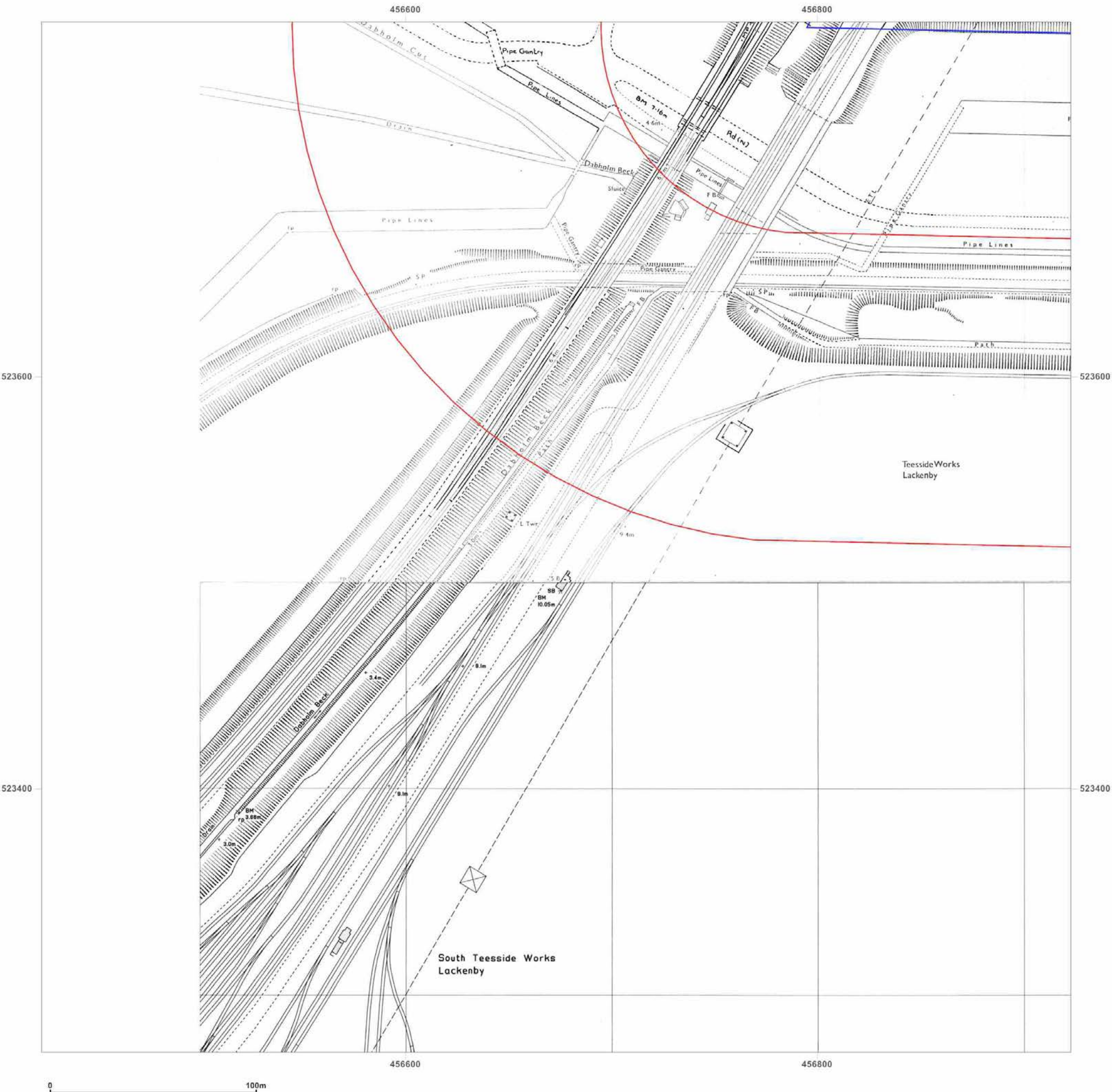

Surveyed 1959  
 Revised 1980  
 Edition N/A  
 Copyright 1980  
 Levelled 1959

Surveyed 1952  
 Revised 1975  
 Edition N/A  
 Copyright 1976  
 Levelled 1959



Produced by  
 Groundsure Insights  
[www.groundsure.com](http://www.groundsure.com)



Supplied by:  
[www.emapsite.com](http://www.emapsite.com)  
[sales@emapsite.com](mailto:sales@emapsite.com)

© Crown copyright and database rights 2019 Ordnance Survey 100035207

Production date: 10 June 2019

Map legend available at:  
[www.groundsure.com/sites/default/files/groundsure\\_legend.pdf](http://www.groundsure.com/sites/default/files/groundsure_legend.pdf)

**Site Details:**

South Tees Development

**Client Ref:** EMS\_546959\_736022  
**Report Ref:** EMS-546959\_736022\_1250scale\_1\_1  
**Grid Ref:** 456673, 523522

**Map Name:** National Grid**Map date:** 1981-1983**Scale:** 1:1,250**Printed at:** 1:2,000

Surveyed N/A  
Revised N/A  
Edition N/A  
Copyright 1983  
Levelled 1959

Surveyed N/A  
Revised N/A  
Edition N/A  
Copyright 1981  
Levelled 1959



Produced by  
Groundsure Insights  
[www.groundsure.com](http://www.groundsure.com)



Supplied by:  
[www.emapsite.com](http://www.emapsite.com)  
[sales@emapsite.com](mailto:sales@emapsite.com)

© Crown copyright and database rights 2019 Ordnance Survey 100035207

Production date: 10 June 2019

Map legend available at:  
[www.groundsure.com/sites/default/files/groundsure\\_legend.pdf](http://www.groundsure.com/sites/default/files/groundsure_legend.pdf)

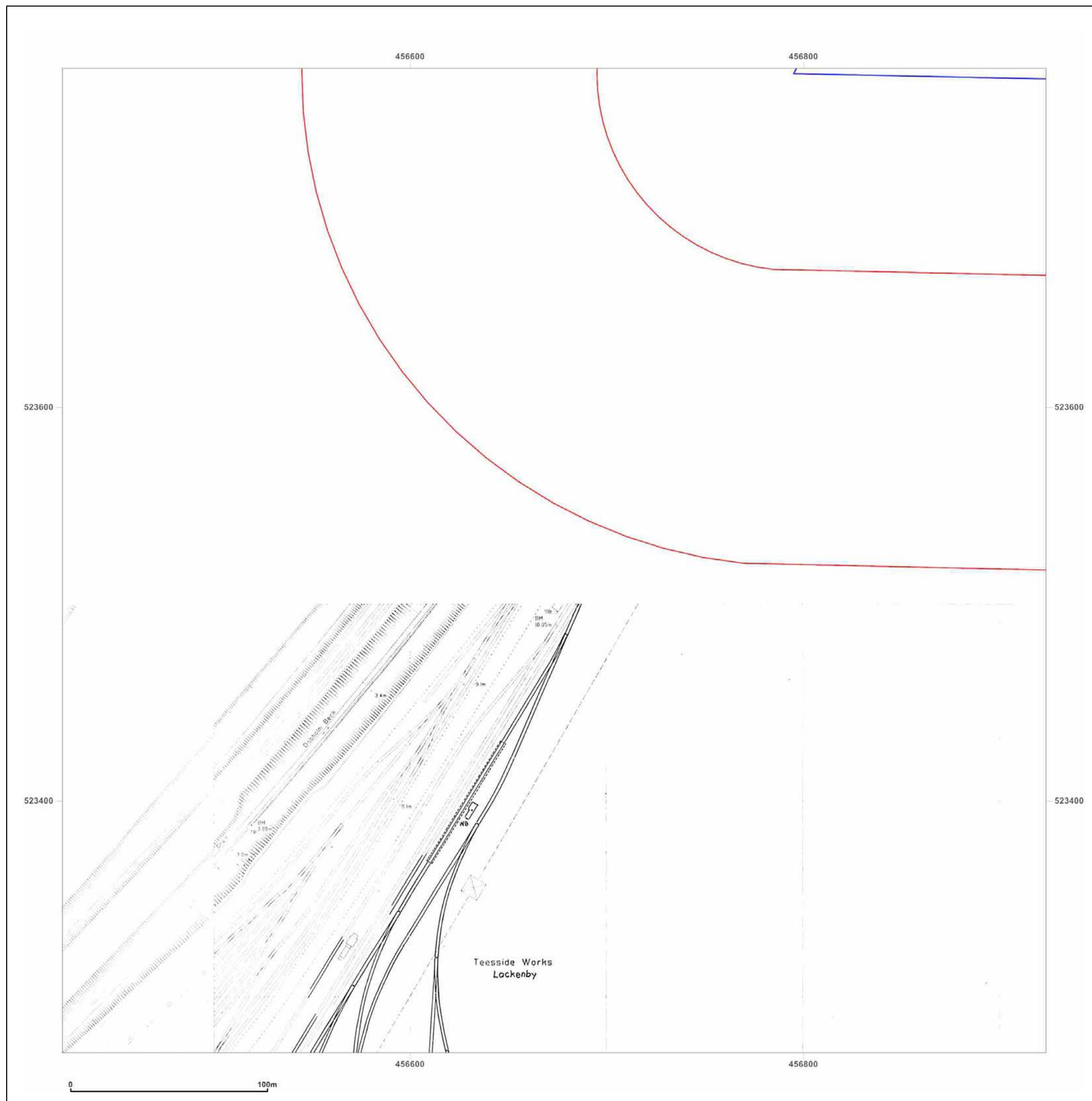

**Site Details:**

South Tees Development

**Client Ref:** EMS\_546959\_736022  
**Report Ref:** EMS-546959\_736022\_1250scale\_1\_1  
**Grid Ref:** 456673, 523522

**Map Name:** National Grid

**Map date:** 1987-1992

**Scale:** 1:1,250

**Printed at:** 1:2,000



Surveyed 1992  
 Revised 1992  
 Edition N/A  
 Copyright 1992  
 Levelled N/A

Surveyed 1952  
 Revised 1973  
 Edition N/A  
 Copyright 1989  
 Levelled N/A

Surveyed 1959  
 Revised 1987  
 Edition N/A  
 Copyright 1987  
 Levelled 1959



Produced by  
 Groundsure Insights  
[www.groundsure.com](http://www.groundsure.com)



Supplied by:  
[www.emapsite.com](http://www.emapsite.com)  
[sales@emapsite.com](mailto:sales@emapsite.com)

© Crown copyright and database rights 2019 Ordnance Survey 100035207

Production date: 10 June 2019

Map legend available at:  
[www.groundsure.com/sites/default/files/groundsure\\_legend.pdf](http://www.groundsure.com/sites/default/files/groundsure_legend.pdf)

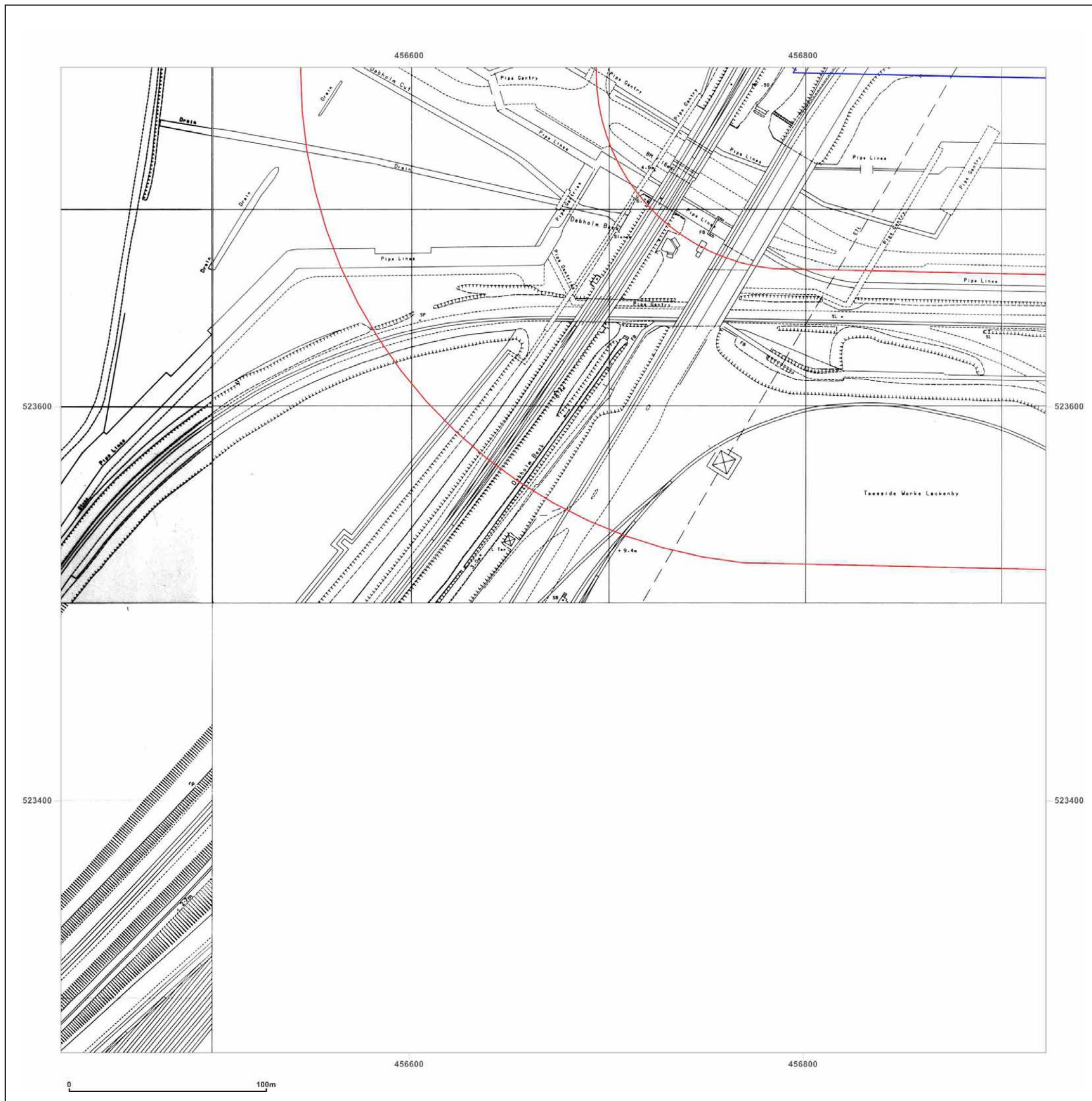

**Site Details:**

South Tees Development

**Client Ref:** EMS\_546959\_736022  
**Report Ref:** EMS-546959\_736022\_1250scale\_1\_1  
**Grid Ref:** 456673, 523522

**Map Name:** National Grid

**Map date:** 1993

**Scale:** 1:1,250

**Printed at:** 1:2,000



Surveyed N/A	Surveyed 1993
Revised N/A	Revised 1993
Edition N/A	Edition N/A
Copyright 1993	Copyright N/A
Levelled N/A	Levelled N/A

Surveyed N/A	Surveyed 1993
Revised N/A	Revised 1993
Edition N/A	Edition N/A
Copyright 1993	Copyright N/A
Levelled N/A	Levelled N/A



Produced by  
Groundsure Insights  
[www.groundsure.com](http://www.groundsure.com)



Supplied by:  
[www.emapsite.com](http://www.emapsite.com)  
sales@emapsite.com

© Crown copyright and database rights 2019 Ordnance Survey 100035207

Production date: 10 June 2019

Map legend available at:  
[www.groundsure.com/sites/default/files/groundsure\\_legend.pdf](http://www.groundsure.com/sites/default/files/groundsure_legend.pdf)

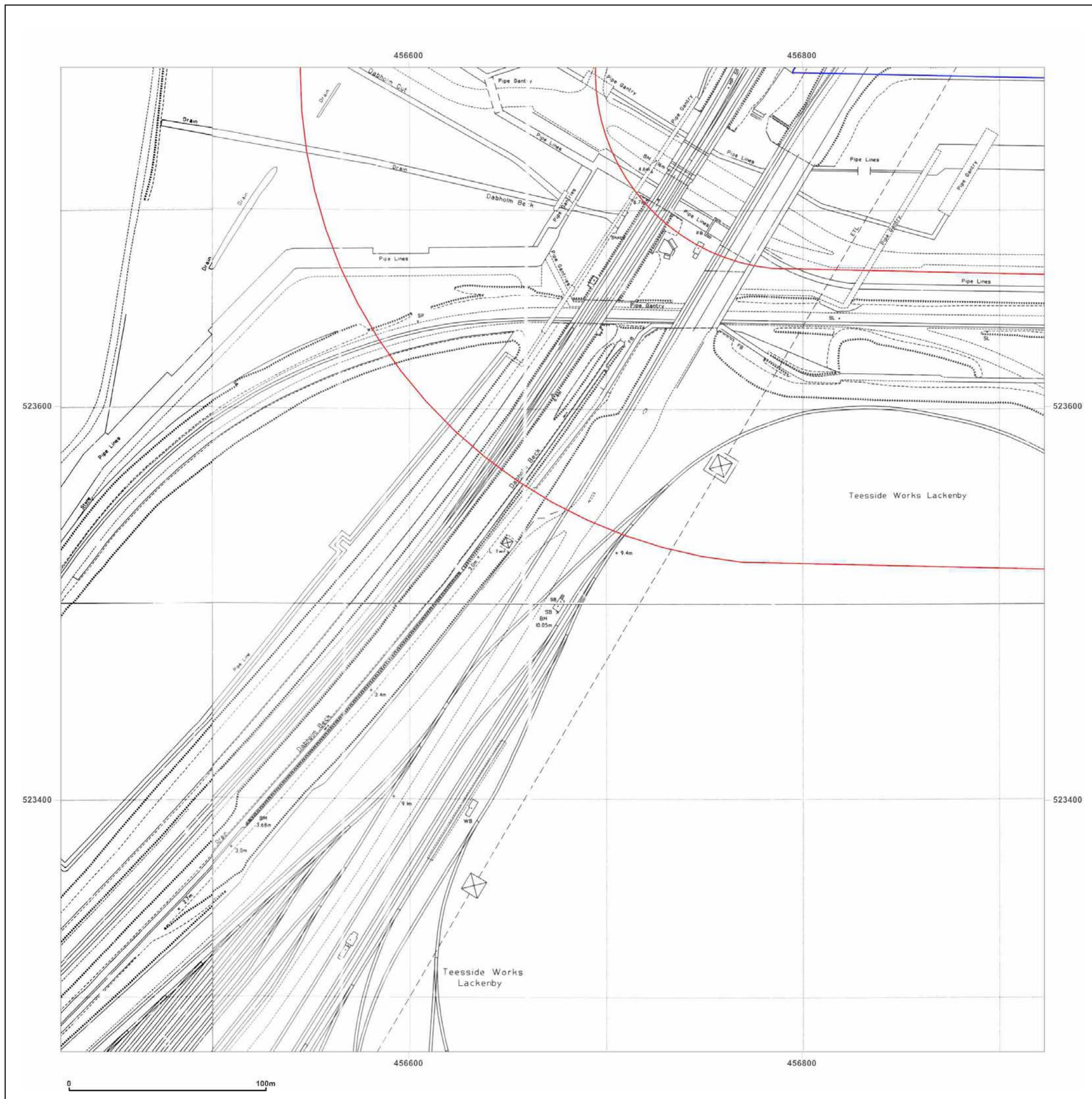

**Site Details:**

South Tees Development

**Client Ref:** EMS\_546959\_736022  
**Report Ref:** EMS-546959\_736022\_1250scale\_1\_2  
**Grid Ref:** 456673, 524022

**Map Name:** National Grid

**Map date:** 1952

**Scale:** 1:1,250

**Printed at:** 1:2,000



Surveyed 1952  
 Revised 1952  
 Edition N/A  
 Copyright N/A  
 Levelled 1948

Surveyed 1952  
 Revised 1952  
 Edition N/A  
 Copyright N/A  
 Levelled 1948

Surveyed 1952  
 Revised 1952  
 Edition N/A  
 Copyright N/A  
 Levelled 1948

Surveyed 1952  
 Revised 1952  
 Edition N/A  
 Copyright N/A  
 Levelled 1948



Produced by  
 Groundsure Insights  
[www.groundsure.com](http://www.groundsure.com)



Supplied by:  
[www.emapsite.com](http://www.emapsite.com)  
[sales@emapsite.com](mailto:sales@emapsite.com)

© Crown copyright and database rights 2019 Ordnance Survey 100035207

Production date: 10 June 2019

Map legend available at:  
[www.groundsure.com/sites/default/files/groundsure\\_legend.pdf](http://www.groundsure.com/sites/default/files/groundsure_legend.pdf)

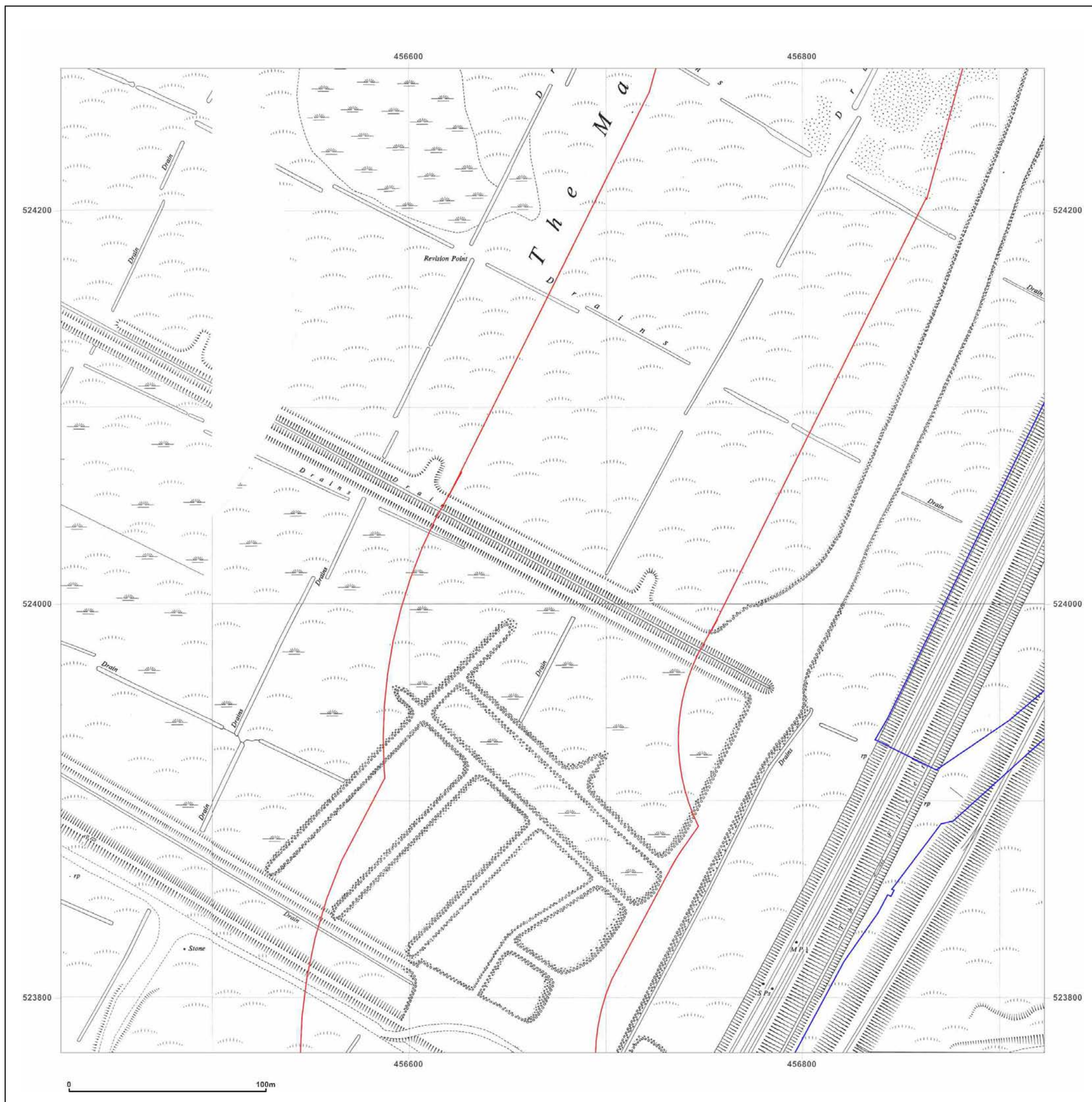

**Site Details:**

South Tees Development

**Client Ref:** EMS\_546959\_736022  
**Report Ref:** EMS-546959\_736022\_1250scale\_1\_2  
**Grid Ref:** 456673, 524022

**Map Name:** National Grid

**Map date:** 1954-1955

**Scale:** 1:1,250

**Printed at:** 1:2,000



Surveyed N/A  
 Revised N/A  
 Edition N/A  
 Copyright N/A  
 Levelled N/A

Surveyed N/A  
 Revised N/A  
 Edition N/A  
 Copyright N/A  
 Levelled N/A

Surveyed N/A  
 Revised N/A  
 Edition N/A  
 Copyright N/A  
 Levelled N/A

Surveyed N/A  
 Revised N/A  
 Edition N/A  
 Copyright N/A  
 Levelled N/A



Produced by  
 Groundsure Insights  
[www.groundsure.com](http://www.groundsure.com)



Supplied by:  
[www.emapsite.com](http://www.emapsite.com)  
[sales@emapsite.com](mailto:sales@emapsite.com)

© Crown copyright and database rights 2019 Ordnance Survey 100035207

Production date: 10 June 2019

Map legend available at:  
[www.groundsure.com/sites/default/files/groundsure\\_legend.pdf](http://www.groundsure.com/sites/default/files/groundsure_legend.pdf)



**Site Details:**

South Tees Development

**Client Ref:** EMS\_546959\_736022  
**Report Ref:** EMS-546959\_736022\_1250scale\_1\_2  
**Grid Ref:** 456673, 524022

**Map Name:** National Grid

**Map date:** 1963

**Scale:** 1:1,250

**Printed at:** 1:2,000



Surveyed 1962  
 Revised 1962  
 Edition N/A  
 Copyright 1963  
 Levelled 1959

Surveyed 1952  
 Revised 1962  
 Edition N/A  
 Copyright 1963  
 Levelled 1959



Produced by  
 Groundsure Insights  
[www.groundsure.com](http://www.groundsure.com)



Supplied by:  
[www.emapsite.com](http://www.emapsite.com)  
[sales@emapsite.com](mailto:sales@emapsite.com)

© Crown copyright and database rights 2019 Ordnance Survey 100035207

Production date: 10 June 2019

Map legend available at:  
[www.groundsure.com/sites/default/files/groundsure\\_legend.pdf](http://www.groundsure.com/sites/default/files/groundsure_legend.pdf)

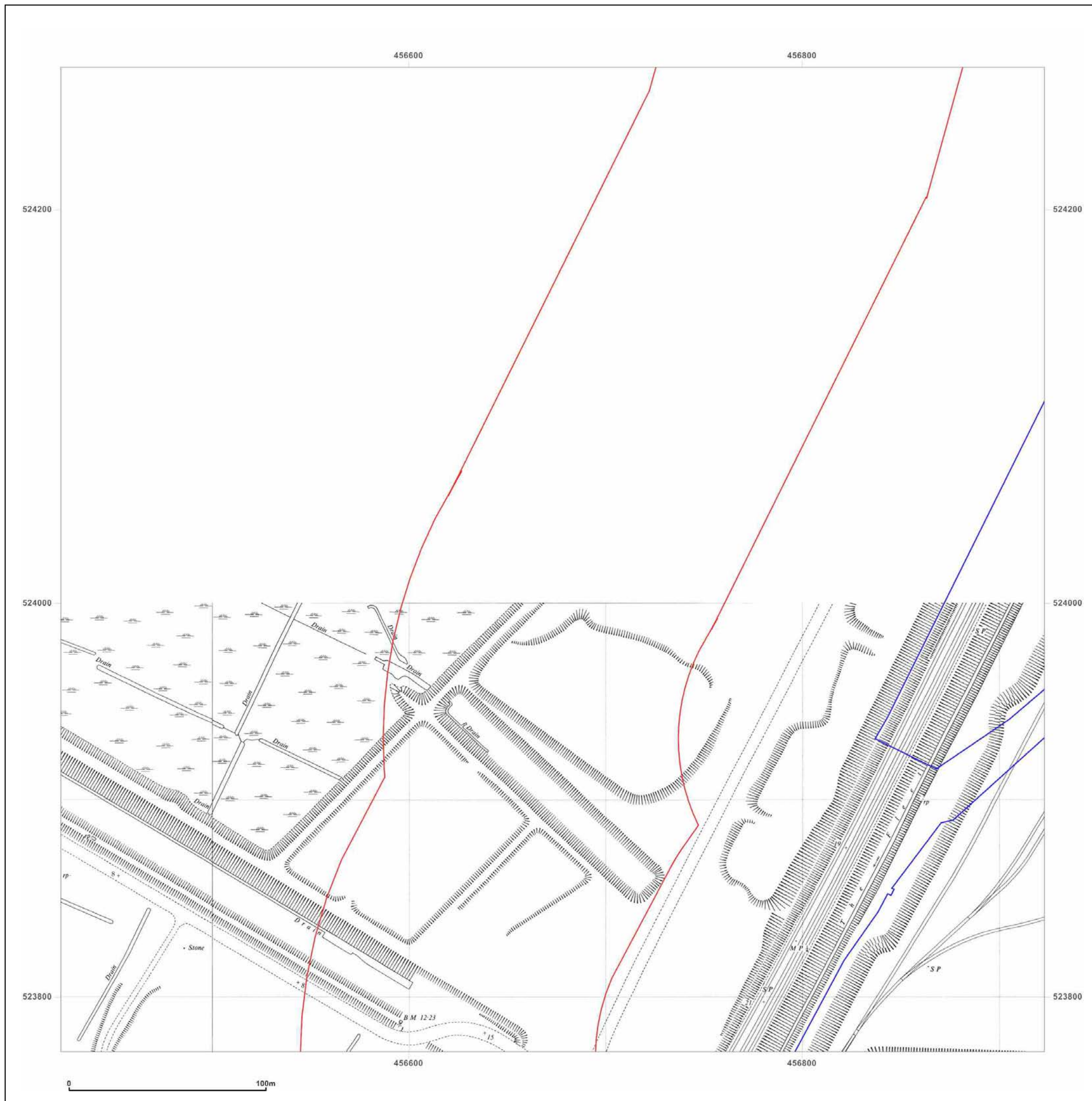

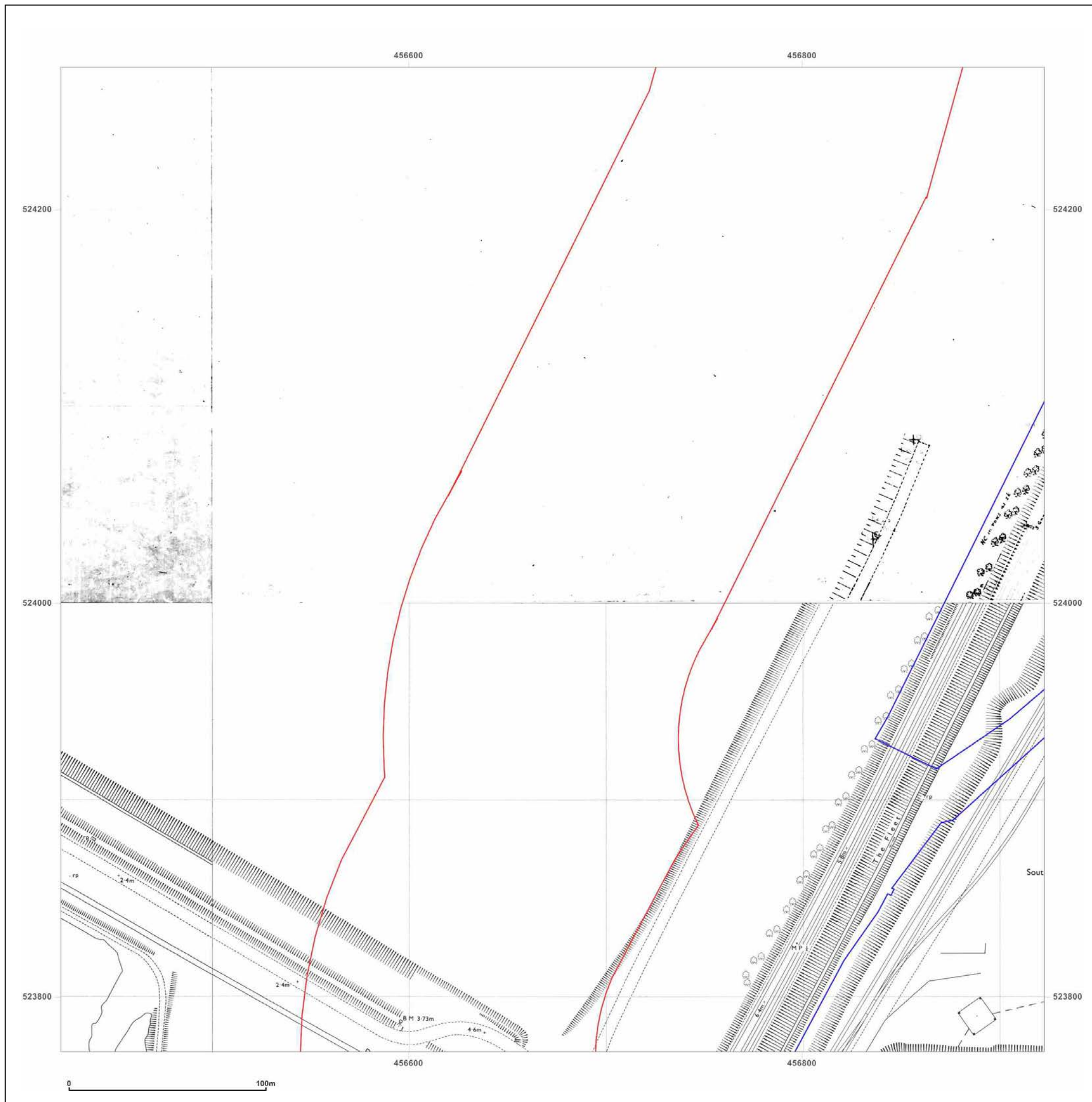

**Site Details:**

South Tees Development

**Client Ref:** EMS\_546959\_736022  
**Report Ref:** EMS-546959\_736022\_1250scale\_1\_2  
**Grid Ref:** 456673, 524022

**Map Name:** National Grid

**Map date:** 1972-1974

**Scale:** 1:1,250

**Printed at:** 1:2,000



Surveyed N/A	Surveyed N/A
Revised N/A	Revised N/A
Edition N/A	Edition N/A
Copyright N/A	Copyright N/A
Levelled N/A	Levelled N/A
Surveyed 1952	Surveyed 1952
Revised 1972	Revised 1973
Edition N/A	Edition N/A
Copyright 1972	Copyright 1974
Levelled 1959	Levelled 1959



Produced by  
 Groundsure Insights  
[www.groundsure.com](http://www.groundsure.com)



Supplied by:  
[www.emapsite.com](http://www.emapsite.com)  
[sales@emapsite.com](mailto:sales@emapsite.com)



**Site Details:**

South Tees Development

**Client Ref:** EMS\_546959\_736022  
**Report Ref:** EMS-546959\_736022\_1250scale\_1\_2  
**Grid Ref:** 456673, 524022

**Map Name:** National Grid

**Map date:** 1974-1976

**Scale:** 1:1,250

**Printed at:** 1:2,000



Surveyed 1952  
 Revised 1975  
 Edition N/A  
 Copyright 1976  
 Levelled 1959

Surveyed 1952  
 Revised 1975  
 Edition N/A  
 Copyright 1975  
 Levelled 1959

Surveyed N/A  
 Revised N/A  
 Edition N/A  
 Copyright N/A  
 Levelled N/A

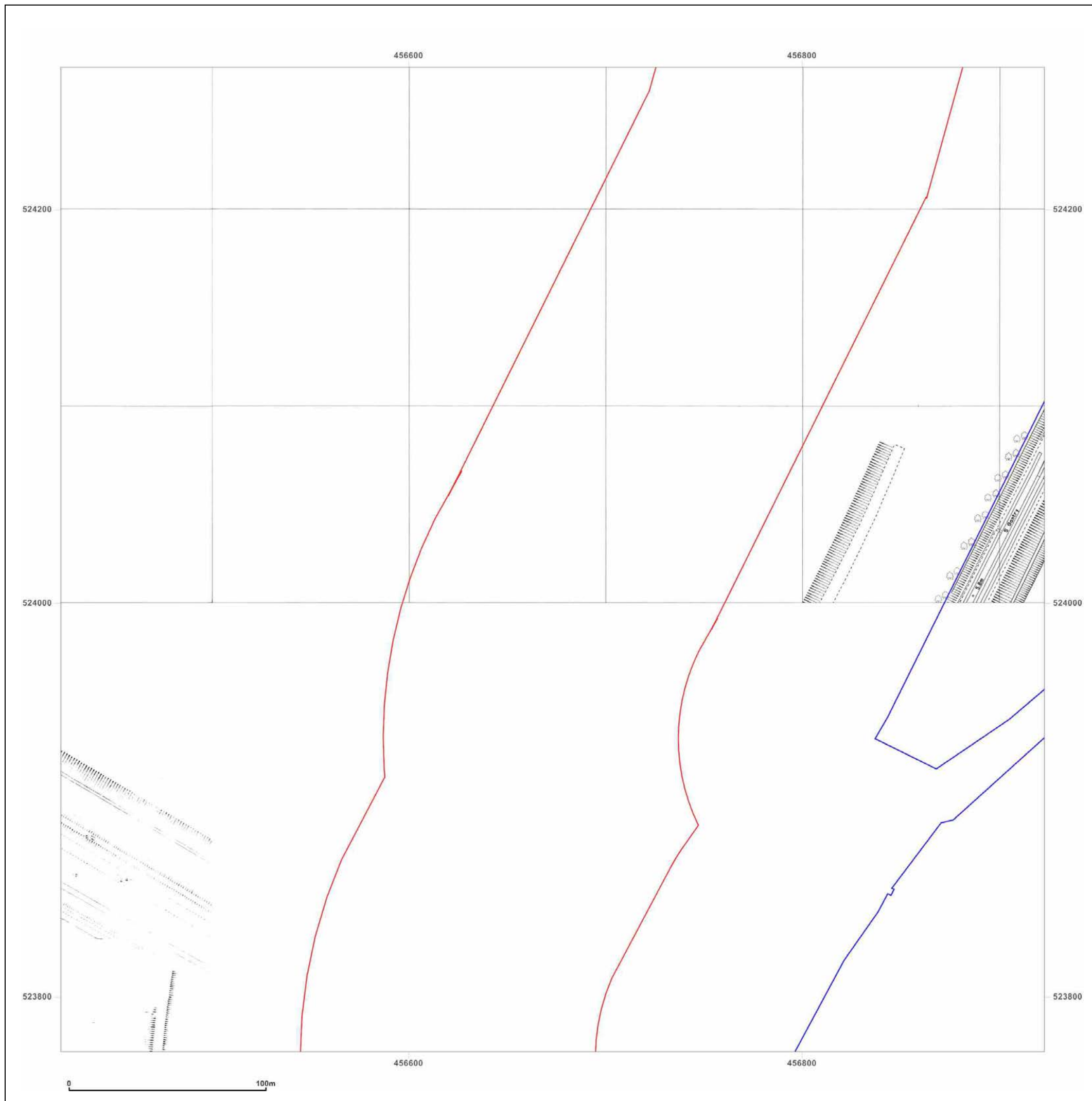
Produced by  
 Groundsure Insights  
[www.groundsure.com](http://www.groundsure.com)



Supplied by:  
[www.emapsite.com](http://www.emapsite.com)  
[sales@emapsite.com](mailto:sales@emapsite.com)

© Crown copyright and database rights 2019 Ordnance Survey 100035207

Production date: 10 June 2019

Map legend available at:  
[www.groundsure.com/sites/default/files/groundsure\\_legend.pdf](http://www.groundsure.com/sites/default/files/groundsure_legend.pdf)

## Site Details:

South Tees Development

**Client Ref:** EMS\_546959\_736022  
**Report Ref:** EMS-546959\_736022\_1250scale\_1\_2  
**Grid Ref:** 456673, 524022

**Map Name:** National Grid

**Map date:** 1976-1980

**Scale:** 1:1,250

**Printed at:** 1:2,000



Surveyed N/A  
Revised N/A  
Edition N/A  
Copyright N/A  
Levelled N/A

Surveyed 1959  
Revised 1980  
Edition N/A  
Copyright 1980  
Levelled 1959



Produced by  
Groundsure Insights  
[www.groundsure.com](http://www.groundsure.com)



Supplied by:  
[www.emapsite.com](http://www.emapsite.com)  
[sales@emapsite.com](mailto:sales@emapsite.com)

© Crown copyright and database rights 2019 Ordnance Survey 100035207

Production date: 10 June 2019

Map legend available at:  
[www.groundsure.com/sites/default/files/groundsure\\_legend.pdf](http://www.groundsure.com/sites/default/files/groundsure_legend.pdf)

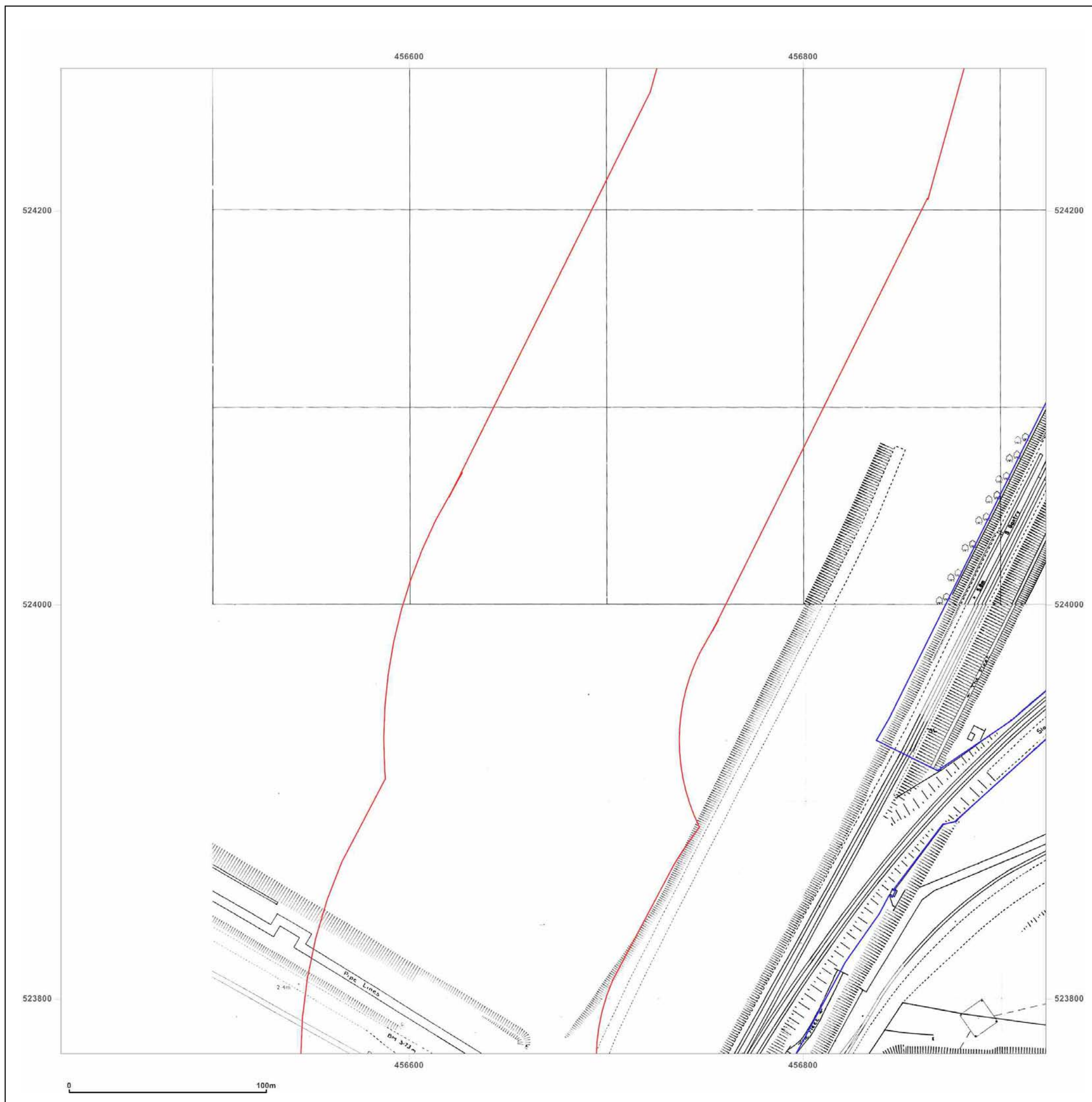

**Site Details:**

South Tees Development

**Client Ref:** EMS\_546959\_736022  
**Report Ref:** EMS-546959\_736022\_1250scale\_1\_2  
**Grid Ref:** 456673, 524022

**Map Name:** National Grid

**Map date:** 1984-1989

**Scale:** 1:1,250

**Printed at:** 1:2,000



Surveyed 1959  
 Revised 1984  
 Edition N/A  
 Copyright 1984  
 Levelled 1959

Surveyed 1952  
 Revised 1952  
 Edition N/A  
 Copyright 1989  
 Levelled 1975

Surveyed 1952  
 Revised 1973  
 Edition N/A  
 Copyright 1989  
 Levelled N/A



Produced by  
 Groundsure Insights  
[www.groundsure.com](http://www.groundsure.com)



Supplied by:  
[www.emapsite.com](http://www.emapsite.com)  
[sales@emapsite.com](mailto:sales@emapsite.com)

© Crown copyright and database rights 2019 Ordnance Survey 100035207

Production date: 10 June 2019

Map legend available at:  
[www.groundsure.com/sites/default/files/groundsure\\_legend.pdf](http://www.groundsure.com/sites/default/files/groundsure_legend.pdf)

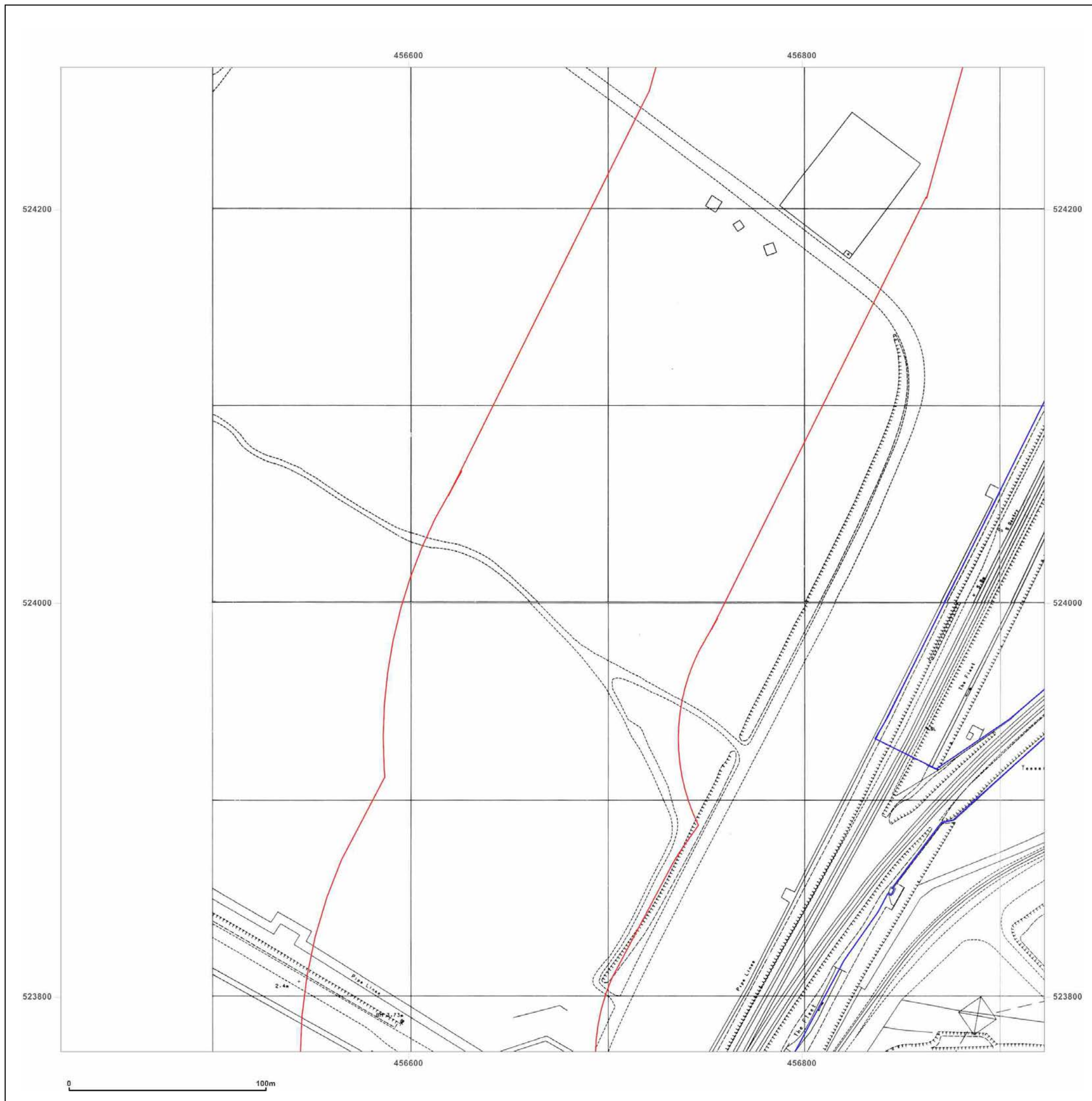

**Site Details:**

South Tees Development

**Client Ref:** EMS\_546959\_736022  
**Report Ref:** EMS-546959\_736022\_1250scale\_1\_2  
**Grid Ref:** 456673, 524022

**Map Name:** National Grid

**Map date:** 1989-1993

**Scale:** 1:1,250

**Printed at:** 1:2,000



Surveved N/A Revised N/A Edition N/A Copyright 1993 Levelled N/A	Surveved 1952 Revised 1975 Edition N/A Copyright 1989 Levelled N/A
Surveved 1992 Revised 1992 Edition N/A Copyright 1992 Levelled N/A	Surveved 1993 Revised 1993 Edition N/A Copyright N/A Levelled N/A

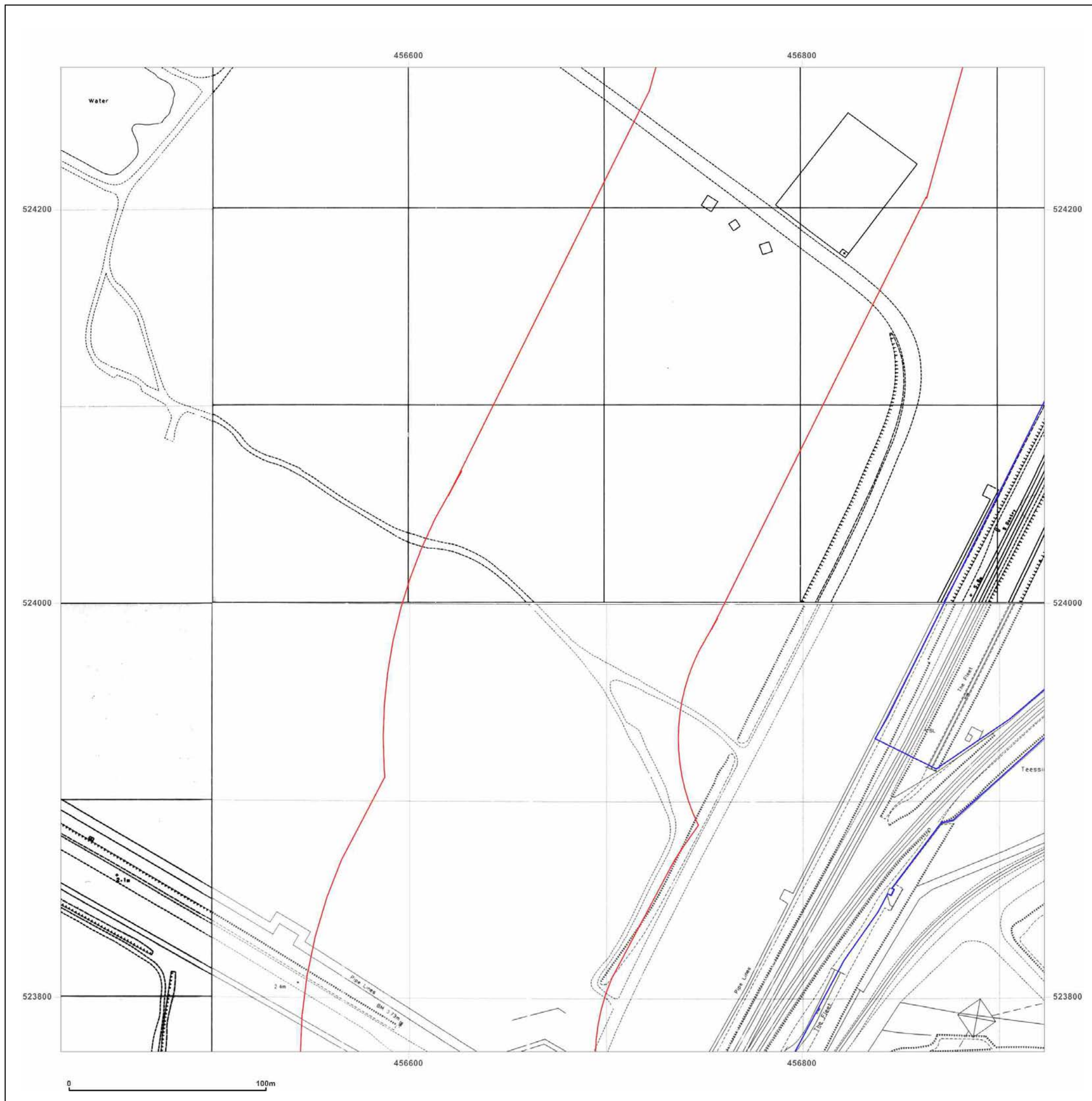

Produced by  
 Groundsure Insights  
[www.groundsure.com](http://www.groundsure.com)



Supplied by:  
[www.emapsite.com](http://www.emapsite.com)  
[sales@emapsite.com](mailto:sales@emapsite.com)

© Crown copyright and database rights 2019 Ordnance Survey 100035207

Production date: 10 June 2019

Map legend available at:  
[www.groundsure.com/sites/default/files/groundsure\\_legend.pdf](http://www.groundsure.com/sites/default/files/groundsure_legend.pdf)

## Site Details:

South Tees Development

**Client Ref:** EMS\_546959\_736022  
**Report Ref:** EMS-546959\_736022\_1250scale\_1\_2  
**Grid Ref:** 456673, 524022

**Map Name:** National Grid

**Map date:** 1993

**Scale:** 1:1,250

**Printed at:** 1:2,000



Surveyed N/A  
Revised N/A  
Edition N/A  
Copyright 1993  
Levelled N/A

Surveyed N/A  
Revised N/A  
Edition N/A  
Copyright 1993  
Levelled N/A



Produced by  
Groundsure Insights  
[www.groundsure.com](http://www.groundsure.com)



Supplied by:  
[www.emapsite.com](http://www.emapsite.com)  
[sales@emapsite.com](mailto:sales@emapsite.com)

© Crown copyright and database rights 2019 Ordnance Survey 100035207

Production date: 10 June 2019

Map legend available at:  
[www.groundsure.com/sites/default/files/groundsure\\_legend.pdf](http://www.groundsure.com/sites/default/files/groundsure_legend.pdf)

