

Do not scale from this drawing. Only figured dimensions are to be taken from this drawing. The contractor must verify all dimensions on site before commencing any work or shop drawings. If this drawing exceeds the quantities taken in any way, POD NEWCASTLE LTD is to be informed before the work is initiated. Ordnance Survey information is used on POD NEWCASTLE LTD drawings. POD NEWCASTLE LTD is not responsible for the accuracy of dimensions relating to any Ordnance Survey data, or beyond the boundary of the inserted topographic survey data. Work within The Construction (Design and Management) Regulations 2015 is not to start until a Health and Safety Plan has been produced. COPYRIGHT © POD NEWCASTLE LTD. This drawing is Copyright and must not be reproduced in any form or media without written consent of POD NEWCASTLE LTD.

REV BY DATE NOTE

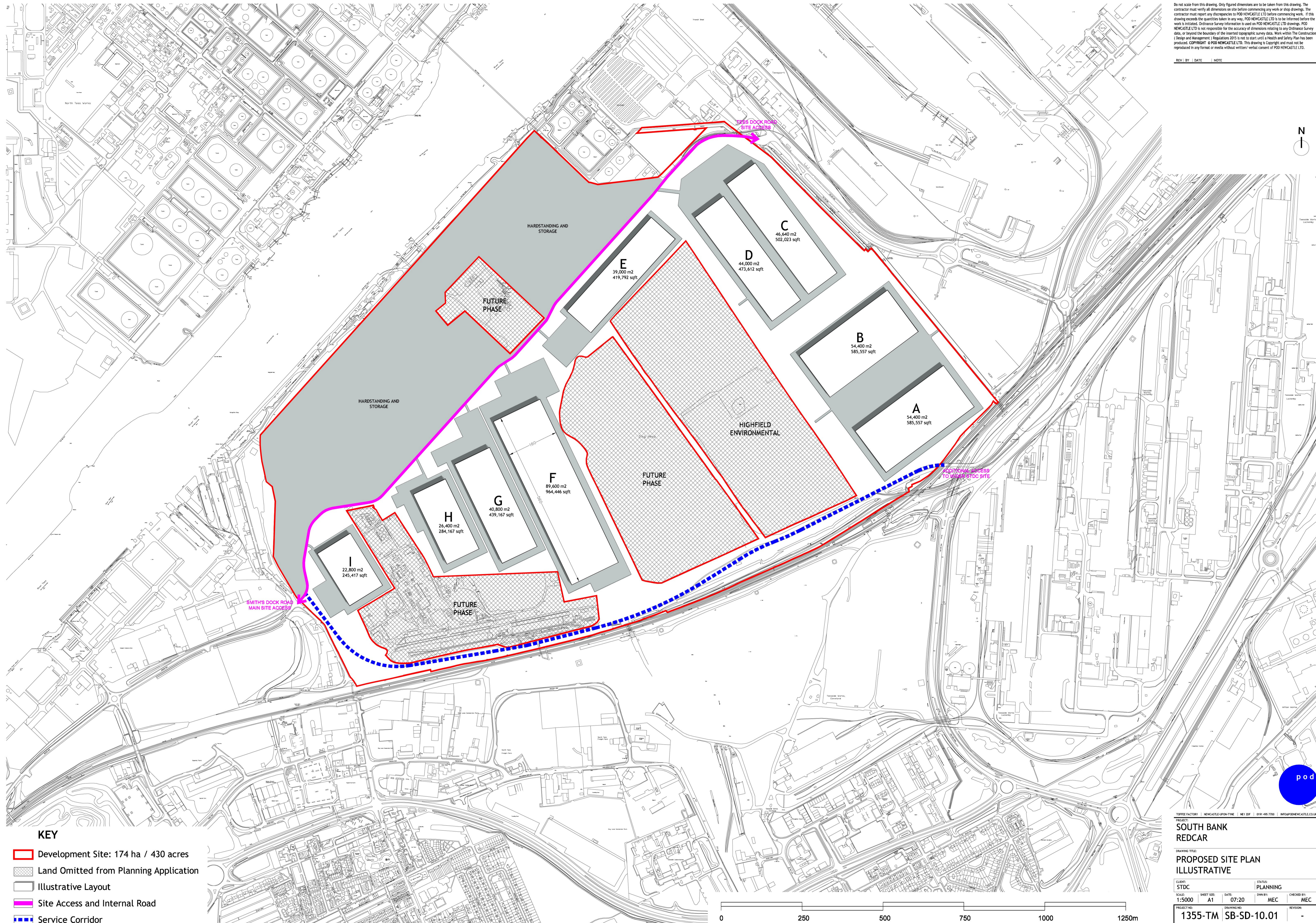

**KEY**

- Development Site: 174 ha / 430 acres
- Land Omitted from Planning Application
- Illustrative Layout
- Site Access and Internal Road
- Service Corridor

TOFFEE FACTORY | NEWCASTLE-UPON-TYNE | NE1 2PF | 0191 485 7700 | INFO@PODNEWCASTLE.CO.UK

**SOUTH BANK REDCAR**

DRAWING TITLE:  
**PROPOSED SITE PLAN ILLUSTRATIVE**

CLIENT: STDG	STATUS: PLANNING
SCALE: 1:5000	SHEET SIZE: A1
DATE: 07:20	DRAWN BY: MEC
CHECKED BY: MEC	REVISION: -

PROJECT NO: 1355-TM | DRAWING NO: SB-SD-10.01