

DO NOT SCALE

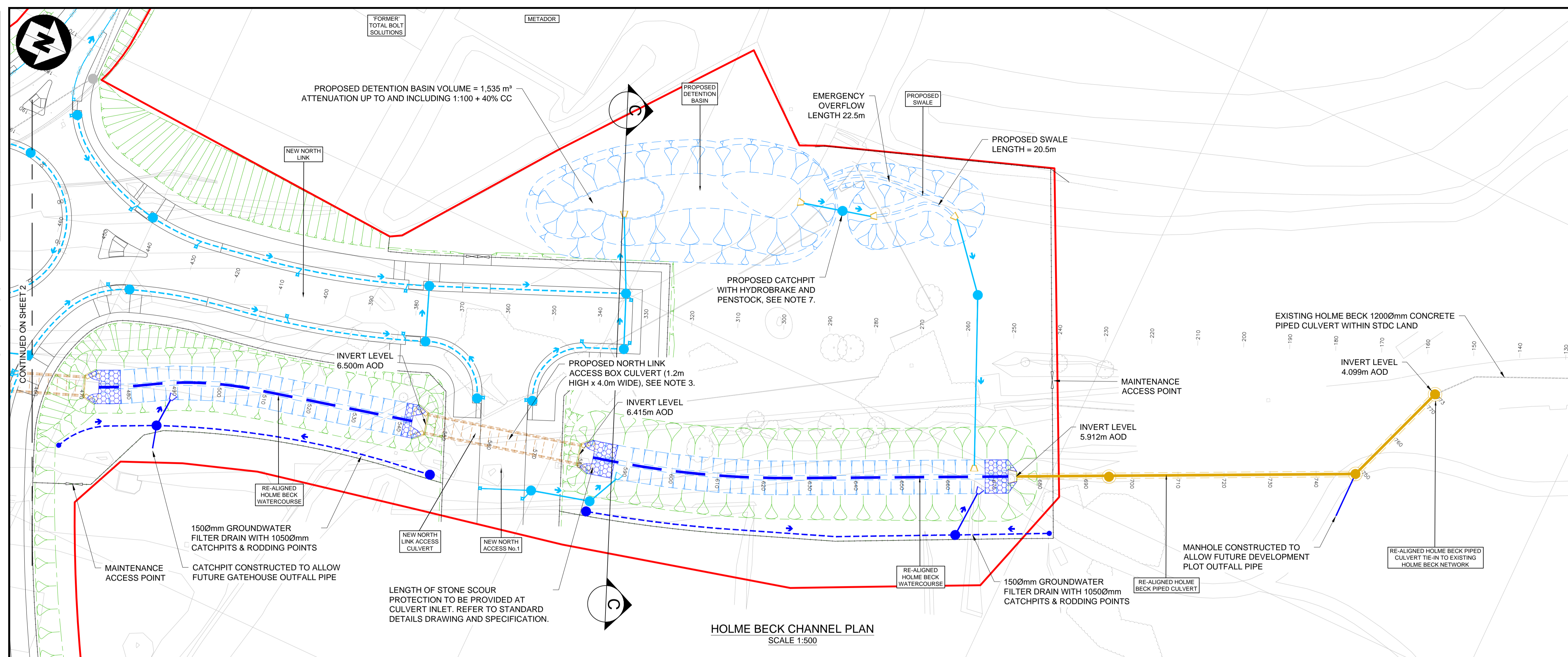

HOLME BECK CHANNEL PLAN
SCALE 1:500

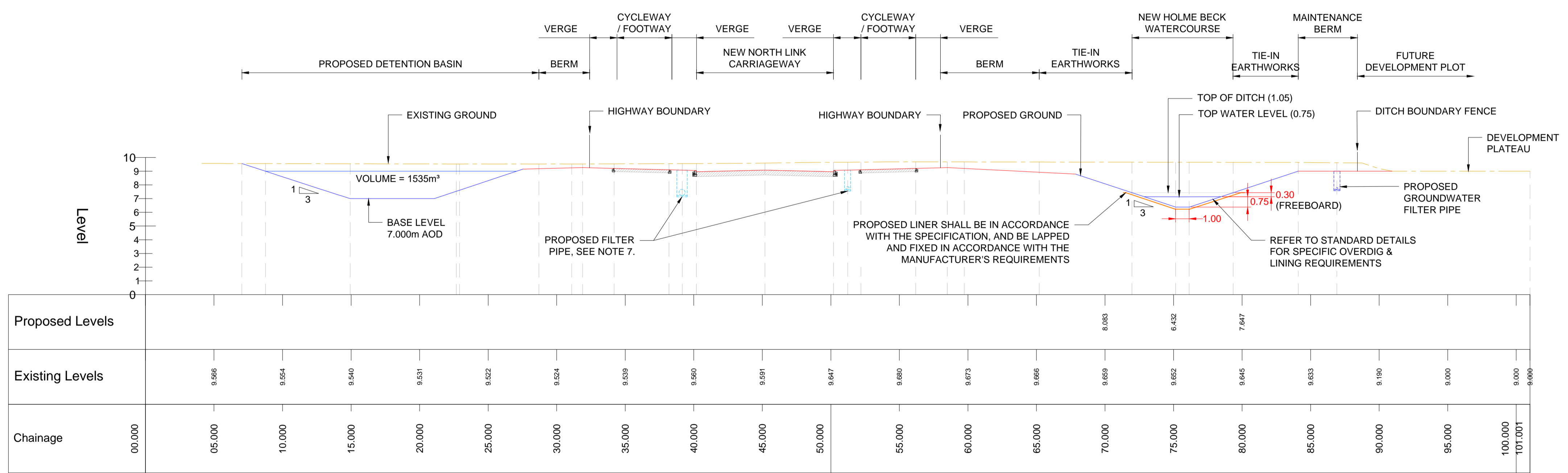

TYPICAL CROSS SECTION C-C
SCALE 1:200

- GENERAL NOTES:
- THIS DRAWING SHALL BE READ IN CONJUNCTION WITH THE SPECIFICATION AND DRAINAGE SCHEDULE. SHOULD DISCREPANCIES BE IDENTIFIED ON THE CONTRACT DRAWINGS THE DESIGN ENGINEER SHOULD BE INFORMED PRIOR TO CONSTRUCTION WORKS TAKING PLACE.
 - ALL DIMENSIONS ARE IN METRES UNLESS OTHERWISE STATED.
 - FOR CULVERT AND HEADWALL INFORMATION, REFER TO DRAWING STDC_HWY-ATK-SBR-PR_CN-SK-CB-000001 & STDC_HWY-ATK-SBR-PR_CN-SK-CB-000002. THESE DRAWINGS ARE CONCEPTUAL AND ARE SUBJECT TO CONTRACTOR DETAILED DESIGN.
 - TO BE READ IN CONJUNCTION WITH MCHW 'F' SERIES FOR CATCHPIT & FILTER PIPE STANDARD DETAILS.
 - FOR MAINTENANCE ACCESS GATES & FENCE LINES ALONG HOLME BECK WATERCOURSE, REFER TO FENCING DRAWING SERIES STDC_HWY-ATK-HFE-PR-DR-CH-000001 TO 000010.
 - EXISTING HOLME BECK PIPED ROUTE INDICATIVE, TO BE CONFIRMED ON SITE DURING REMEDIATION WORKS.
 - FOR HIGHWAY DRAINAGE NETWORK DETAILS REFER TO DRAWINGS STDC_HWY-ATK-HDG-PR-DR-CD-000001 TO 000010.

- KEY:
- PLANNING APPLICATION RED LINE BOUNDARY
 - EXISTING HOLME BECK DITCH CENTRE LINE
 - EXISTING DRAINAGE SYSTEM
 - PROPOSED HOLME BECK DITCH CENTRE LINE
 - SCOUR PROTECTION AT HEADWALL LOCATIONS
 - PROPOSED GROUNDWATER FILTER DRAIN (TYPE H 150mmØ) WITH CATCHPIT (TYPE 7, 1050mmØ) AND RODDING POINTS
 - PROPOSED HOLME BECK PIPED CULVERT (1200mmØ), 3mØ MANHOLES & ALTHON H20CC INLET & OUTLET HEADWALLS
 - PROPOSED HIGHWAY DRAINAGE SYSTEM (CARRIER & FILTER), GULLY & LEADS, CATCHPITS, KERB DRAIN & ALTHON HGCA HEADWALLS
 - PROPOSED BOUNDARY FENCE & MAINTENANCE ACCESS GATES (SEE NOTE 5)

SAFETY, HEALTH AND ENVIRONMENTAL INFORMATION

In addition to the hazards/risks normally associated with the types of work detailed on this drawing, note the following significant residual risks (Reference shall also be made to the design hazard log).

Construction
HS/DRN/001 - EXISTING UTILITY APPARATUS
HS/DRN/002 - POTENTIAL CONTAMINATED EXCAVATIONS
HS/DRN/003 - ADJACENT POTENTIALLY DEEP WATER AREAS
Maintenance / Cleaning
NONE
Use
NONE
Decommissioning / Demolition
NONE

Description	Status	Revision	Drawn	Checked	Reviewed	Authorised	Issue Date
FOR AGREEMENT	S3	P01	CE	J R	AF	---	07/12/20
ISSUED FOR REVIEW AND COMMENT	S3	P02	CE	J R	MT	---	06/02/21
ISSUED FOR PLANNING	A1	C01	MT	J R	AF	DS	17/03/21

APPROVED - PUBLISHED A1

ATKINS
Member of the SNC-Lavalin Group
Dunedin House
Columbia Drive
Stockton-on-Tees
Cleveland
TS17 6BJ
Tel: +44 (0)1642 525200
Copyright © Atkins Limited (2021) www.atkinsglobal.com

Client
STDC
Teesside Management Offices,
Redcar, TS10 5QW
www.southteesdc.com
South Tees Development Corporation

Project Title
SOUTH TEES DEVELOPMENT CORPORATION
Drawing Title
DETAILED DESIGN of ESTON ROAD HIGHWAYS SCHEME SUDS AND RIVER RESTORATION PLAN & SECTION 3 OF 3

Drawing Number	Project	Originator	Volume
STDC_HWY - ATK - HDG - PR_XS - DR - CD - 000003			
Location	Type	Role	Number
A1	Scale AS SHOWN	Project Ref. No. 5198022	Sheet: 3 of 3
Original Scale: A1	Scale AS SHOWN	Project Ref. No. 5198022	Sheet: 3 of 3

This map is based on Ordnance Survey material with the permission of Ordnance Survey on behalf of the Controller of Her Majesty's Stationery Office. © Crown copyright. Unauthorised reproduction infringes Crown copyright and may lead to prosecution or civil proceedings. STDC 0100000023, 2021.

