

DO NOT SCALE

100
0 10
Millimetres

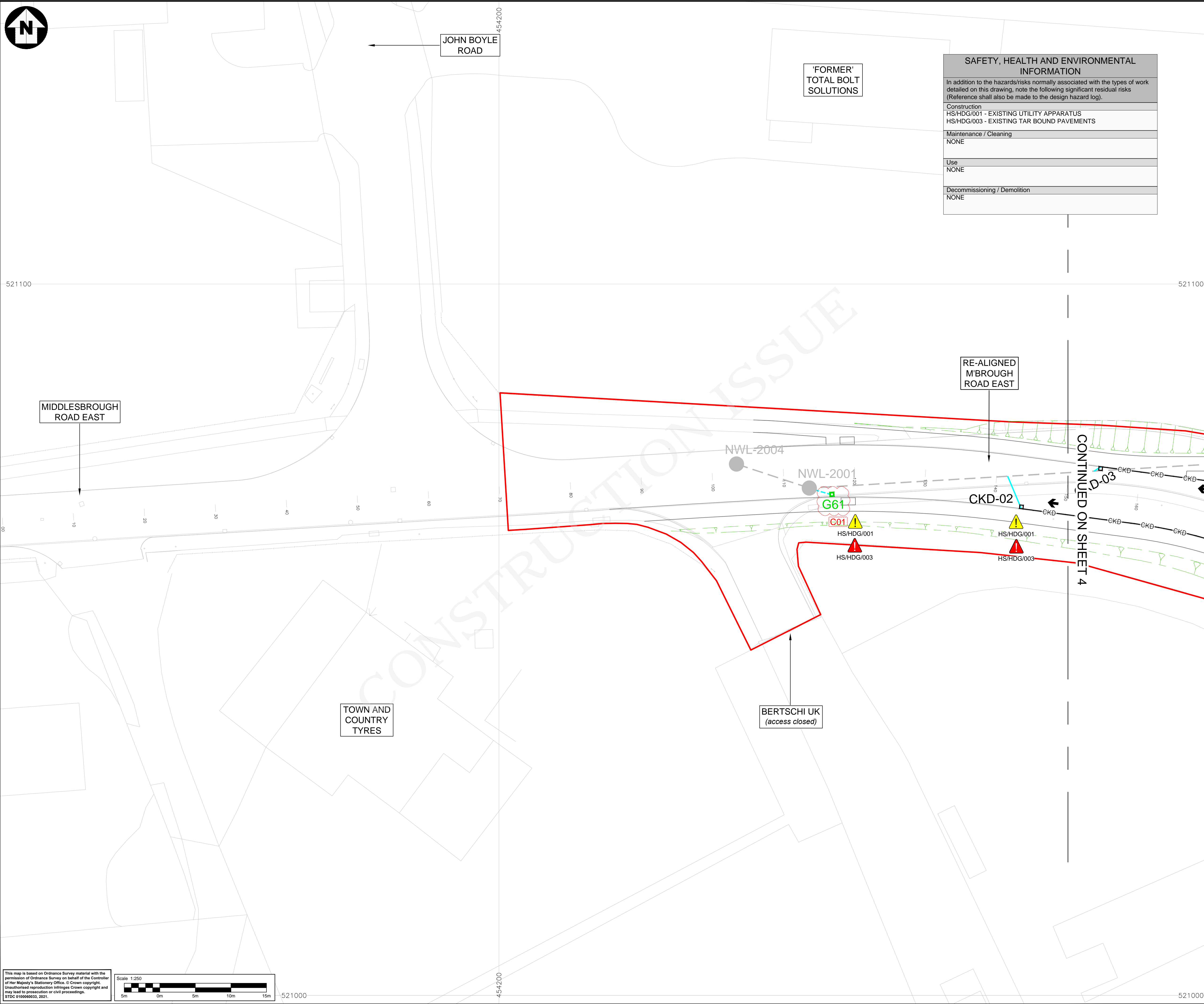

SAFETY, HEALTH AND ENVIRONMENTAL INFORMATION	
In addition to the hazards/risks normally associated with the types of work detailed on this drawing, note the following significant residual risks (Reference shall also be made to the design hazard log).	
Construction	HS/HDG/001 - EXISTING UTILITY APPARATUS HS/HDG/003 - EXISTING TAR BOUND PAVEMENTS
Maintenance / Cleaning	NONE
Use	NONE
Decommissioning / Demolition	NONE

- NOTES:**
- DO NOT SCALE FROM THIS DRAWING.
 - ALL PIPE DIAMETERS ARE IN MM.
 - FOR KEY & GENERAL SCHEME NOTES, REFER TO STDC_HWY-ATK-HDG-PR-DR-CD-000001
 - ALL CHAMBERS TO BE TYPE 7 CATCHPITS TO HCD F11.
 - ALL GULLIES TO BE TRAPPED TO HCD F13.
 - UTILITY ROUTES SHOWN ARE INDICATIVE - PLEASE REFER TO PUBLIC UTILITIES DRAWING SERIES 'VUT' TO IDENTIFY ANY APPARATUS SHOWN ON THIS DRAWING.
 - DRAINAGE HAS BEEN DESIGNED TO HIGHWAYS ALIGNMENT DESIGN MODEL 'P09'.
 - REFER TO DESIGN RISK REGISTER FOR RESIDUAL HEALTH & SAFETY RISKS.
 - FOR DETAILS OF BOX CULVERTS REFER TO DRAWINGS: STDC_HWY-ATK-SBR-PR_CN-SK-CB-000001 AND STDC_HWY-ATK-SBR-PR_CN-SK-CB-000002.
 - ALL DIMENSIONS ARE INDICATIVE AND ARE TO BE CONFIRMED PRIOR TO CONSTRUCTION ISSUE.
 - BOX CULVERT SECTION IS BASED UPON AGREED LEAD LOCAL FLOOD AUTHORITY (RCBC) AGREED DIMENSIONS.
 - CULVERT HEADWALL (INLET & OUTLET) ARRANGEMENT TO BE DETERMINED AS CONTRACTOR DESIGNED. ALLOWANCE SHOULD BE MADE FOR GRADIENT OF WATERCOURSE EARTHWORKS TIE-INS AS SHOWN.
 - DETAILED DESIGN MAY CHANGE PARAMETERS. CONFIRMATION OF LEVELS TO BE PROVIDED UPON COMPLETION OF EXISTING DRAINAGE SURVEYS AND SUBSEQUENT DESIGN OF THE PROPOSED HOLME BECK WATERCOURSE.
 - ALL STRUCTURE WORKS TO BE IN ACCORDANCE WITH DESIGN MANUAL FOR ROADS AND BRIDGES AND ADHERE TO TEES VALLEY DESIGN GUIDE.
 - FOR HOLME BECK WATERCOURSE INFORMATION & GROUNDWATER FILTER PIPES, REFER TO DRAWING SERIES: STDC_HWY-ATK-HDG-PR_XS-DR-CD-000001 TO 000003.
 - ALL EXISTING GULLIES SHOWN TO BE REPLACED SHALL REQUIRE EXISTING GULLY CONNECTION PIPES TO BE ASSESSED FOR CONDITION PRIOR TO CONSTRUCTION.

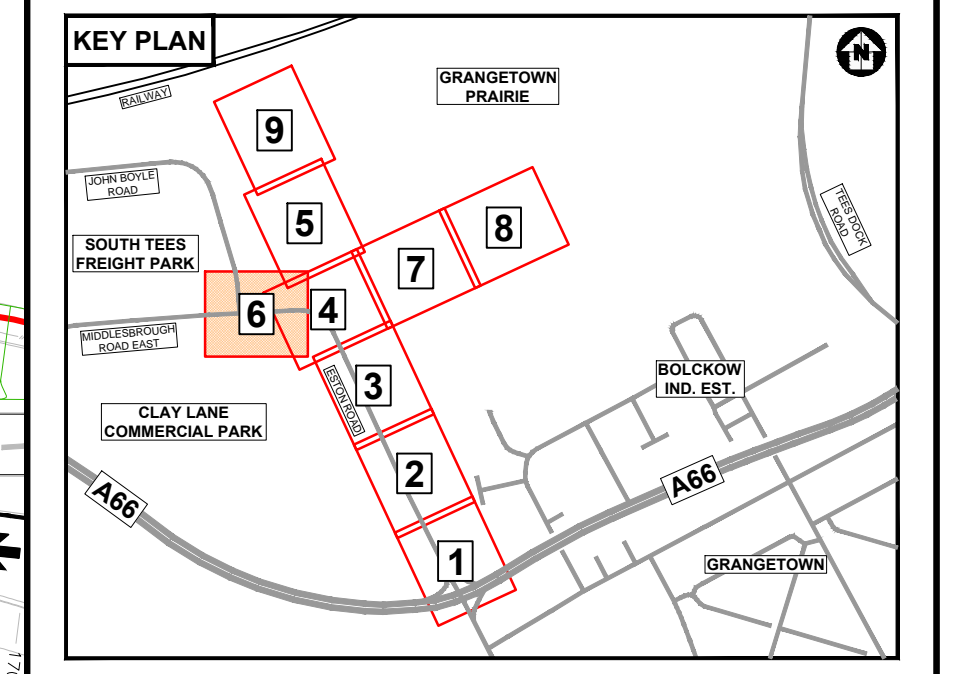

Description	Status	Revision	Drawn	Checked	Reviewed	Authorised	Issue Date
FOR AGREEMENT	S3	P01	CE	J R	AF	---	07/12/20
ISSUED FOR REVIEW AND COMMENT	S3	P02	CE	J R	MT	---	06/02/21
UPDATED FOR DESIGN CHANGES FOR CONSTRUCTION ISSUE	A3	CO1	MT	DS	DMA	DS	21/05/21

APPROVED - CONSTRUCTION A3

ATKINS
 Member of the SNC-Lavalin Group
 DUNEDIN HOUSE
 COLUMBIA DRIVE
 STOCKTON-ON-TEES
 CLEVELAND
 TS17 6BJ
 Tel: +44 (0)1642 525200
 Copyright © Atkins Limited (2021) www.atkinsglobal.com

TEESWORKS
 The UK's largest industrial zone

Client: SOUTH TEES DEVELOPMENT CORPORATION

Drawing Title: DETAILED DESIGN of ESTON ROAD HIGHWAYS SCHEME PROPOSED DRAINAGE LAYOUT SHEET 6 OF 9

Project	STDC_HWY - ATK - HDG - PR - DR - CD - 000007
Location	
Original Size	A1
Scale	1:250
Project Ref. No.	5198022
Sheet	6 of 9
Rev.	C01

This map is based on Ordnance Survey material with the permission of Ordnance Survey on behalf of the Controller of Her Majesty's Stationery Office. © Crown copyright. Unauthorised reproduction infringes Crown copyright and may lead to prosecution or civil proceedings. STDC 19/06/2021, 2021.
 Scale 1:250
 5m 0m 5m 10m 15m