

- DO NOT SCALE -

This map is based on Ordnance Survey material with the permission of Ordnance Survey on behalf of the Controller of Her Majesty's Stationery Office. © Crown copyright. Unauthorised reproduction infringes Crown copyright and may lead to prosecution or civil proceedings. STDC 10006033 2021.

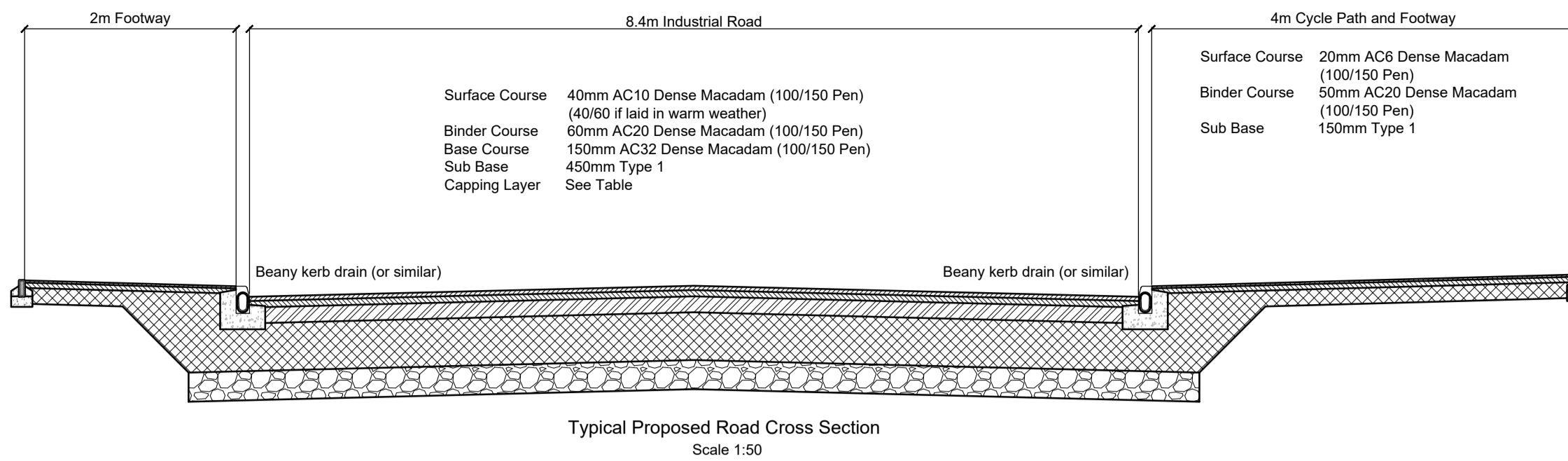

Notes:

Road and footpath surfaces are to meet architects specification.

- All works and materials to be in accordance with;
 - Tees Valley current design standards
 - New Road and Streetworks Act. 1991
 - BGP Specifications
 - All applicable Building regulations
- All levels are in metres to Ordnance Datum (m AOD).
- The contractor is to check all dimensions and levels and report any discrepancies or omissions to the Engineer.
- This drawing is to be read only in conjunction with BGP specification and drawings.
- All concrete for foundation to kerb channels and edgings shall be Class Gen3 (BS 5328) unless shown otherwise.
- All kerbs and channels shall be hydraulically pressed and comply in all respects with BS 7263 Part 1.
- Kerbs and channels shall be laid true to line and level and shall not be backed until inspected and approved by the Engineer.
- For softscape areas refer to Architects specification & details.

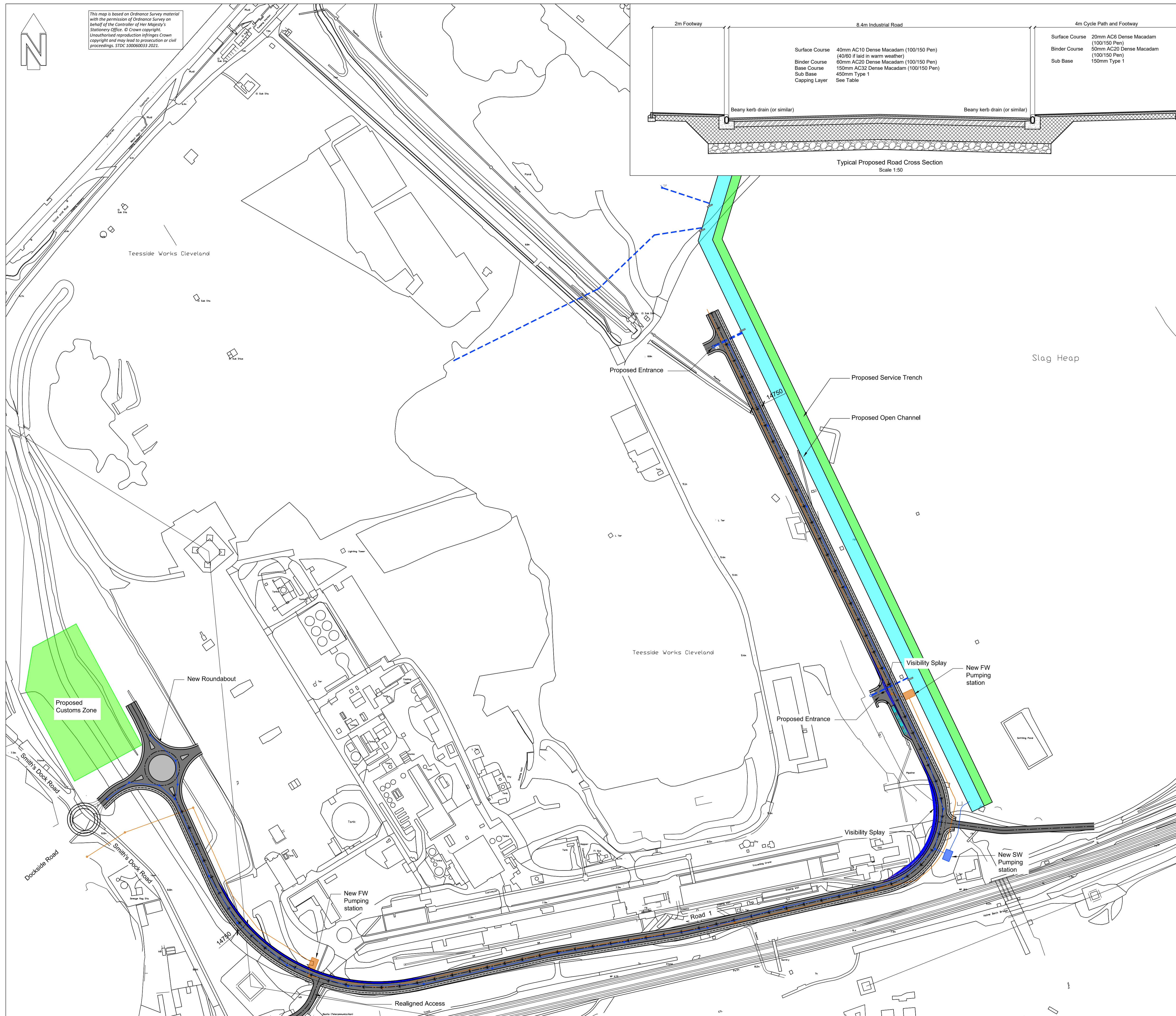

Issued for Planning	TC	P05	JC	07.10.2021
Issued for Planning	TC	P04	JC	17.08.2021
Updated following comment	TC	P03	JC	29.07.2021
Updated following comment	TC	P02	JC	06.07.2021
Issued for Information	TC	P01	JC	24.06.2021
AMENDMENT	BY	REV	CHK	DATE

Rev P = Preliminary T = Tender C = Construction LCI = Last Construction Issue

In instances where this drawing completes or partly completes a contract, Billingham George & Partners will consider that it's product has been validated, unless in a period not exceeding 90 working days, the client advises to the contrary.



Billingham George & Partners
 CIVIL & STRUCTURAL ENGINEERS | BUILDING SURVEYORS
 1st Floor, Wellington House, Wellington Court, Stockton-on-Tees, TS18 3TA
 T 01642 876 470 @BGPconsulting E consulting@bgbp-teesside.co.uk W www.bgp-consulting.co.uk

Client LMUK		Project No. 21T2064	
Project New Access Road - South Bank			
Drawing Title Highway proposals			
Drawn TC	Date June 21	Checked JC	Date June 21
Size A1	Scale 1:2000	Class. 90.4	Rev. P05
Location LMUK	Originator BGP	Volume 00	Level ZZ
Type DR	Role C	Unique No. 00001	
File Reference LMUK-BGP-00-ZZ-DR-C-90.4-00001			