

DO NOT SCALE

ROUNDABOUT ENTRY / EXIT (NORTH SIDE) - NEW NORTH LINK

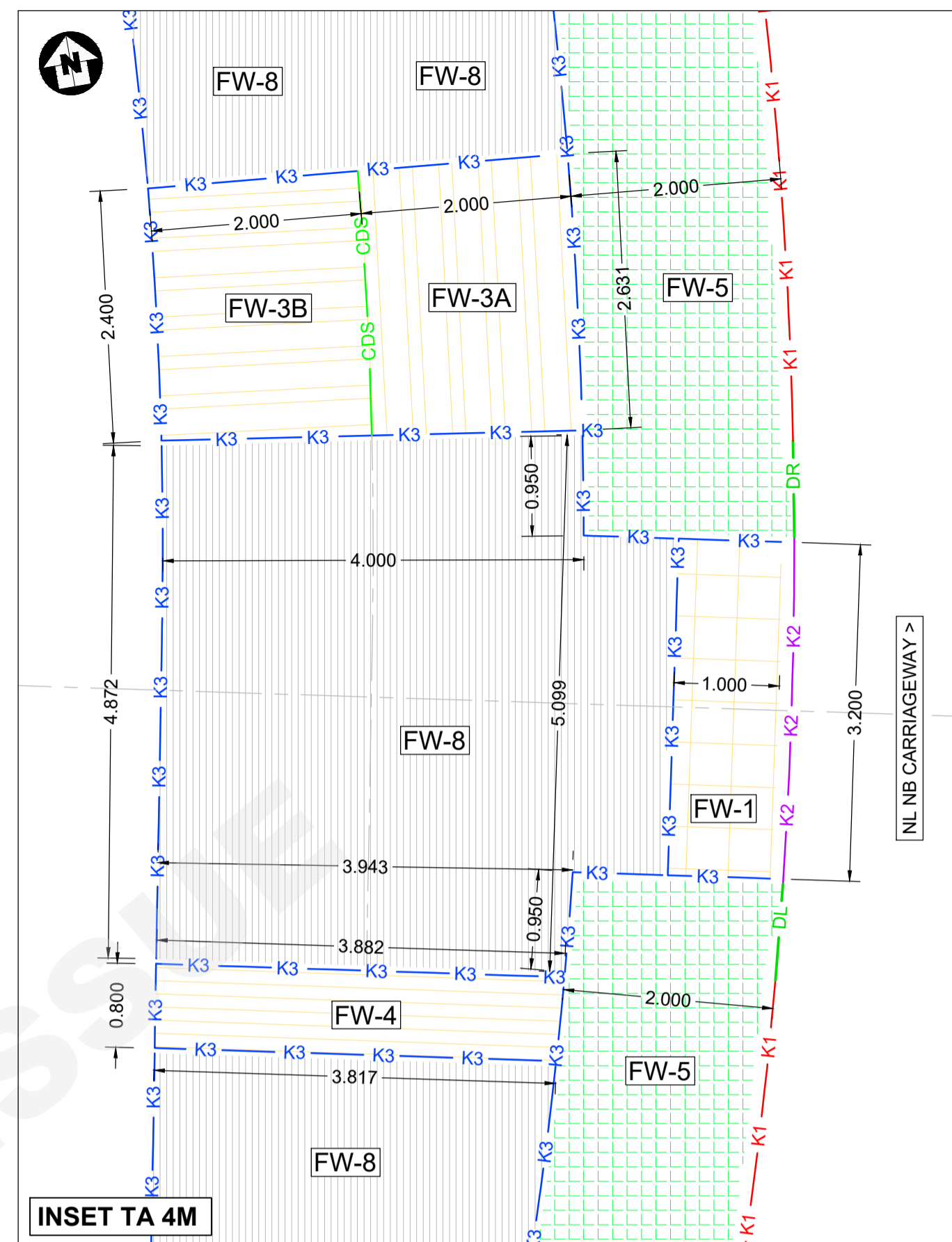
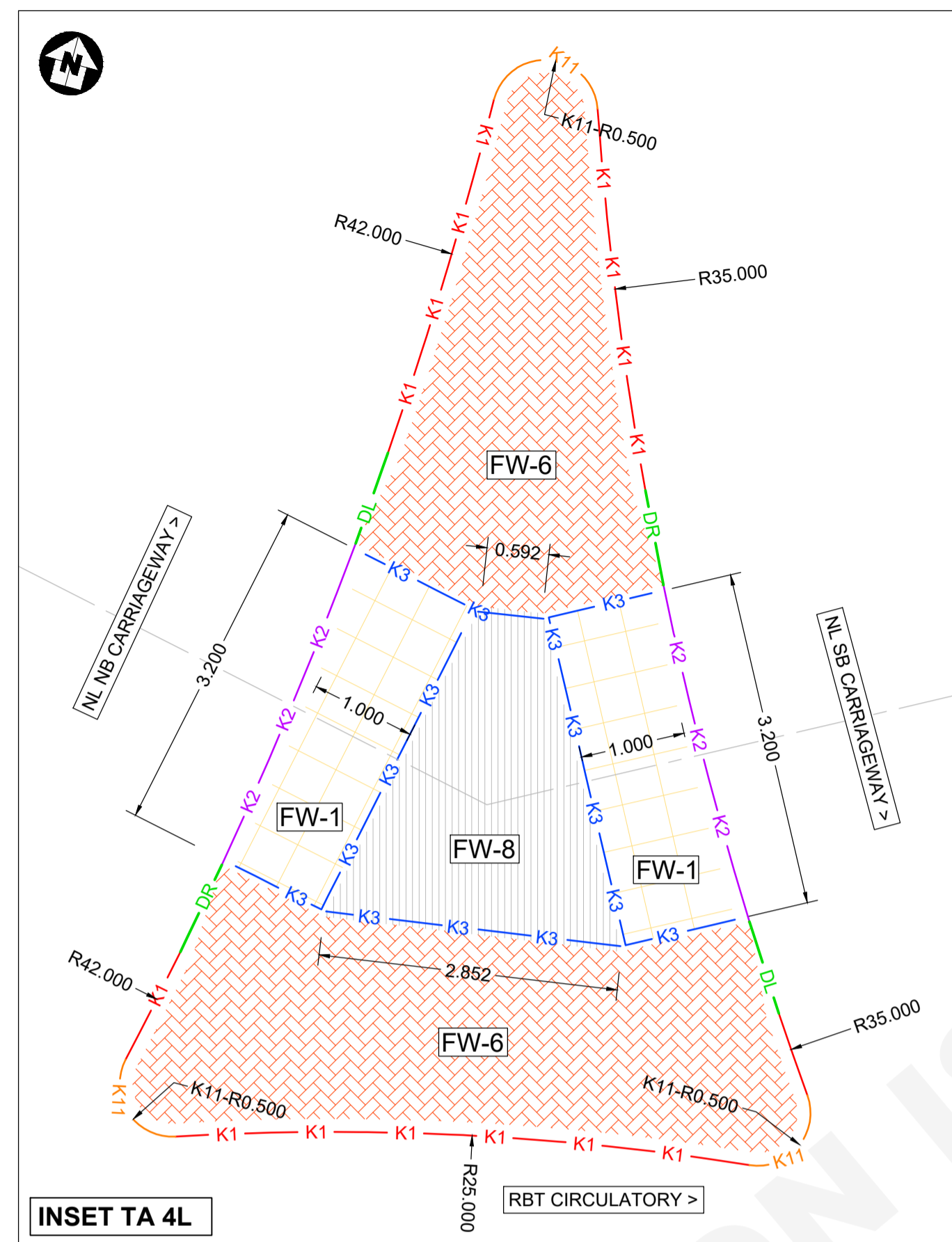
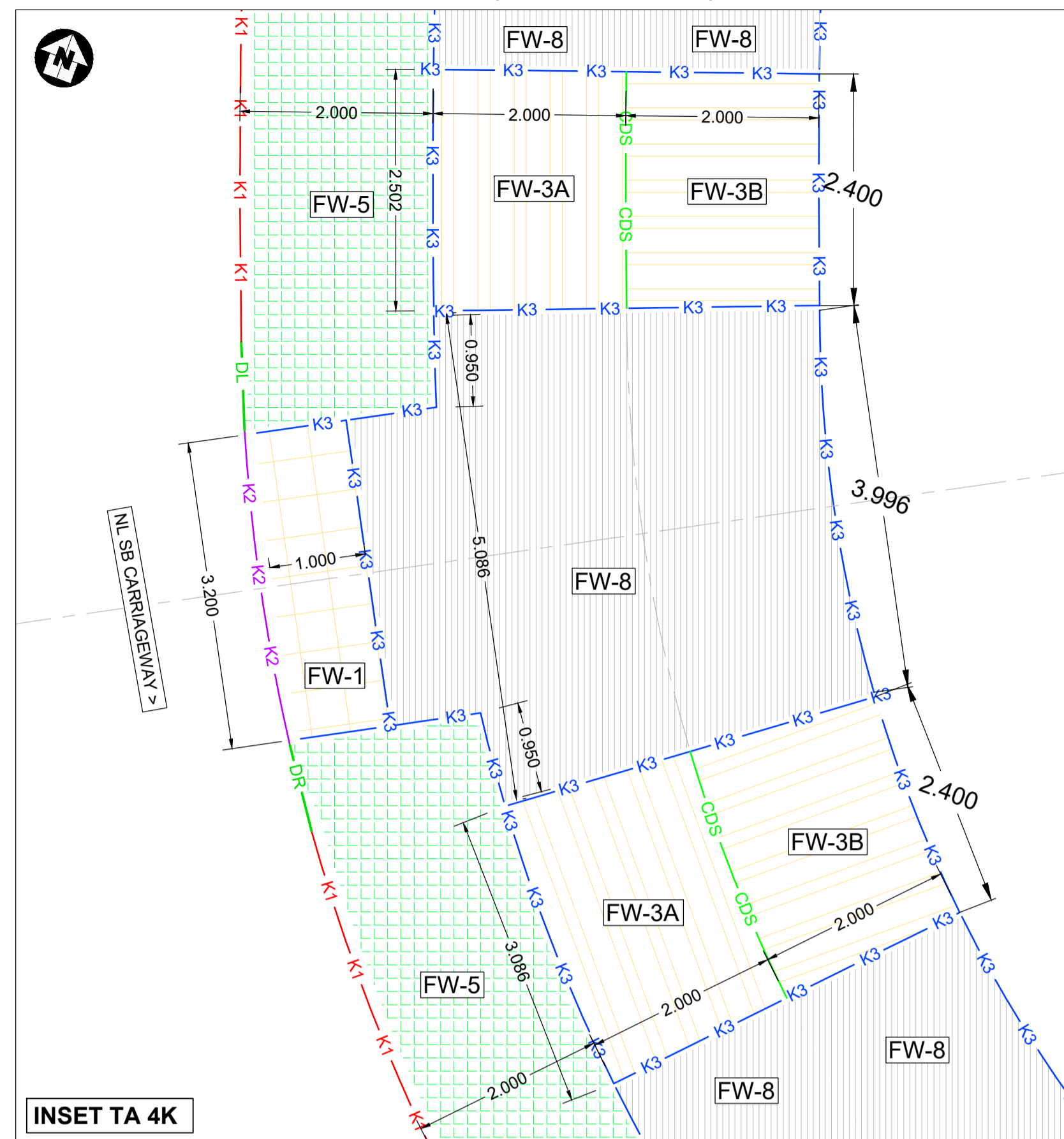

- NOTES:**
- FOR KERBING & FOOTWAY DETAILED KEY & NOTES REFER TO DRAWING: STDC\_HWY-ATK-HKF-PR-DR-CH-000001.
  - FOR TACTILE AND MAINTENANCE ACCESS INSETS REFER TO DRAWINGS: STDC\_HWY-ATK-HKF-PR-DE-CH-000001 TO 000005.
  - FOR STANDARD CONSTRUCTION DETAILS REFER TO DRAWINGS: STDC\_HWY-ATK-HKF-PR-DE-CH-000006 TO 000007.

- KEY:**
- TACTILE (TA) & MAINTENANCE ACCESS (MA) INSETS
  - FW-1 BLISTER TACTILE PAVING (CROSSING POINTS)
  - FW-2 BARFACED TACTILE PAVING (BUS STOPS)
  - FW-3A & FW-3B CYCLEWAY TACTILE PAVING
  - FW-4 HAZARD WARNING (CORDUROY) TACTILE PAVING
  - FW-5 ANTI-PEDESTRIAN PAVING
  - FW-6 BLOCK PAVING
  - FW-7 ITEM REMOVED
  - FW-8 FOOTWAY / CYCLEWAY SURFACING
  - FW-9A / 9B EXISTING FOOTWAY RE-SURFACED
  - FW-10 GRASSCRETE (OR SIMILAR) SURFACING
  - EXISTING FOOTWAY SURFACE (REMAINS AS IS)
  - EXISTING KERB / EXISTING CHANNEL BLOCK
  - K1 / K11 HALF BATTER2 KERB (>12m or <=12m radius)
  - K2 / K12 BULL NOSE KERB (>12m or <=12m radius)
  - K3 / K13 FLAT TOP EDGING KERB (>12m or <=12m radius)
  - K4 CHANNEL BLOCK (>12m Rad.)
  - K5 SPLAY KERB (>12m Rad.)
  - CDS CYCLEWAY END DELINEATOR STRIP
  - DL / DR HALF BATTER2 TO BULL NOSE DROP KERBS (left & right, >12m radius & <=12m radius)
  - TL / TR HALF BATTER2 TO SPLAY KERB TRANSITIONS
  - KK KASSEL KERB (OR SIMILAR)
  - KTL / KTR KASSEL TO HALF BATTER2 KERB TRANSITIONS
- WHERE COMBINED KERB DRAINS (KD) ARE USED (REFER TO DRAINAGE DRAWINGS), PROFILE TO MATCH TYPES K1, K2, DL, DR.

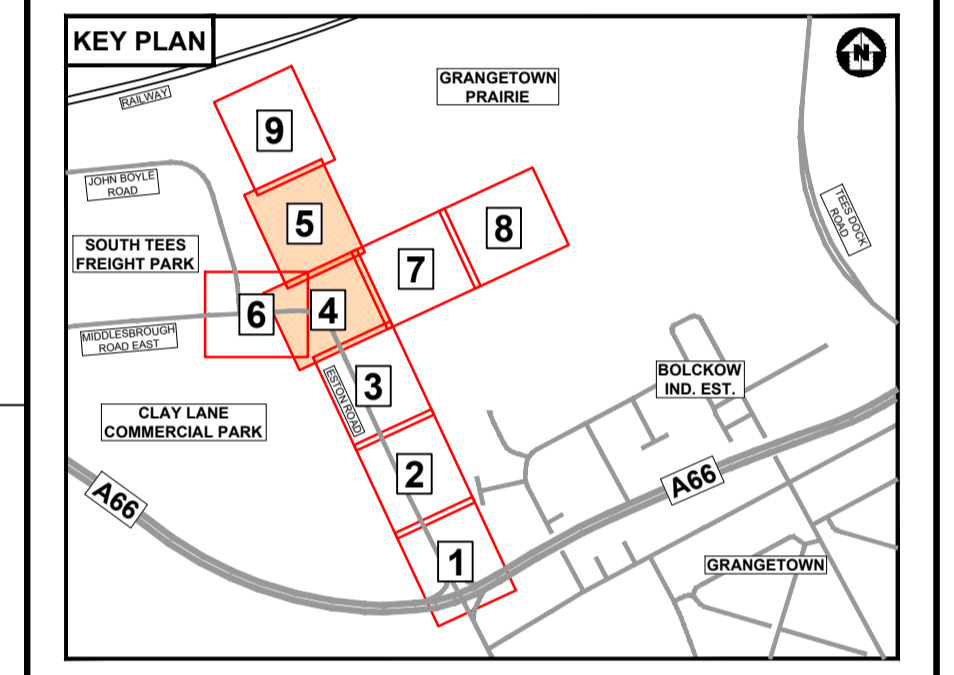

NEW NORTH LINK / ACCESS No.1

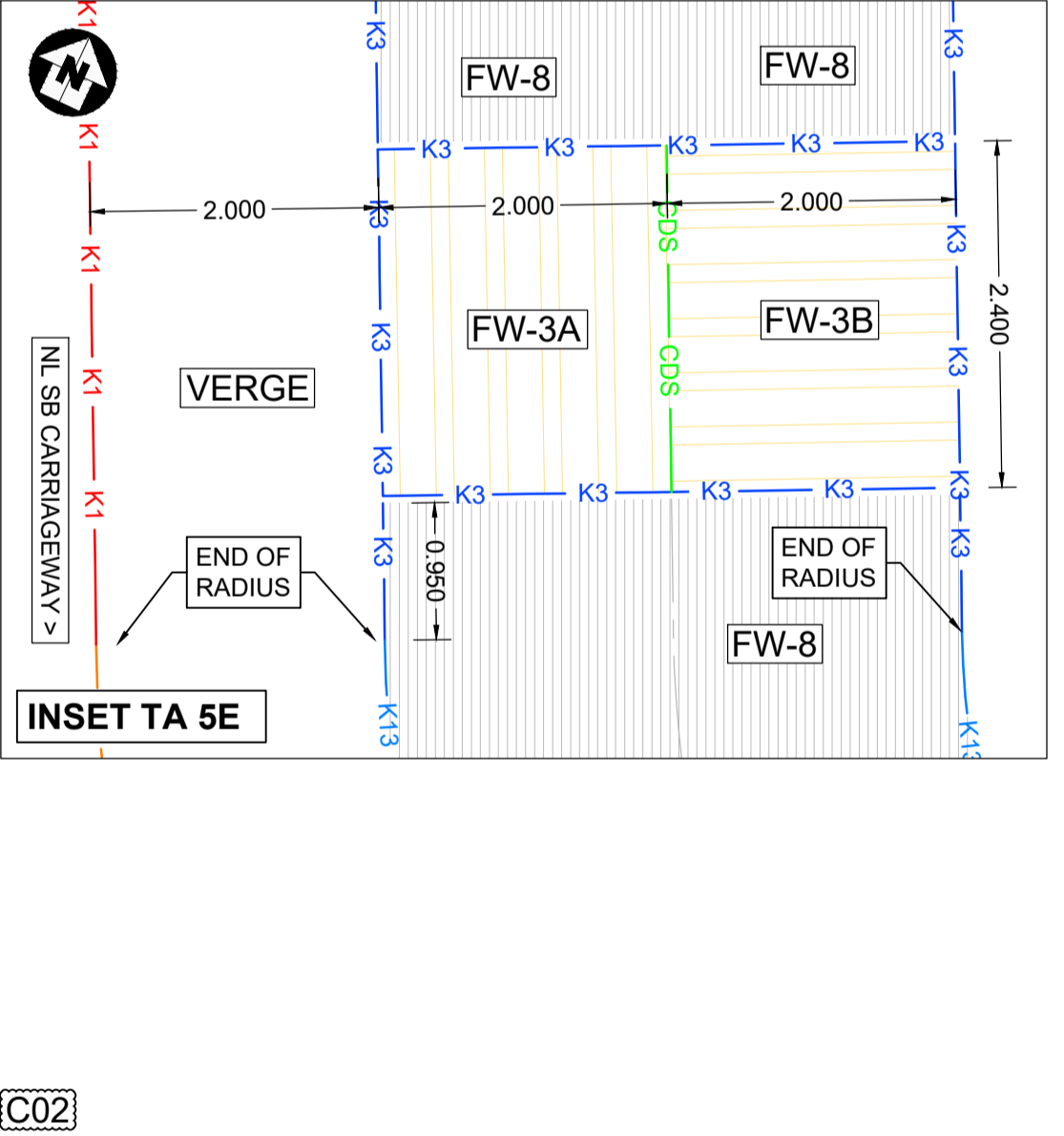
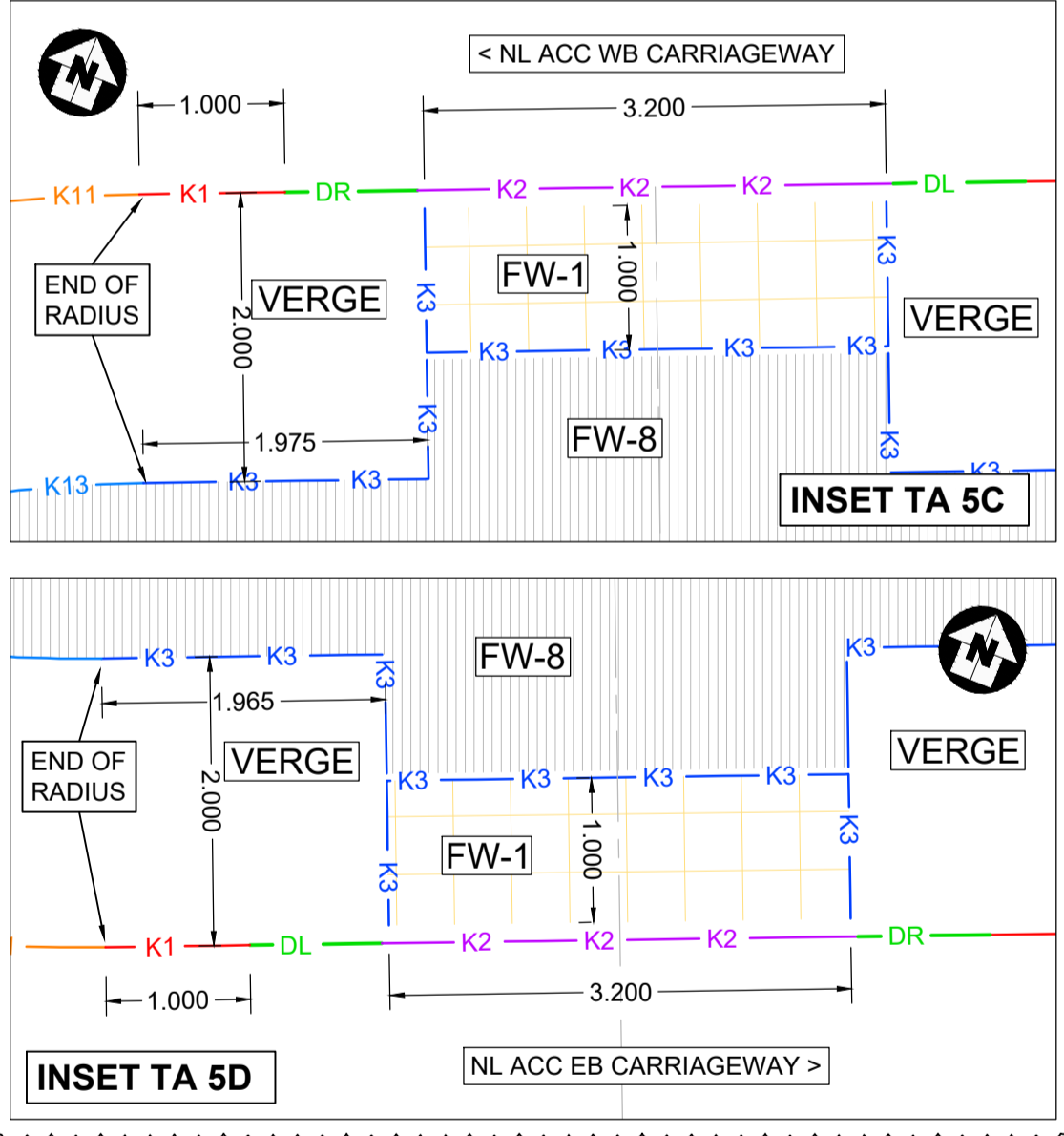
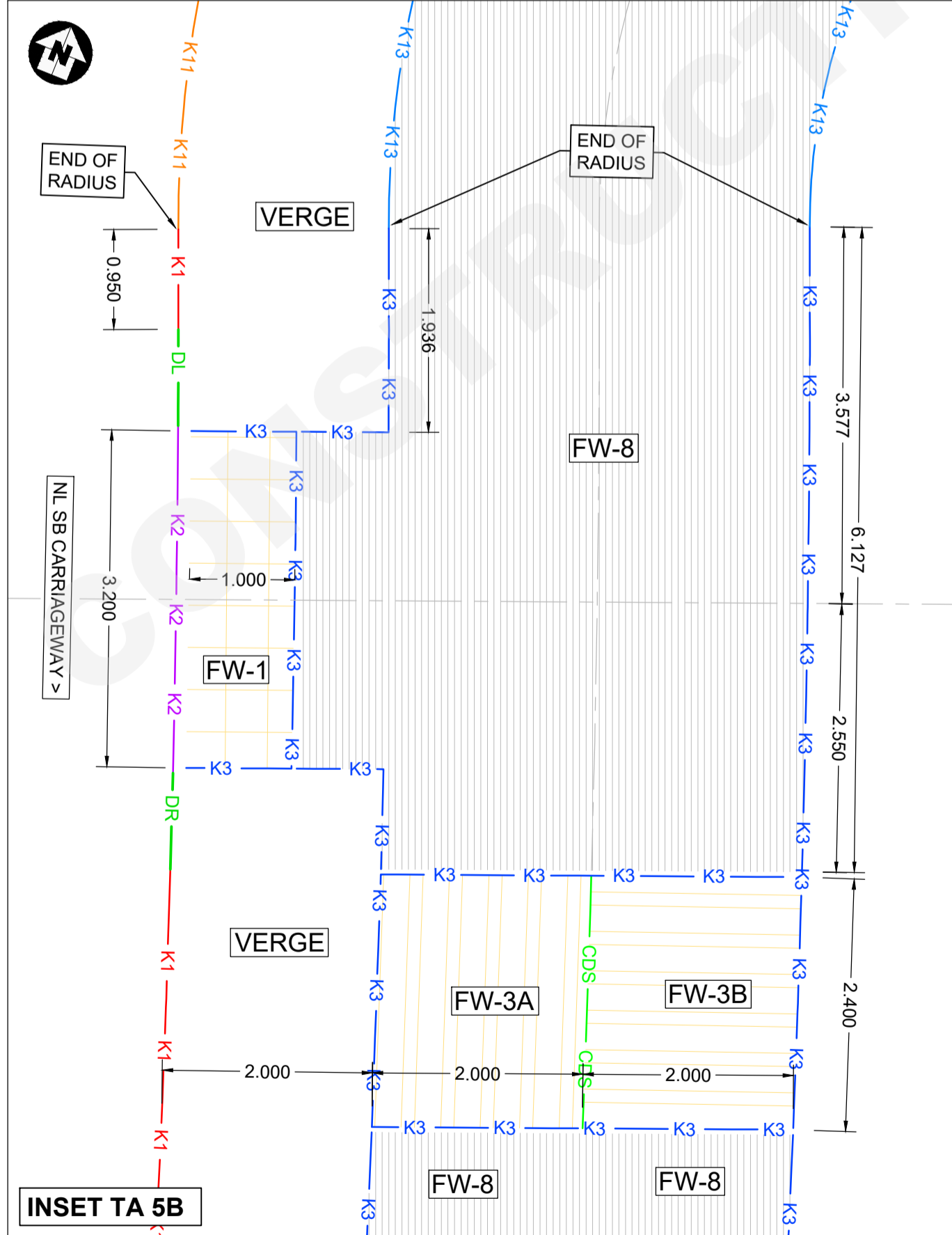
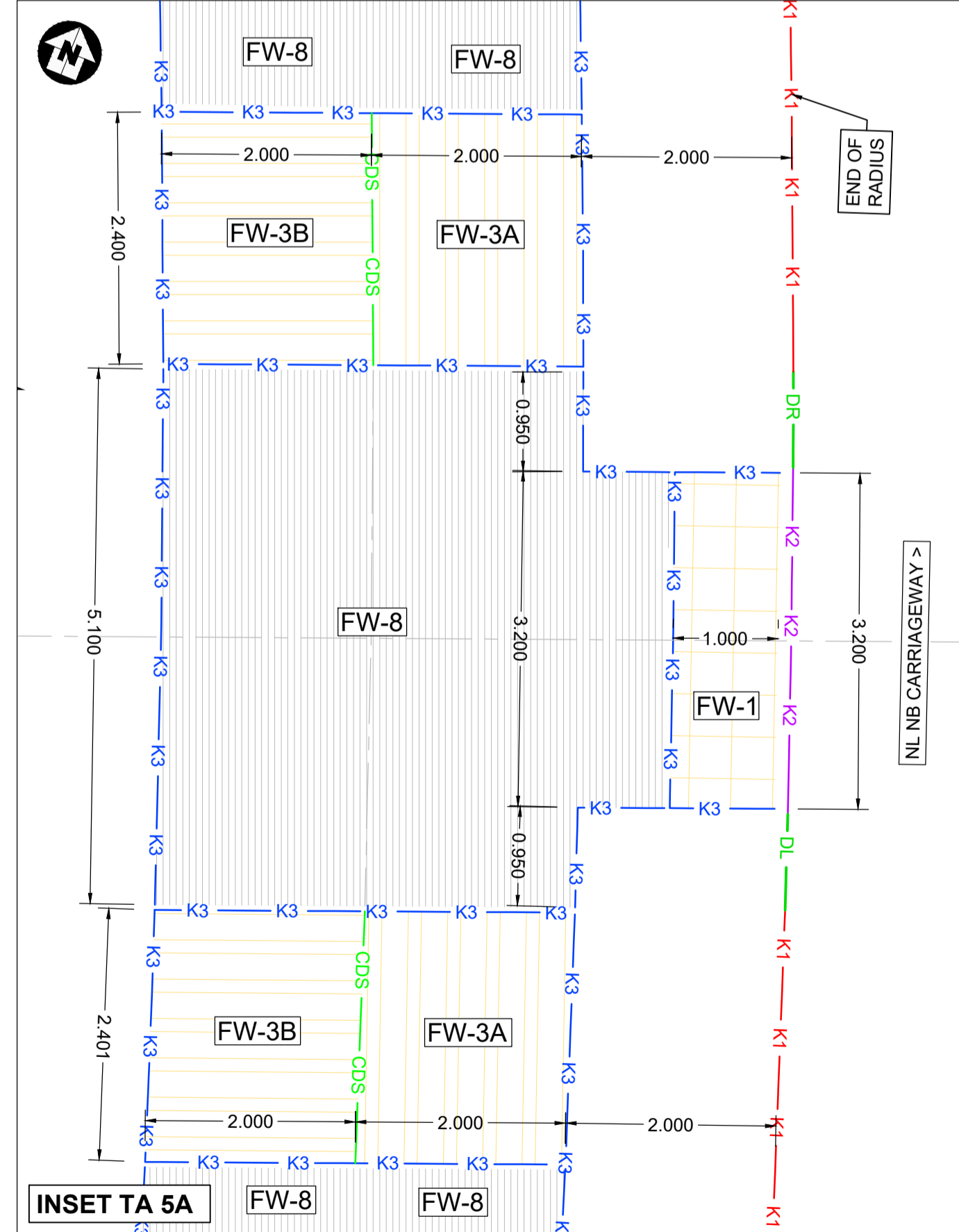

| Description                                   | Status | Revision | Drawn | Checked | Reviewed | Authorised | Issue Date |
|---|--------|----------|-------|---------|----------|------------|------------|
| INITIAL VERSION (DRAFT)                       | S3     | P01      | MT    | DS      | MT       | ---        | 14/10/20   |
| ISSUED FOR REVIEW & COMMENT                   | S3     | P02      | MT    | DS      | DMA      | ---        | 05/02/21   |
| UPDATED FOR PRE-CONSTRUCTION CHANGES          | A3     | C01      | MT    | DS      | DMA      | DS         | 21/05/21   |
| UPDATED LAYOUT AT NORTH LINK ACCESS (5C & 5D) | A3     | C02      | MT    | DS      | MT       | DS         | 28/10/21   |

APPROVED - CONSTRUCTION A3

**ATKINS**  
 Dunedon House  
 Columbia Drive  
 Stockton-on-Tees  
 Cleveland  
 TS17 6BJ  
 Tel: +44 (0)1642 525200

Copyright © Atkins Limited (2021) www.atkinsglobal.com  
**TEESWORKS**  
 The UK's largest industrial zone

Client: SOUTH TEES DEVELOPMENT CORPORATION  
 Drawing Title: DETAILED DESIGN of ESTON ROAD HIGHWAYS SCHEME KERBS, FOOTWAYS & PAVED AREAS TACTILE LOCATION INSETS (NL RBT & NL ACC 1)

Drawing Number: STDC\_HWY - ATK - HKF - PR - DE - CH - 000003  
 Project: PR - DE - CH - 000003  
 Location: Type: Role: Number  
 Original Scale: A1 Scale: 1:50 Project Ref. No.: 5198022 Sheet: 3 of 4 Rev: C02

