

Section A
1: 500

General Notes

Do not scale from this drawing. Only work to written dimensions.
All site dimensions shall be verified by the Contractor on site prior to commencing any works.
This drawing is the property of Fletcher-Rae (UK) Limited (t/a Fletcher-Rae) and copyright is reserved by them. The drawing is not to be copied or disclosed by or to any unauthorised persons without the prior written consent of Fletcher-Rae (UK) Limited.

Map bases were provided to Viridor Tees Valley Limited by the Tees Valley Energy Recovery Facility Contract Authority (comprising Darlington, Hartlepool, Middlesbrough, Redcar & Cleveland, and Stockton Unitary Authorities and Durham County Council and Newcastle City Council) in 2020.

Ground FFL: 10m AOD

P11	Duct from FGT to Stack added, and Diesel and Ammonia bund tanks added	10.03.2023	JDC	RT
P10	General Amendments	21.02.2023	JDC	RT
P9	Amendments to suit client comments	07.02.2023	JDC	RT
P8	Planning / Bid Issue	31.01.2023	JDC	RT
P7	General Updates	10.01.2023	JDC	RT
P6	General note added for copyright purposes	04.04.2022	JDC	RT
P5	Drawing updated to client comments	28.03.2022	JDC	RT
P4	Planning pack update	10.02.2022	JDC	RT
P3	Planning pack issue	09.02.2022	JDC	RT
P2	Additional WC added to Gatehouse	27.01.2022	JDC	RT
P1	Planning pack updated to reflect Acciona comments	09.12.2021	JDC	RT
P0	Planning pack first issue	16.10.2021	JDC	RT
Rev.	Description	Date	ISS	APP

Scale: As indicated @ A1
Status: S2 Information
Drawn By: JDC
Checked By: RT
Date: 04.04.2022

Client: VIRIDOR
Project: TEES VALLEY ERF

Sheet Name: Section A

Project No. Orig. Zone Level Type Role Cls Dwg No. Rev
20044-FRA-00-00-DR-A -20-0012 P11

fletcher|rae
Architects | Master Planners | Designers
Hill Quays, 5 Jordan Street, Manchester, M15 4PY

t +44 (0) 161 242 1140
f +44 (0) 161 242 1141
w www.fletcher-rae.com
e info@fletcher-rae.com

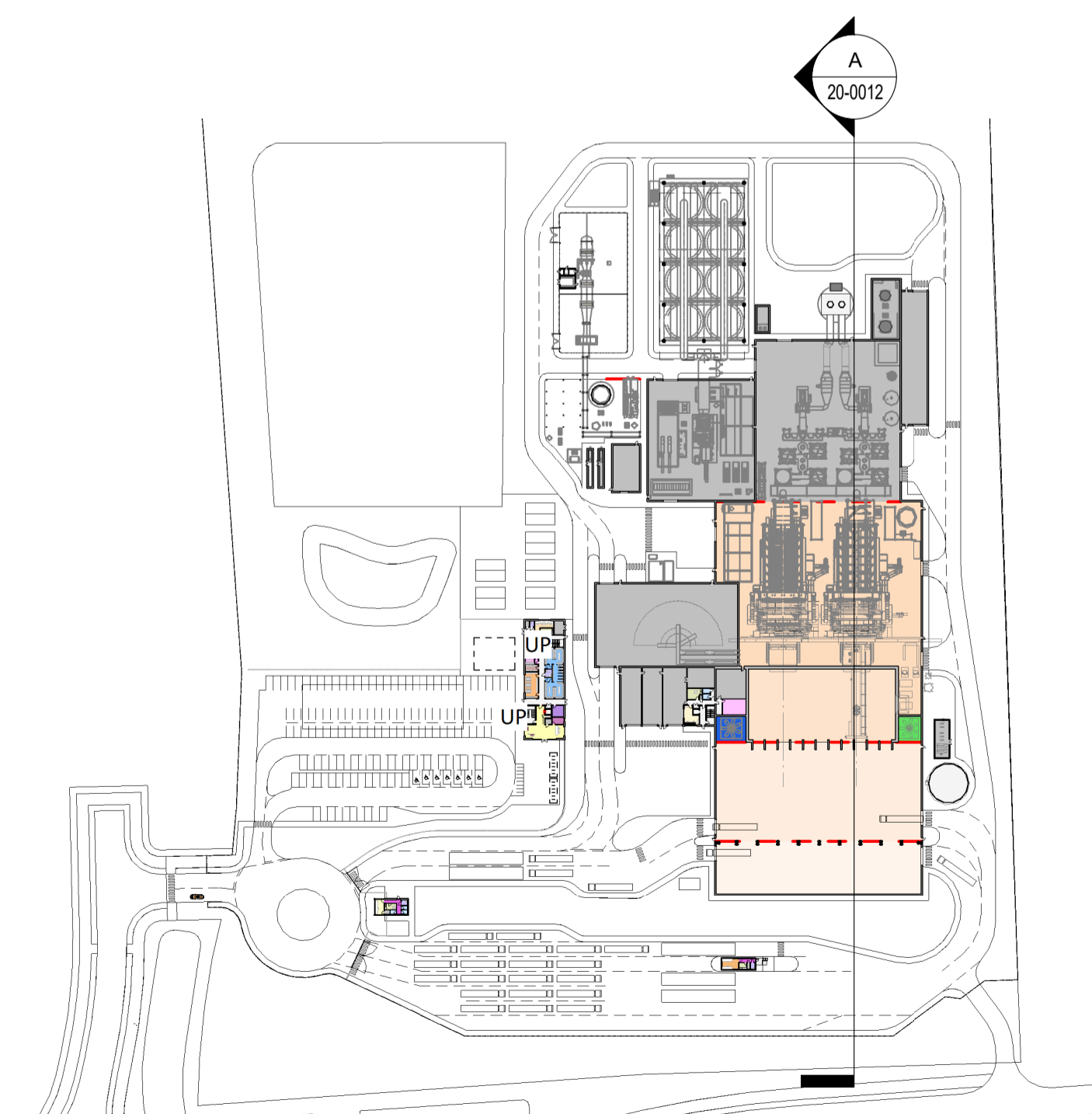

Section Key
1: 2000

